

# AVAILABLE FOR LEASE

7300 N. Reems Rd., Glendale, AZ



## Features

- Ideal equipment rental service facility
- Large asphalt, concrete, & gravel yard for outside storage
- Block construction with drive through bays & wash rack oil water separator
- Additional 4 acres adjacent available for expansion or BTS
- Owner/Agent

Total Building Size:	12,00 SF
Office Size:	3,000 SF
Land Size:	186,851 (4.2) Acres
APN #:	501-49-008U
YOC:	2027 - Coming Soon
Zoning:	PAD, city of Glendale (variable outdoor storage uses approved, comparable to M-1 zoning)
Grade Doors:	(12) variable sizes of 12', 14' & 16' wide
Clear Height:	18' Min
Power:	1,600 AMPS



**Woudenberg**  
**Properties**

INDUSTRIAL OUTDOOR STORAGE

FOR MORE INFORMATION:

**JEFF**  
**WOUDENBERG**

(480) 620-8555

JEFF@WOUDENBERGPROPS.COM

*The Information contained herein has either been given to us by the owner of the property or obtained from sources that we deem reliable. No warranties or representations, expressed or implied, are made as the accuracy of the information contained herein.*

[www.woudenbergprops.com](http://www.woudenbergprops.com)

# 7300 N. Reems Rd., Glendale, AZ

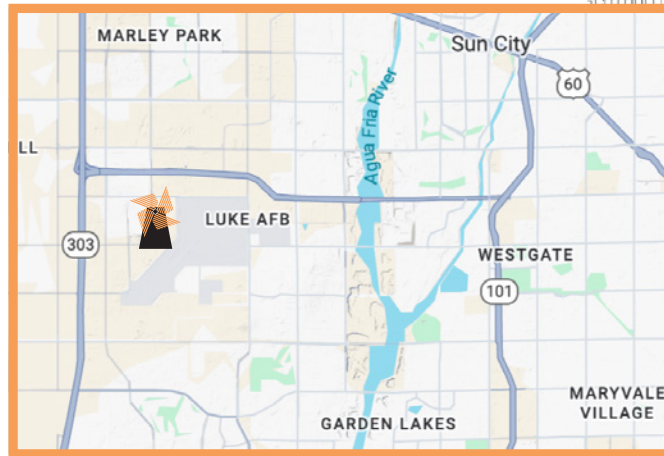
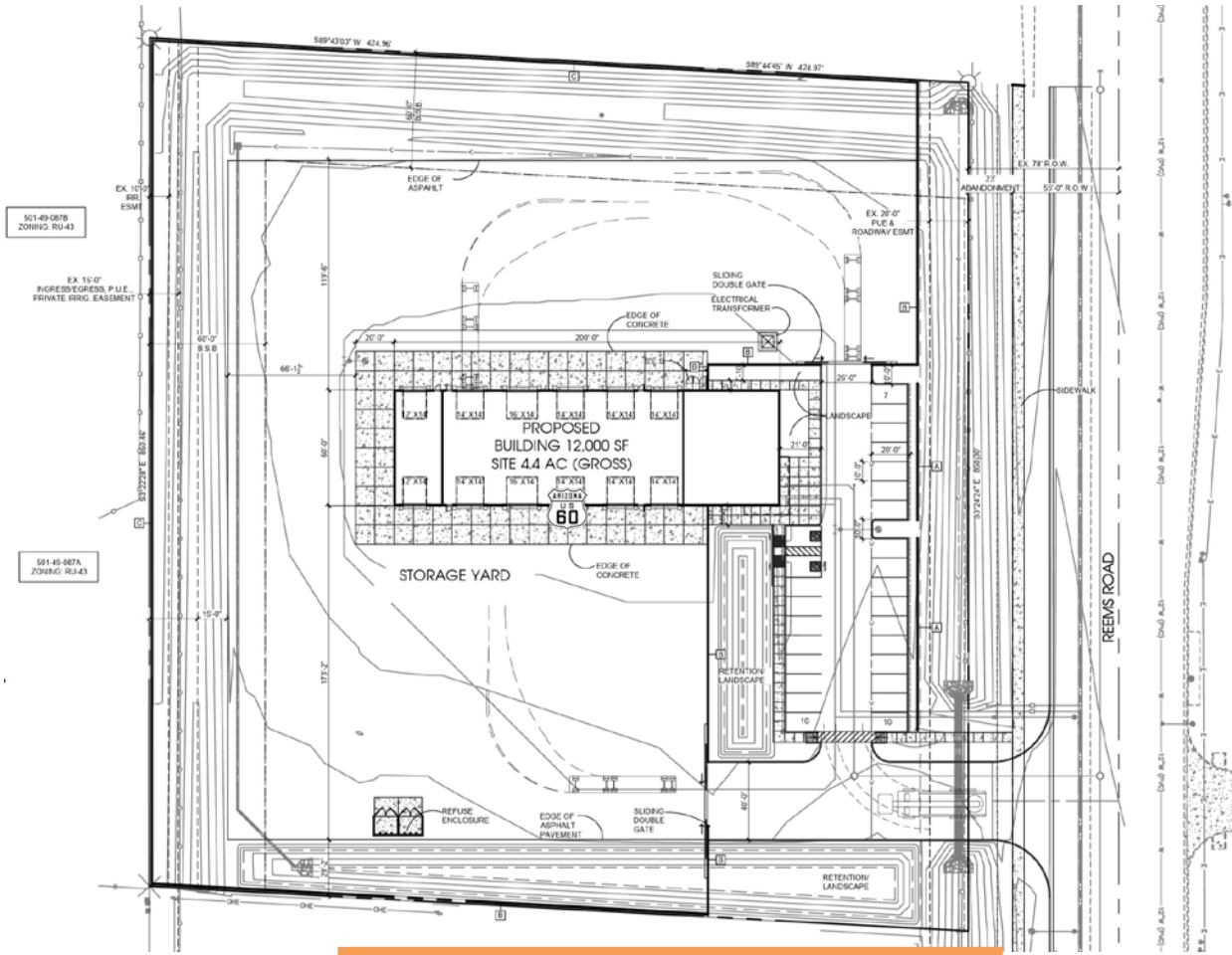

Easy Freeway Access



**Woudenberg  
Properties**

**INDUSTRIAL OUTDOOR STORAGE**

FOR MORE INFORMATION:

**JEFF  
WOUDENBERG**

**(480) 620-8555**

**JEFF@WOUDENBERGPROPS.COM**

The Information contained herein has either been given to us by the owner of the property or obtained from sources that we deem reliable. No warranties or representations, expressed or implied, are made as the accuracy of the information contained herein.

[www.woudenbergprops.com](http://www.woudenbergprops.com)