



ENTIRE 12TH FLOOR - 46,360SF

**499 Washington Blvd**  
Jersey City, NJ

**CLASS A SUBLET OPPORTUNITY**

Long-term, Built, Furnished & Wired Full Floor Opportunity for Sublease

[bins.properties/JerseyCity](https://bins.properties/JerseyCity)



## FLOOR SPECS

# Entire 12th Floor 46,360 SF

Available Immediately

### FEATURES:

- 196 Workstations
- 9 Private Offices
- 10 Conference Rooms (varying from 4 to 16 people per room)
- 1 Training Room (can accommodate 30+ as-is and 45+ with foldable partition between adjacent conference room)
- 1 Cafeteria style pantry (50+)
- 1 Executive Kitchen with seating area (immediately off reception area)
- 1 Dedicated Reception area
- 1 Wellness Room
- 1 Lactation Room
- 2 Phone Rooms
- 4 Huddle rooms
- Ample breakout space & storage opportunities

- High-end installation
- Furnished, wired, turnkey opportunity
- Panoramic river and Waterfront views
- New tenant fitness center in the building with showers and locker room
- Immediate access to parking, Light Rail, Path and Newport Centre Mall

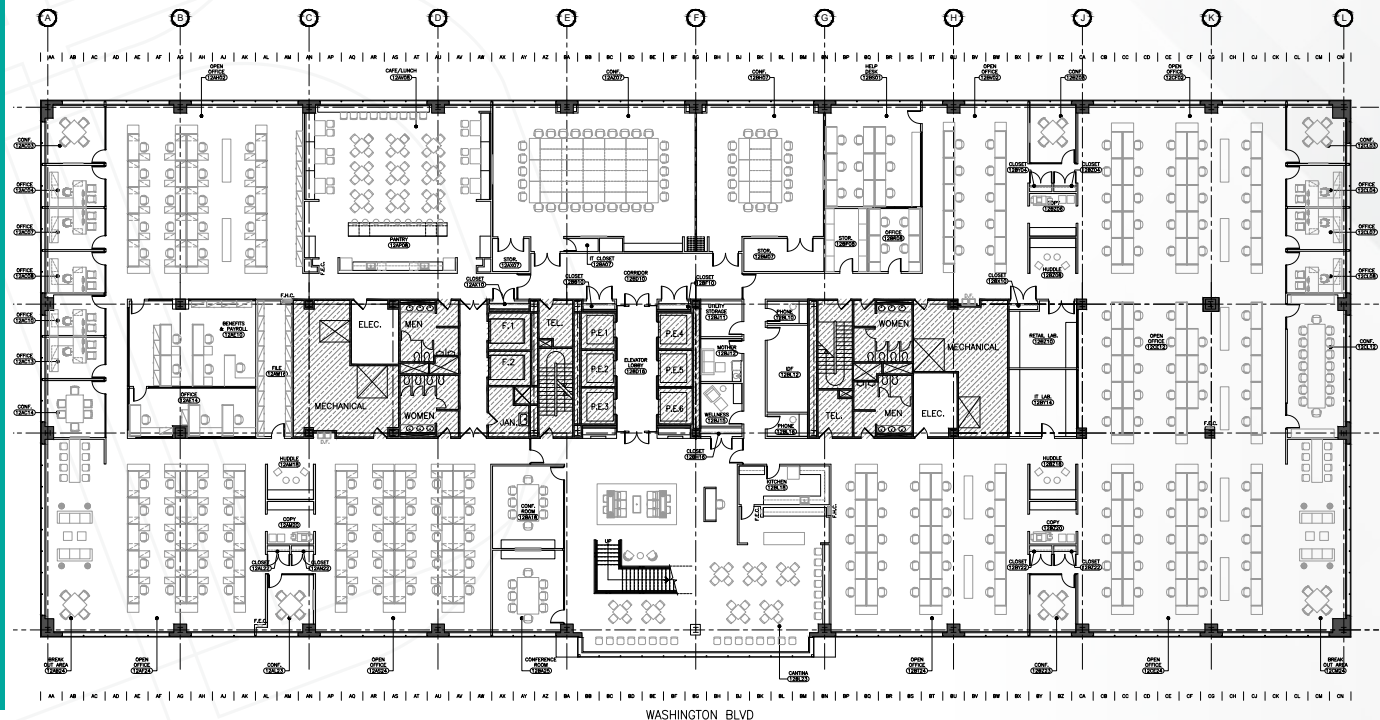

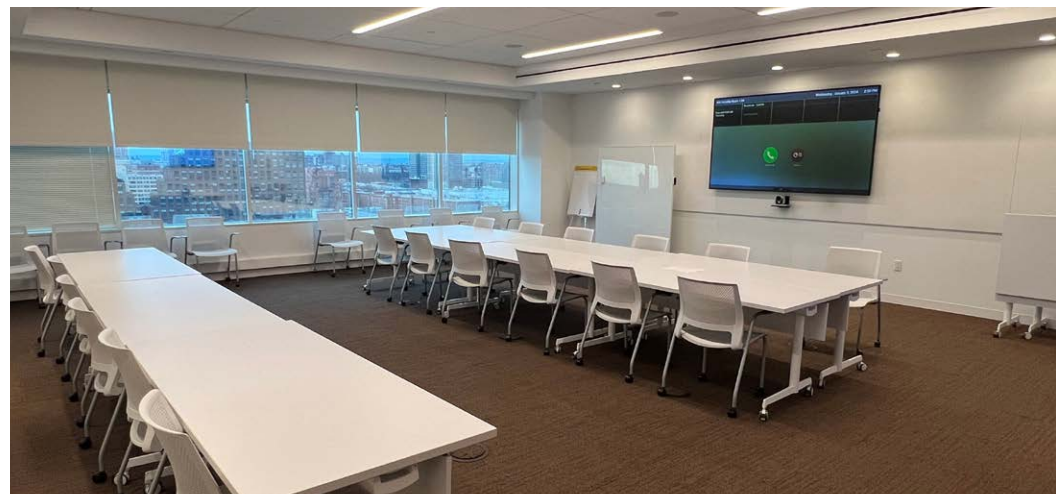





## LOCAL AREA MAP

## CONTACT

### John Harris

Senior Vice President  
978.500.7577  
jharris@binswanger.com

### Nick Biedron

Senior Vice President  
908.507.0155  
nbiedron@binswanger.com

### David Binswanger

President & CEO  
215.448.6000  
dbinswanger@binswanger.com



Three Logan Square  
1717 Arch Street, Suite 5100  
Philadelphia, PA 19103  
binswanger.com