

**FOR
LEASE**

MENTOR BUSINESS PARK

7800 TYLER BLVD, MENTOR, OH 44060

CRANED MANUFACTURING SPACE | 45,151 SF



Jenna Gauntner
Senior Associate
jenna.gauntner@cbre.com
+1 216 363 6450

CBRE, Inc.
950 Main Avenue
Suite 800
Cleveland, Ohio 44113

CBRE

PROPERTY HIGHLIGHTS



- ±2 Miles from SR-2 with Highway Visibility, ±3 Miles from I-90
- Park neighbors include MWD Logistics, ORBIS, Interpak, Summit Steel, Accurate Metal, Infasco Distribution and USALCO
- Owned by Industrial Realty Group (IRG), one of the largest CRE owners/developers in the US and professionally managed by IRG Realty Advisors (IRGRA).
- **Low Operating Expenses: \$1.31 (2025 Est)**

ZONING INFORMATION

- [Zoning Map](#)
- [Codified Ordinances](#)

AVAILABLE UNITS

UNIT B6	Craned Manufacturing	45,151 SF±
UNIT A1	Open Layout Office	74,352 SF±
UNIT B1	Office / R&D / Lab	12,159 SF±

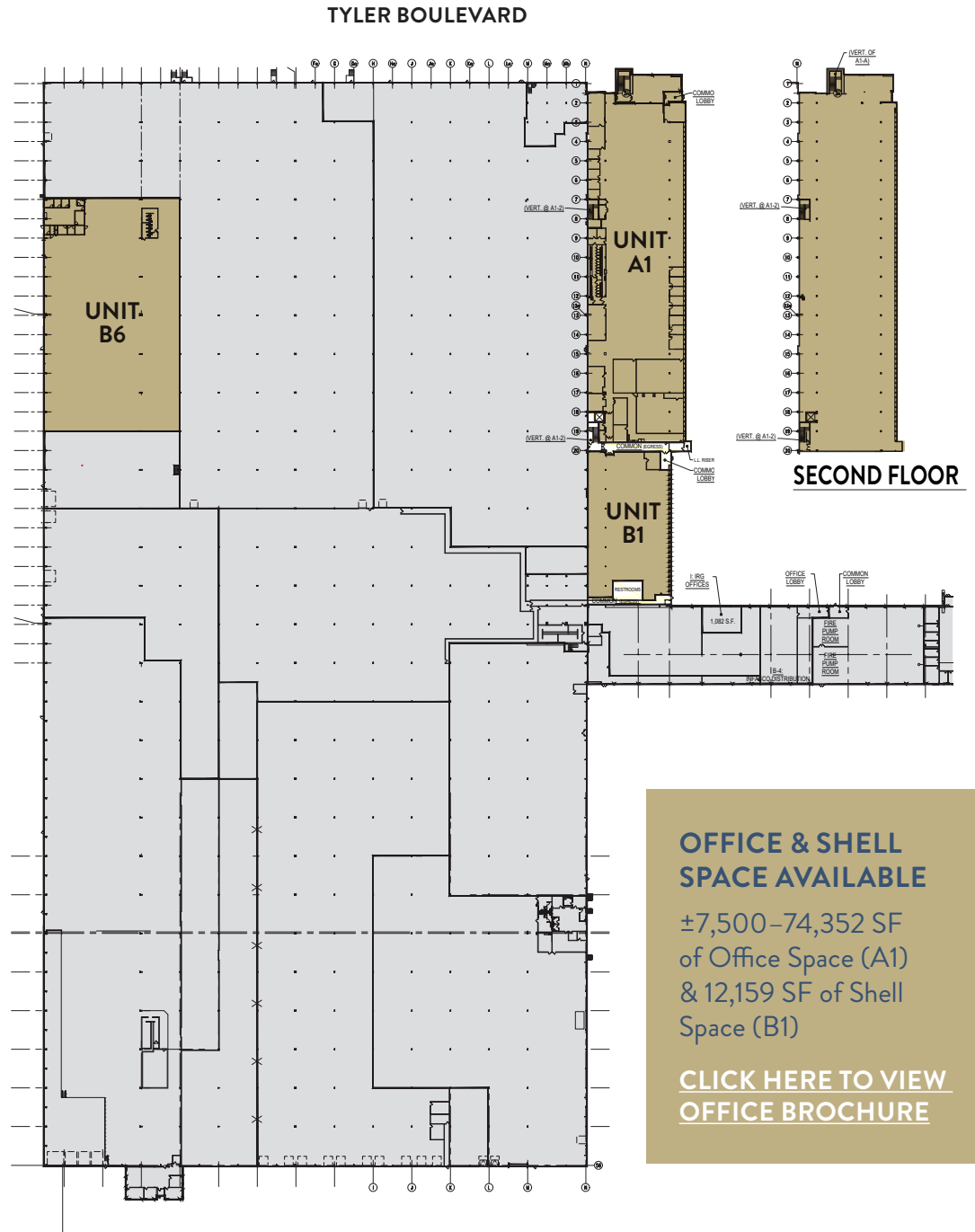

OFFICE & SHELL SPACE AVAILABLE

±7,500-74,352 SF of Office Space (A1) & 12,159 SF of Shell Space (B1)

[CLICK HERE TO VIEW OFFICE BROCHURE](#)

SPACE DETAILS UNIT B6

DESCRIPTION	Craned Manufacturing
RENTABLE SF	45,151 SF ±
OFFICE SF	1,680 SF ±
WAREHOUSE SF	32,220 SF ±
DOCKS	Potential to Add Two
DRIVE-INS	Two (1 - 16' X 16', 1 - 8' X 10')
CLEAR HEIGHT	20'2" – 32'
COLUMNS	100' X 40' & 40' X 40'
POWER	480V / 3PH
CRANE	6-Ton (23' Under Hook)
SPRINKLERS	Wet
ADDITIONAL FEATURES	<ul style="list-style-type: none"> • LED Lighting • Reznor Heating Units • Shop Restrooms & Lockers • 6 Private Offices, Conference Room, Kitchenette, IT/Data, & Shop Office • Glass Vestibule Entrance

ASKING RATE \$5.25 / SF NNN

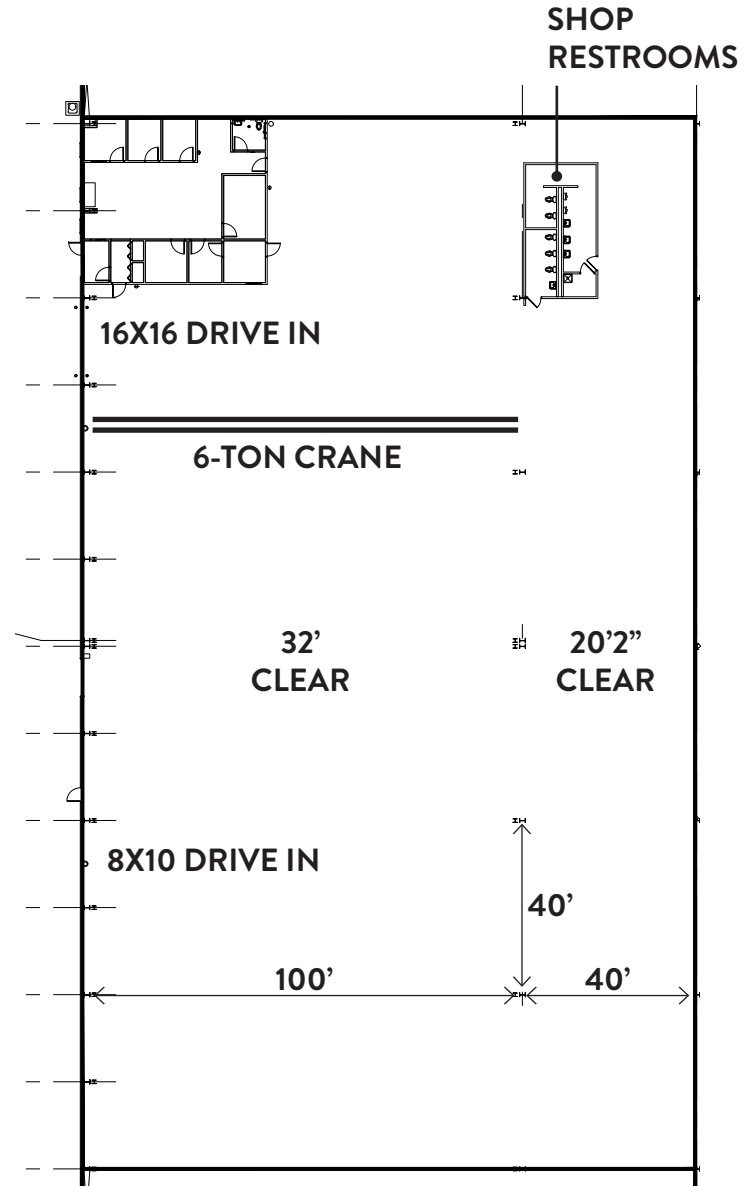

UNIT B6 PHOTOS

UNIT B6

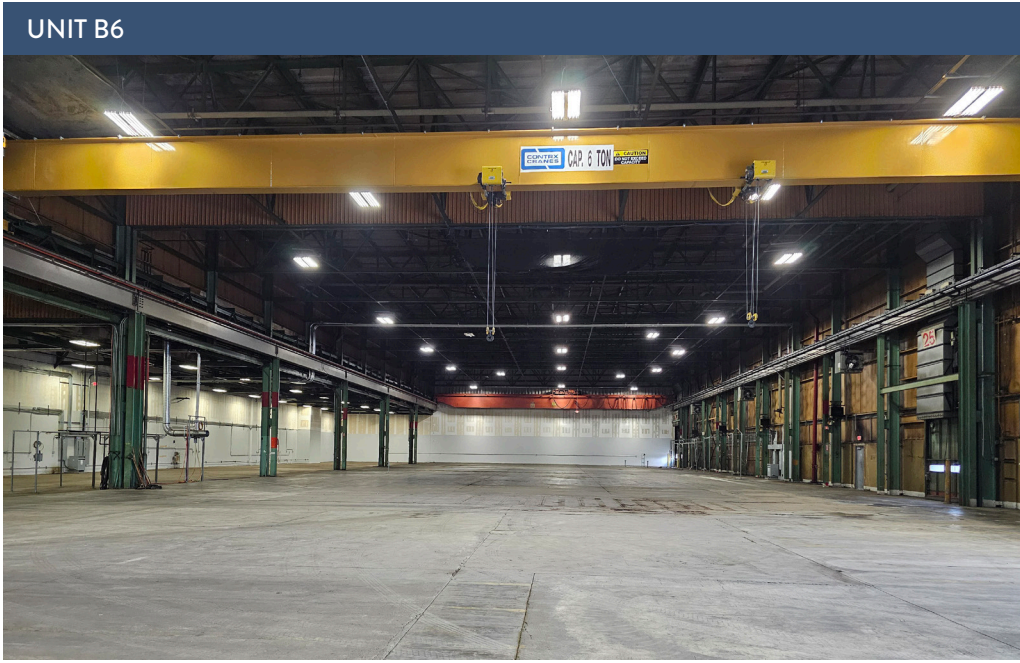

UNIT B6



UNIT B6



UNIT B6



LOCATION OVERVIEW



DEMOGRAPHICS (5 MILE RADIUS)



AVG HH INCOME
\$107,962



POPULATION
103,263



AVG HOUSING VALUE
\$284,346



HOUSEHOLDS
46,679



EMPLOYEES
61,338

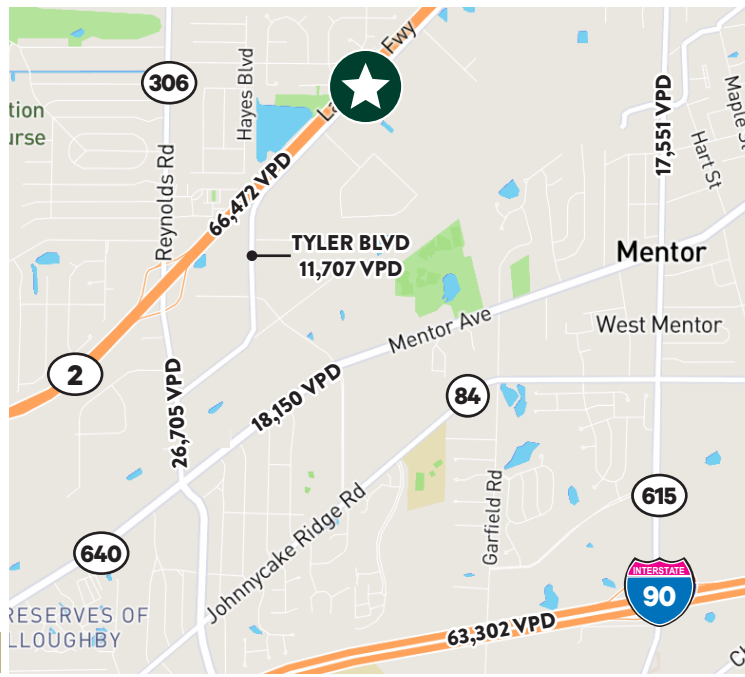

TRADE AERIAL MENTOR



TRADE AREA INFO
Mentor Ave & Center St
(3 Miles)

- Population: 44,302
- Daytime Population: 49,911
- Total Households: 18,464
- Median HH Income: \$78,024
- Average HH Income: \$107,388
- Total Businesses: 2,214
- Total Employees: 34,421

MAJOR EMPLOYERS

1. STERIS - 1,043
2. TriPoint Medical Center - 825
3. Lincoln Electric - 540
4. NHVS International Inc. - 325
5. Avery Dennison - 300

HOTELS
14 Hotels/1,350 Rooms

1. Super 8 - 63
2. Studio 6 - 114
3. Holiday Inn - 132
4. Best Western - 50
5. Residence Inn - 96
6. WoodSpring Suites - 117
7. Hampton Inn - 90
8. Wingate - 83
9. Quail Hollow - 176
10. Comfort Inn - 55
11. Holiday Inn Express - 84

Not on map:
Mentor Home Inn - 70
Days Inn - 112
Red Roof Inn - 108
Planned:
Homewood Suites - N/A

Traffic Counts: Ohio Department of Transportation (ODOT) 2019-2020

**FOR MORE
INFORMATION
CONTACT:**

Jenna Gauntner
Senior Associate
jenna.gauntner@cbre.com
+1 216 363 6450

CBRE, Inc.
950 Main Avenue
Suite 800
Cleveland, Ohio 44113

© 2025 CBRE, Inc. The information contained in this document has been obtained from sources believed reliable. While CBRE, Inc. does not doubt its accuracy, CBRE, Inc. has not verified it and makes no guarantee, warranty or representation about it. It is your responsibility to independently confirm its accuracy and completeness. Any projections, opinions, assumptions or estimates used are for example only and do not represent the current or future performance of the property. The value of this transaction to you depends on tax and other factors which should be evaluated by your tax, financial and legal advisors. You and your advisors should conduct a careful, independent investigation of the property to determine to your satisfaction the suitability of the property for your needs. CBRE and the CBRE logo are service marks of CBRE, Inc. and/or its affiliated or related companies in the United States and other countries. All other marks displayed on this document are the property of their respective owners. Photos herein are the property of their respective owners and use of these images without the express written consent of the owner is prohibited. Licensed Real Estate Broker.

