



MARENGO WAREHOUSE & DISTRIBUTION CENTER

Marengo Warehouse & Distribution Center General Information

Marengo Warehouse is a former Limestone Quarry that has been re-structured into a modern warehousing facility. The project started in 1995 and is an ongoing project to date.

The total surface area of Marengo Warehouse property is approximately 270 acres, and 58 acres or 2,575,300 Sq ft of underground space that has been mined to date.

Currently Marengo Warehouse has developed 1,382,300 Sq ft in 13 underground warehouses ranging between 50,000 to 100,000 Sq ft per warehouse, 26 to 30 feet ceiling height throughout the facility, a natural limestone ambient temperature between 55 to 60 degrees and available undeveloped space of 1,193,400 Sq ft, for a future development.

Marengo Warehouse facilities is structured with one central office, two underground offices with telephone lines, fiber optics internet and fax line, two restrooms, maintenance area, 24Hr security personnel, a parking lot capable to hold between 80 to 100 semi-trailers, underground paved roadways with 60 feet wide, 30 feet ceiling height and 72 docks doors.

Marengo Warehouse is equipped with fleet of 5000 LB electric and propane gas forklifts in addition to large and small construction equipment to perform daily operations and maintenance of inside and outside areas.

Marengo Warehouse has a fully equipped Engine Room with Ammonia Brine System above ground, to maintain 267,000 Sq ft of freezer space in the underground with a temperature range between 4 and 12 degrees.

The underground warehouses that are currently developed are as follows:

- ❖ WH # 1 – Ambient Temperature – 100,000 Sq ft.
- ❖ WH # 2 – Freezer Temperature – 160,000 Sq ft.
- ❖ WH # 3 – Ambient Temperature – 99,800 Sq ft.
- ❖ WH # 4 – Ambient/De-humidifier – 99,200 Sq ft.
- ❖ WH # 5 – Ambient/De-humidifier – 100,300 Sq ft.
- ❖ WH # 6 – Ambient Temperature – 94,000 Sq ft.
- ❖ WH # 7 – Ambient Temperature – 71,000 Sq ft.
- ❖ WH # 8 – Freezer Temperature – 107,000 Sq ft.
- ❖ WH # 9 – Ambient Temperature – 52,000 Sq ft.
- ❖ WH # 10 – Ambient Temperature – 179,000 Sq ft.
- ❖ WH # 11 – Ambient/De-humidifier – 120,000 Sq ft
- ❖ WH # 12 – Ambient Temperature – 100,000 Sq ft.
- ❖ WH # 13 – Ambient/De-humidifier – 100,000 Sq ft.

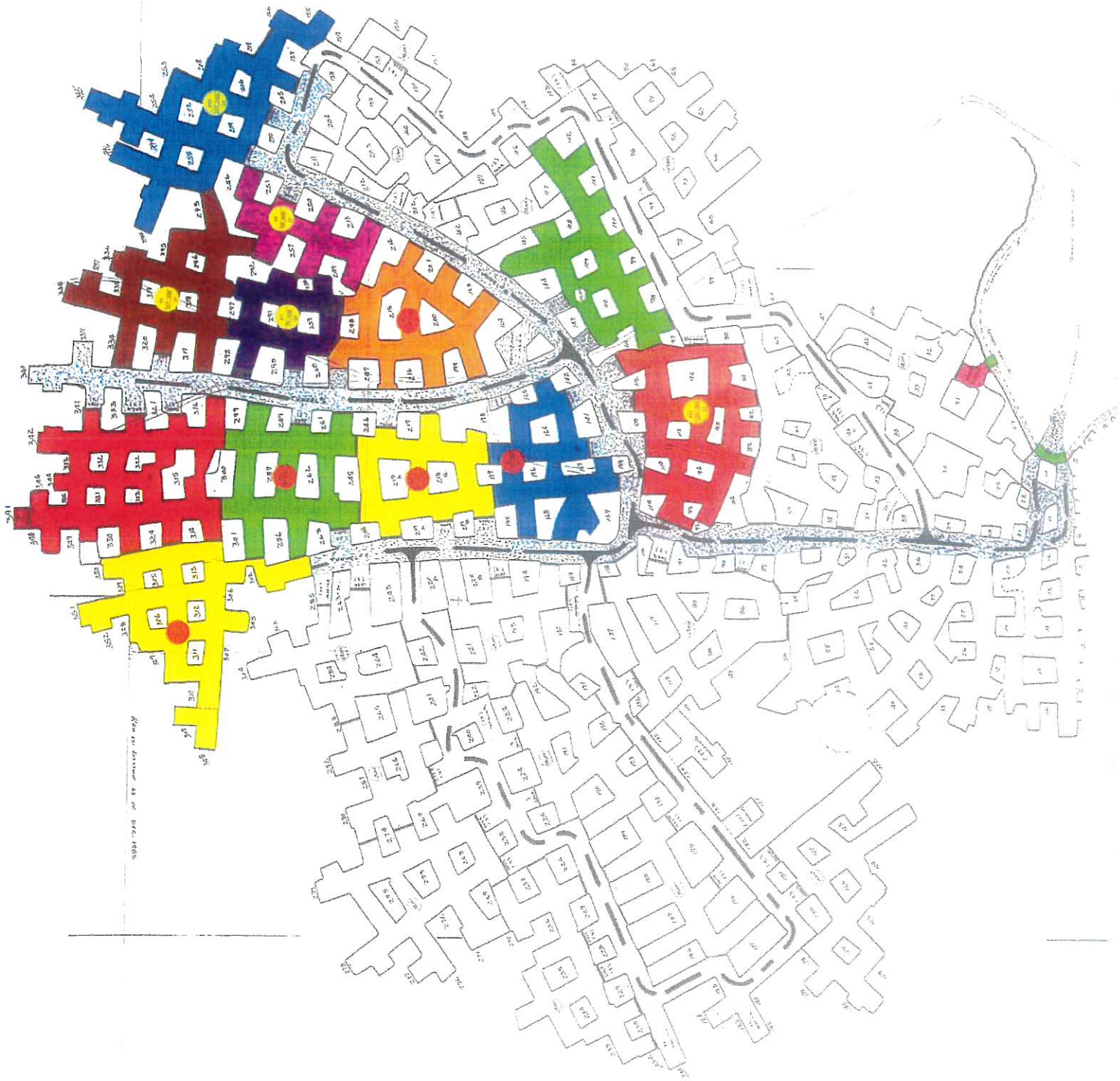

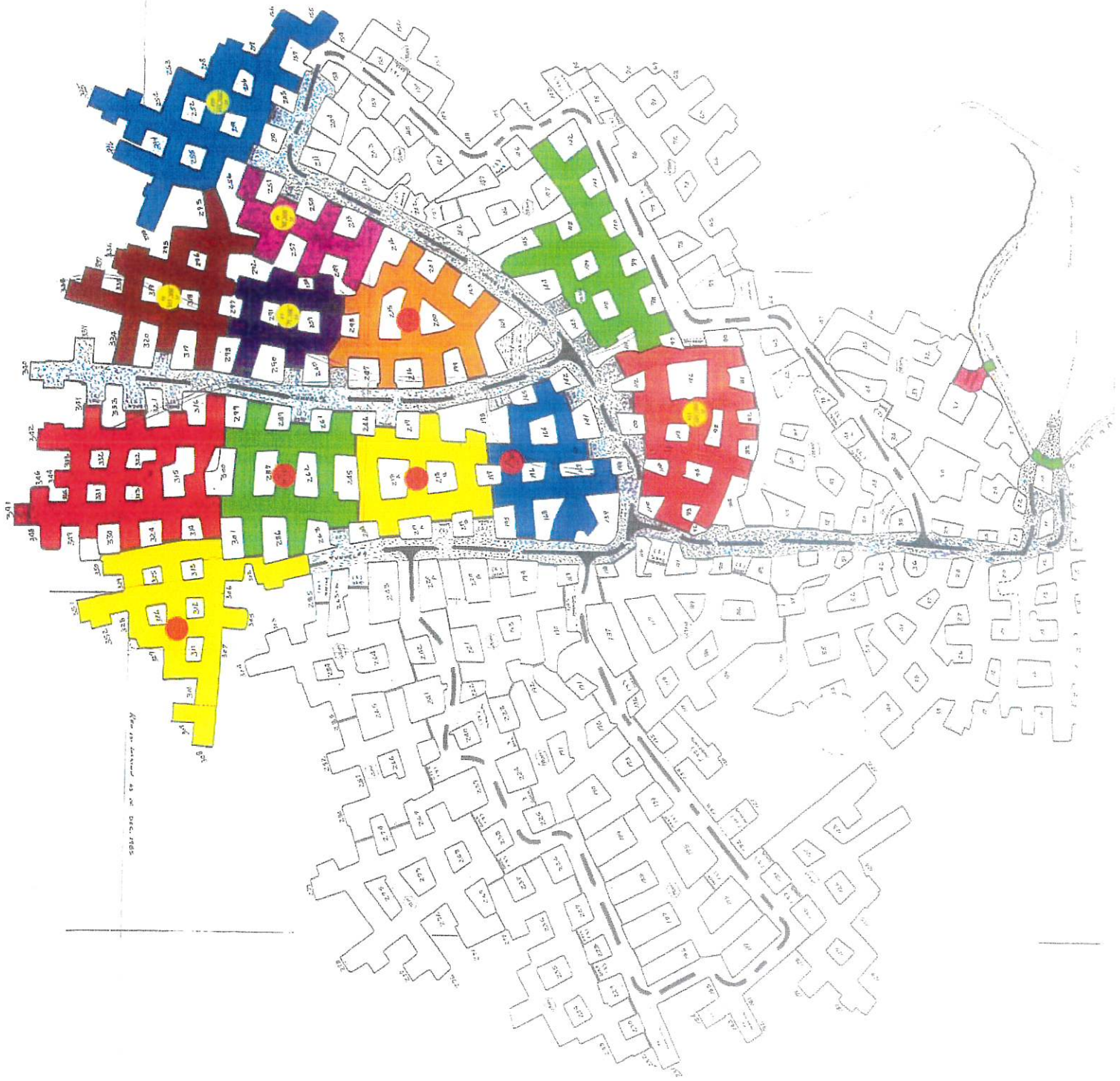

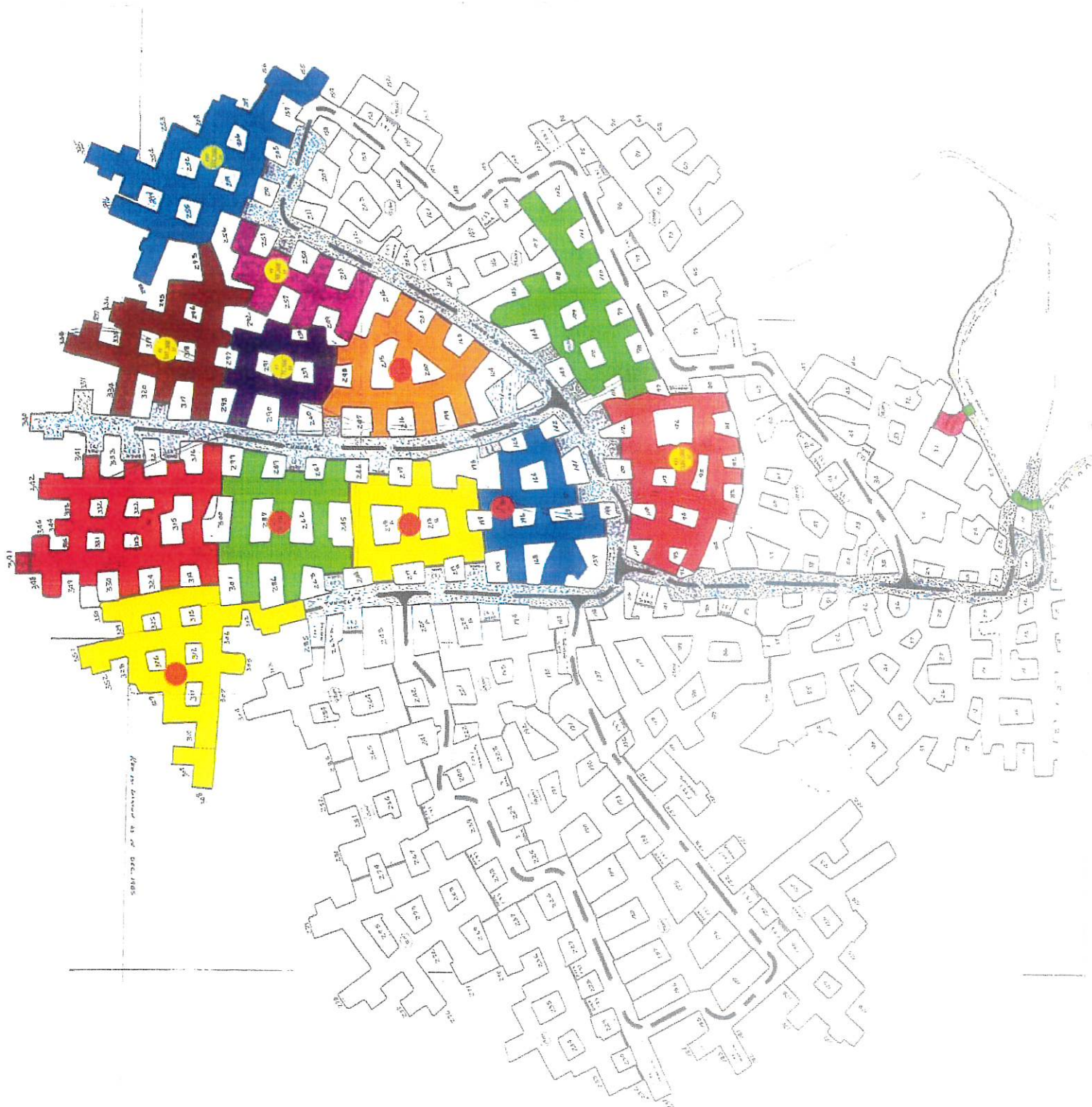

Plan as shown as of Dec. 1985

201

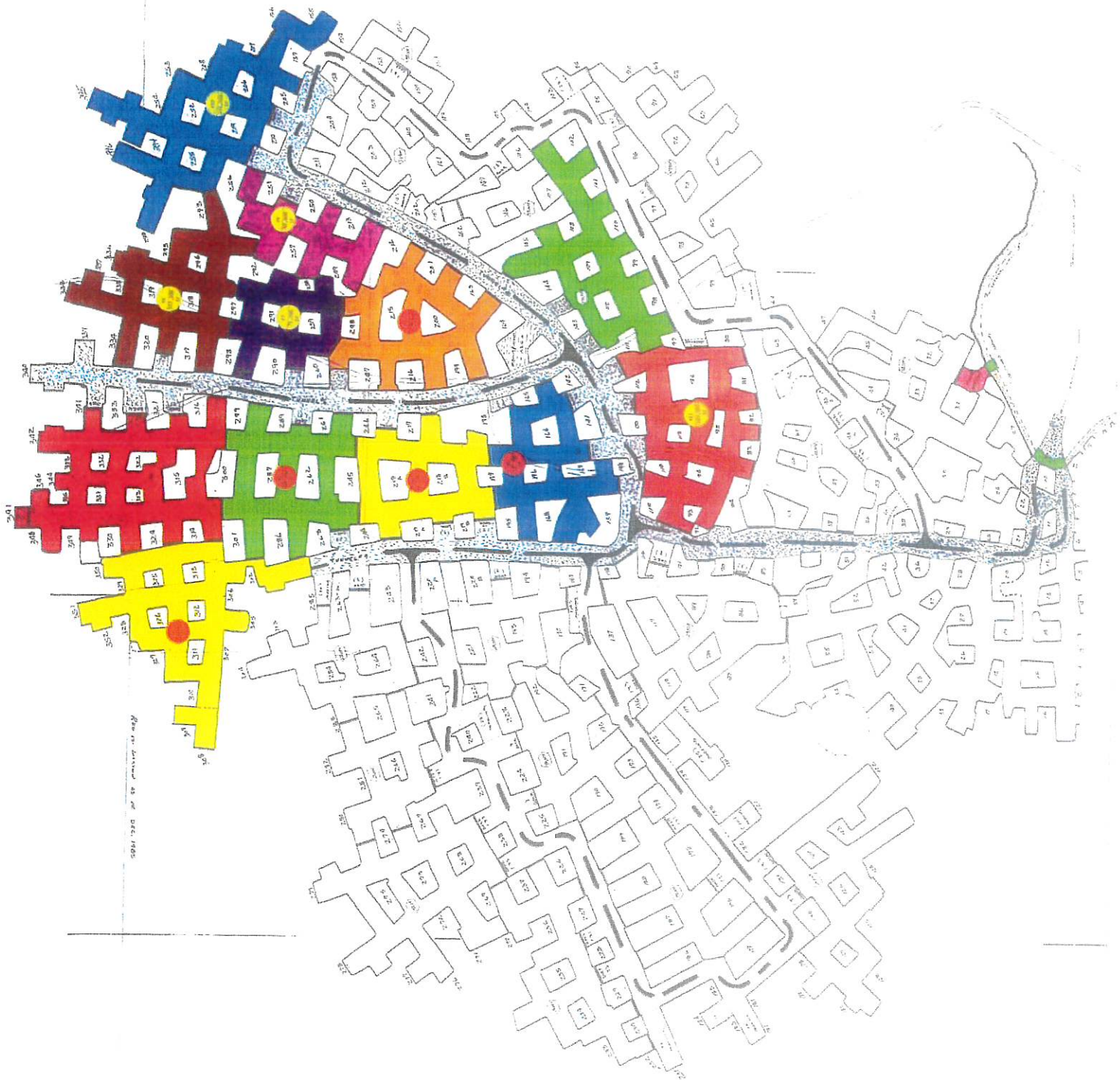

Company Organizational Chart 2022

