

47815 WEST ROAD
UNIT #102
WIXOM, MICHIGAN
INDUSTRIAL FOR LEASE
2,847 Square Feet Available



**SIGNATURE
ASSOCIATES**
KNOW SIGNATURE | KNOW RESULTS

LYNN CORPORATE PARK



PROPERTY FEATURES

- 2,847 square feet available
- 569 square foot office with kitchenette
- 19' clear height
- (1) 12' x 14' grade level door
- (2) shared truckwells
- Zoned M-1; Light Industrial
- Beautifully landscaped and maintained
- Immediate access to I-96 via Beck Road
- Lease Rate: Contact Broker

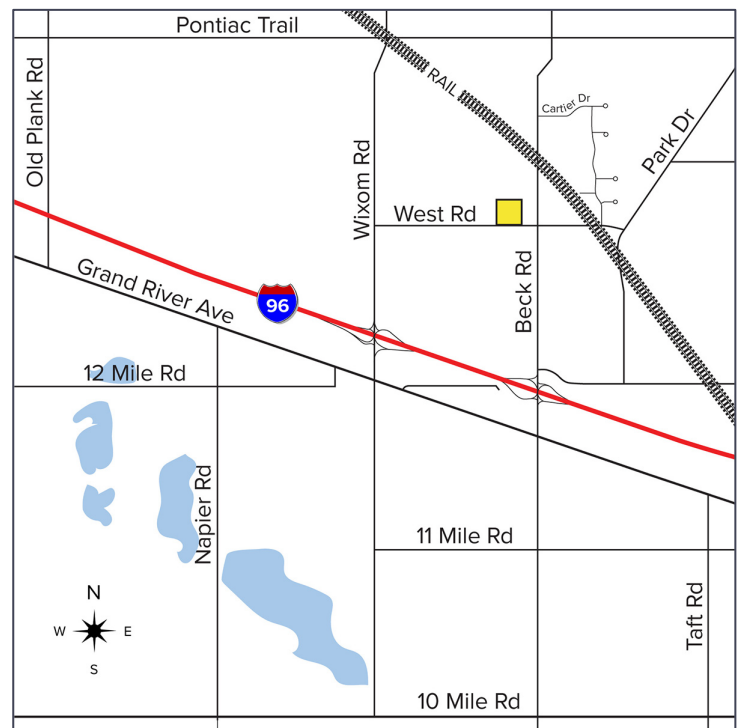

For more information, please contact:

CHRISTOPHER M. D'ANGELO
(248) 948 0109
cdangelo@signatureassociates.com

JIM MONTGOMERY
(248) 359 0614
jmontgomery@signatureassociates.com

SIGNATURE ASSOCIATES
One Towne Square, Suite 1200
Southfield, MI 48076
www.signatureassociates.com

47815 West Road Unit #102 - Wixom, Michigan

Industrial For Lease

2,847
Square Feet
AVAILABLE

Site Plan

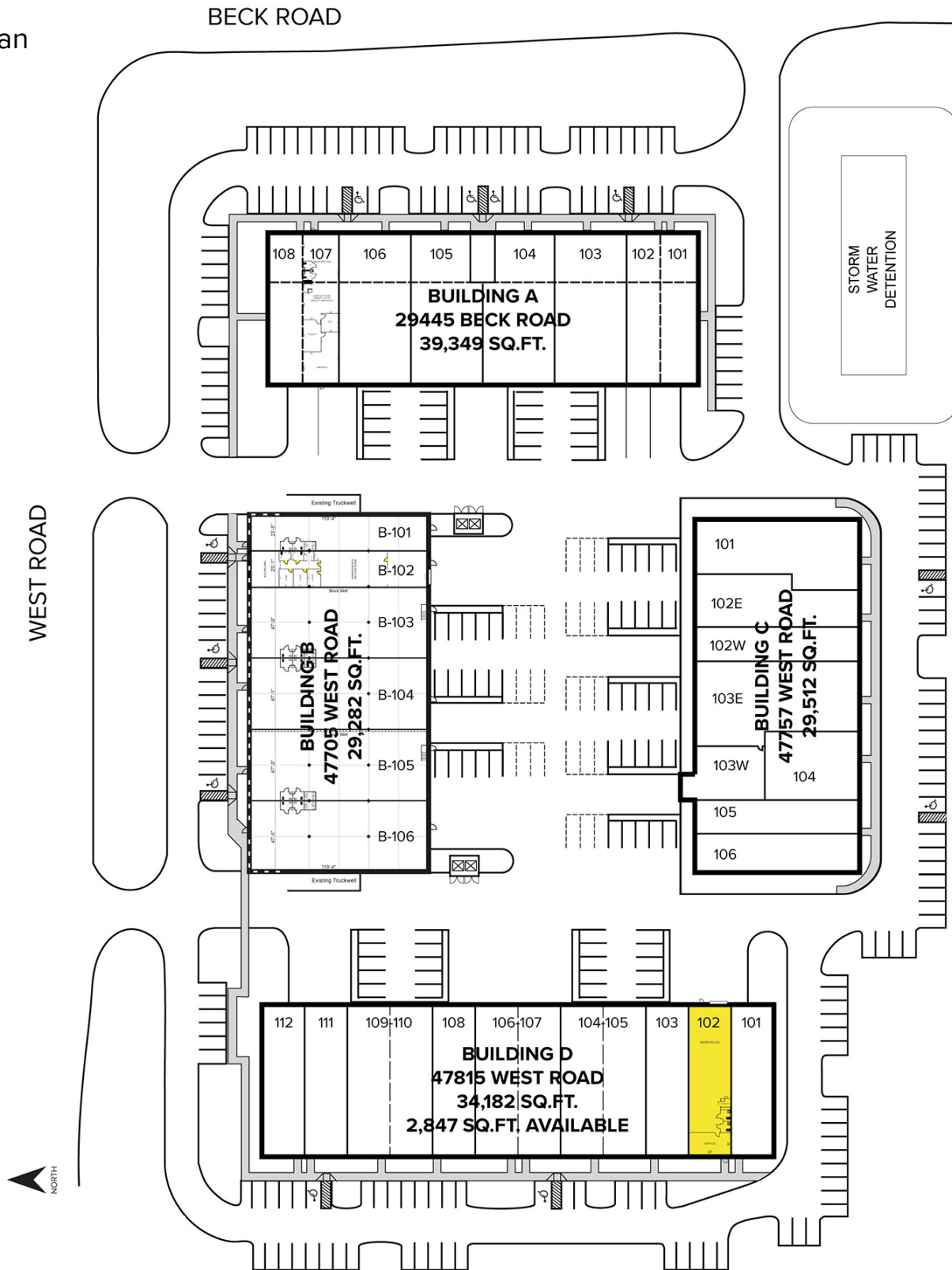

For more information, please contact:

CHRISTOPHER M. D'ANGELO
(248) 948 0109
cdangelo@signatureassociates.com

JIM MONTGOMERY
(248) 359 0614
jmontgomery@signatureassociates.com

SIGNATURE ASSOCIATES
One Towne Square, Suite 1200
Southfield, MI 48076
www.signatureassociates.com

Information is subject to verification and no liability for errors or omissions is assumed. Price is subject to change and listing withdrawal.

47815 West Road Unit #102 - Wixom, Michigan
Industrial For Lease

2,847
Square Feet
AVAILABLE

Unit 102
Floor Plan

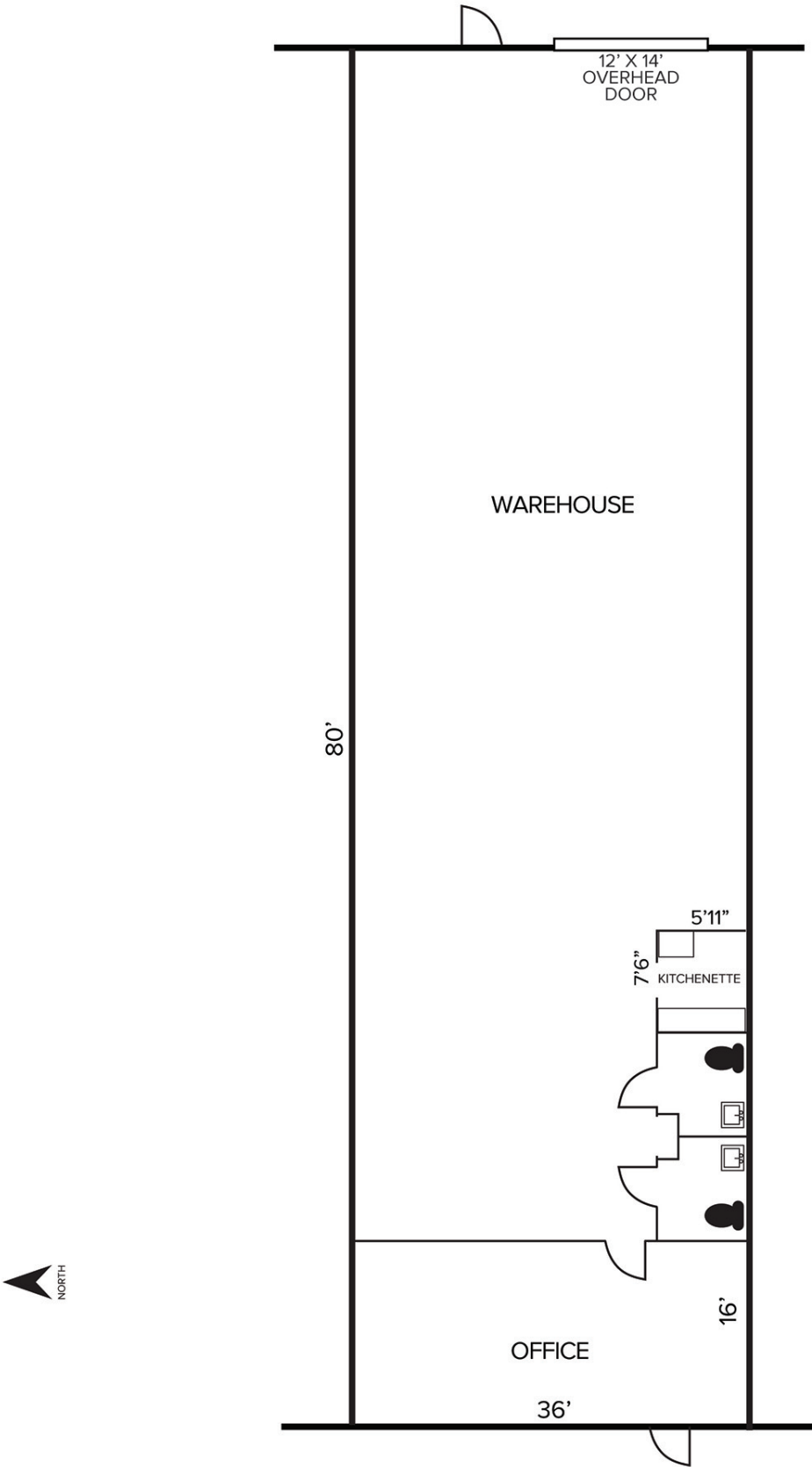

For more information, please contact:
CHRISTOPHER M. D'ANGELO
(248) 948 0109
cdangelo@signatureassociates.com

JIM MONTGOMERY
(248) 359 0614
jmontgomery@signatureassociates.com

SIGNATURE ASSOCIATES
One Towne Square, Suite 1200
Southfield, MI 48076
www.signatureassociates.com

Information is subject to verification and no liability for errors or omissions is assumed. Price is subject to change and listing withdrawal.

47815 West Road Unit #102 - Wixom, Michigan

Industrial For Lease

2,847
Square Feet
AVAILABLE

Aerial



For more information, please contact:

CHRISTOPHER M. D'ANGELO
(248) 948 0109
cdangelo@signatureassociates.com

JIM MONTGOMERY
(248) 359 0614
jmontgomery@signatureassociates.com

SIGNATURE ASSOCIATES
One Towne Square, Suite 1200
Southfield, MI 48076
www.signatureassociates.com

Information is subject to verification and no liability for errors or omissions is assumed. Price is subject to change and listing withdrawal.