

OFFICE SUBLEASE
186 LINCOLN ST., 8TH & 9TH FLOOR
BOSTON, MA 02111

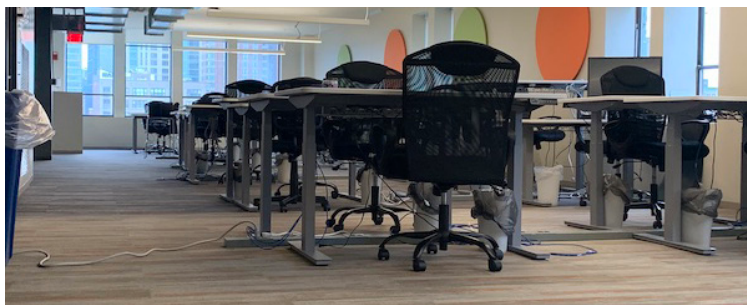

LISTING DATA

AVAILABLE SF:	13,302 RSF
PROPERTY TYPE :	Class B Office
OCCUPANCY:	Immediately
LEASE TERM:	Through Aug. 31, 2026
CABLE/WIRING:	Space is wired
CONFIGURATION:	Each floor consists of 40 workstations, 5 conference rooms, print/copy area, IT closet, reception area and kitchen/lounge area.

LOCATION: Conveniently located near South Station, Downtown Crossing, the Financial District and major highways (I-93 and I-90/Mass Pike)

AMENITIES/HIGHLIGHTS

- 24/7 access
- Newly renovated glass entry on 8th floor
- Exposed ceilings
- Natural light
- Elevator access for passengers and freight
- Rear loading dock

ECONOMIC DATA

LEASE TYPE: Gross

LEASE PRICE: Call for details

PROPERTY WEBSITE

Eric Solem
esolem@lee-associates.com
617.869.4605

Robert M. Elmer
relmer@lee-associates.com
617.899.0569

Scott Panneton
spanneton@lee-associates.com
978.551.6077

All information furnished regarding property for sale, rental or financing is from sources deemed reliable, but no warranty or representation is made to the accuracy thereof and same is submitted to errors, omissions, change of price, rental or other conditions prior to sale, lease or financing or withdrawal without notice. No liability of any kind is to be imposed on the broker herein.

OFFICE SUBLEASE

186 LINCOLN ST., 8TH & 9TH FLOOR

BOSTON, MA 02111



6,651 SF | FLOOR PLANS

8th Floor

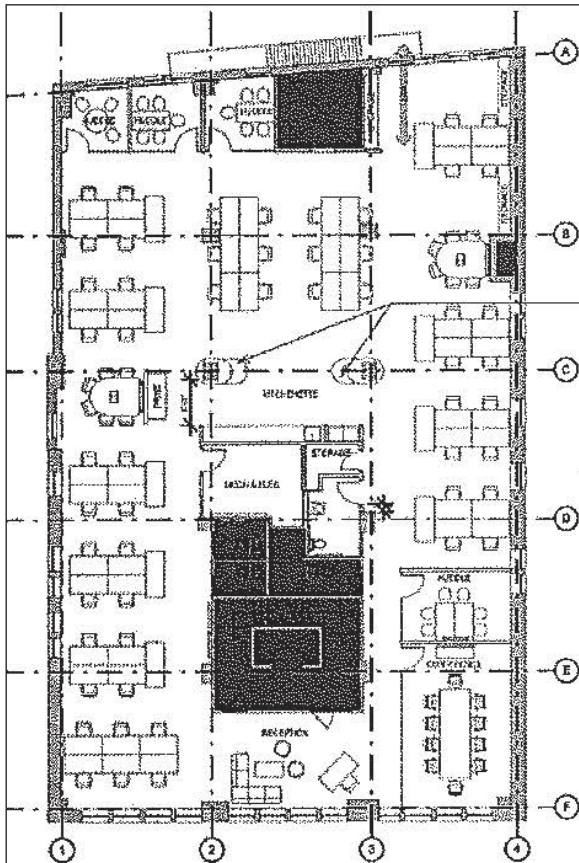

9th Floor

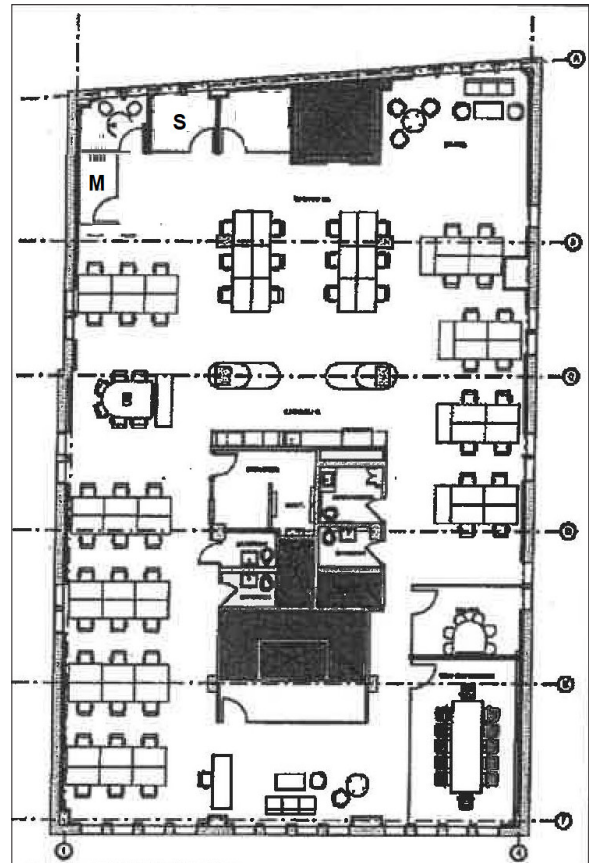

Eric Solem
esolem@lee-associates.com
617.869.4605

Robert M. Elmer
relmer@lee-associates.com
617.899.0569

Scott Panneton
spanneton@lee-associates.com
978.551.6077

All information furnished regarding property for sale, rental or financing is from sources deemed reliable, but no warranty or representation is made to the accuracy thereof and same is submitted to errors, omissions, change of price, rental or other conditions prior to sale, lease or financing or withdrawal without notice. No liability of any kind is to be imposed on the broker herein.