



PALMETTO GROVE

1242 - 1260 PALMETTO AVE
WINTERPARK, FL

±24,833 SQUARE FEET OF
CREATIVE OFFICE/RETAIL
COMMERCIAL SPACE

STREAM



PALMETTO GROVE | FRONT BUILDING VIEW





PALMETTO GROVE | BUILDING VIEW

PALMETTO GROVE | VIEW FROM NORTH PALMETTO AVE



WINTER PARK DEVELOPMENT



PALMETTO GROVE RENDERED SITE PLAN





PROJECT OVERVIEW

WHERE INSPIRATION MEETS PRESTIGE, YOUR BOUTIQUE WORKPLACE AWAITS:

Palmetto Grove isn't just an office/retail project; it's a curated collection of boutique workplaces, each fostering a collaborative and inspiring environment. Mingle with like-minded professionals, then step outside to explore upscale shops or grab a post-work cocktail with colleagues – all within walking-distance of your business address. Elevate your brand and empower your team in Winter Park's newest most sought-after work environment

PROPERTY HIGHLIGHTS

5

BUILDINGS

20,927 SF

AVAILABLE RENTABLE SF

3/1,000

PARKING RATIO

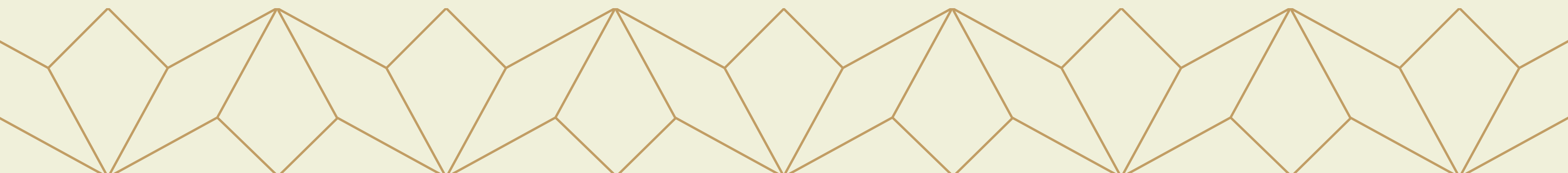



PROJECT DETAILS

SITE PLAN

- **EXISTING BUILDINGS**
3 - ONE STORY BUILDINGS | 13,883 SF TOTAL
- **NEW PROPOSED BUILDING**
2 - TWO STORY BUILDINGS | 11,000 SF TOTAL
- **RETAIL / OFFICES / MEDICAL**

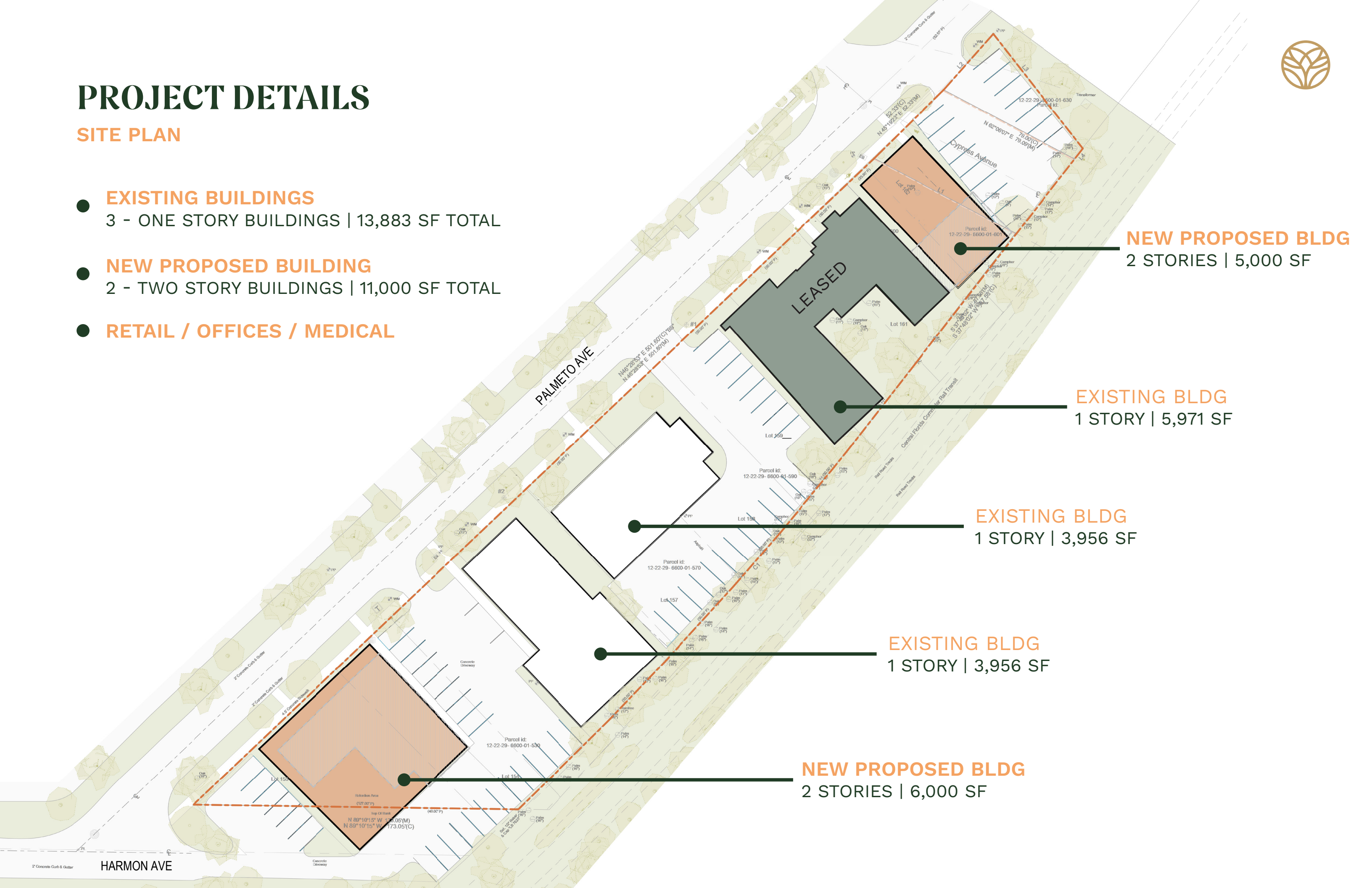

NEW PROPOSED BLDG
2 STORIES | 5,000 SF

EXISTING BLDG
1 STORY | 5,971 SF

EXISTING BLDG
1 STORY | 3,956 SF

EXISTING BLDG
1 STORY | 3,956 SF

NEW PROPOSED BLDG
2 STORIES | 6,000 SF



WINTER PARK OVERVIEW

Imagine your business nestled amidst the charming streets and sparkling lakes of Winter Park, Florida. This vibrant city, known for its upscale atmosphere and thriving cultural scene, offers more than just idyllic scenery.

Winter Park is adjacent to Palmetto Grove, and boasts a well-educated population with a high disposable income, making it a prime market for your business. Its popularity as a tourist destination guarantees a steady stream of potential customers year-round. The supportive business community and the city's focus on fostering a delightful customer experience make Winter Park the perfect place for your business to flourish. In a town with limited availability and a focus on aesthetics, the potential rewards of choosing Palmetto Grove in this amenity-rich, highly-walkable area are undeniable.





SEVEN OAKS PARK PROJECT

- **1.45 ACRES OF LUSH GREENSPACE**
- **91-SPACE PUBLIC PARKING LOT**
- **DESIGNED TO FOSTER PEDESITRIAN CONNECTIVITY**
- **VILLAGE-STYLE OURDOOR DINING EXPERIENCE**
- **\$4.96 MILLION PUBLIC INVESTMENT**
- **DIRECTLY ADJACENT TO PALMETTO GROVE**





PALMETTO GROVE

250 S Orange Avenue Suite 775 Orlando, FL 32801
407.214.0200
www.streamrealty.com

Darryl Hoffman
407.204.1548
darryl.hoffman@streamrealty.com

Jacob Attaway
407.204.9923
jacob.attaway@streamrealty.com

Copyright © 2024 Stream Realty Partners, All rights reserved.

The information contained herein was obtained from sources believed reliable; however, Stream Realty Partners, L.P. make no guarantees, warranties, or representations as to the completeness or accuracy thereof. The presentation of this property is submitted subject to errors, change of price, or conditions, prior sale or lease, or withdrawal without notice.

STREAM

