



FREESTANDING HIGH IMAGE INDUSTRIAL CONDO

± 6,728 SF FREESTANDING HIGH IMAGE INDUSTRIAL CONDO  
**FOR SALE** 3620 BRIGGEMAN DR.  
LOS ALAMITOS | CA

CONTACT EXCLUSIVE LISTING AGENTS:



**MIKE BARREIRO, SIOR**  
E.V.P. | PRINCIPAL  
P: 949.355.8500  
mbarreiro@daumcre.com  
CA DRE License #01712620



**DEVIN RAY**  
VICE PRESIDENT  
M: 714.322.1252  
dray@daumcre.com  
CA DRE License #02018130



± 6,728 SF  
FREESTANDING  
HIGH IMAGE  
INDUSTRIAL CONDO



1 GL DOOR  
(12W X 14H)



400  
AMPS  
POWERS



19'-21'  
WAREHOUSE  
CLEARANCE

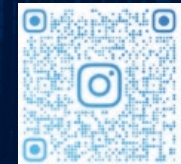

OCINDUSTRIALWAREHOUSES



±6,728 SF  
FREESTANDING  
HIGH IMAGE  
INDUSTRIAL CONDO

3620 BRIGGEMAN DR.  
LOS ALAMITOS | CA

FOR SALE

## PROPERTY HIGHLIGHTS

- ±6,728 SF Freestanding High Image Industrial Condo
- 2007 Construction
- ±1,500 SF Office
- ±780 SF Bonus Mezzanine
- 19'-21' Warehouse Clearance
- 400 amps (120/208v) \*Verify
- 1 Ground Level Door (12'w X 14'h)
- Sprinklered (.17 gpm per sq ft)
- Two (2) Restrooms
- Kitchenette/Sink
- Highly Desirable West Orange County Location
- Centrally Located in Close Proximity to the 605, 405 and 22 FWYS as well as the Ports of Long Beach & Los Angeles



### CONTACT EXCLUSIVE LISTING AGENTS:



**MIKE BARREIRO, SIOR**  
E.V.P. | PRINCIPAL  
P: 949.355.8500  
mbarreiro@daumcre.com  
CA DRE License #01712620



**DEVIN RAY**  
VICE PRESIDENT  
M: 714.322.1252  
dray@daumcre.com  
CA DRE License #02018130



### PROPERTY HIGHLIGHTS

**DAUM**  
COMMERCIAL REAL ESTATE SERVICES

±6,728 SF  
FREESTANDING  
HIGH IMAGE  
INDUSTRIAL CONDO

3620 BRIGGEMAN DR.  
LOS ALAMITOS | CA

FOR SALE

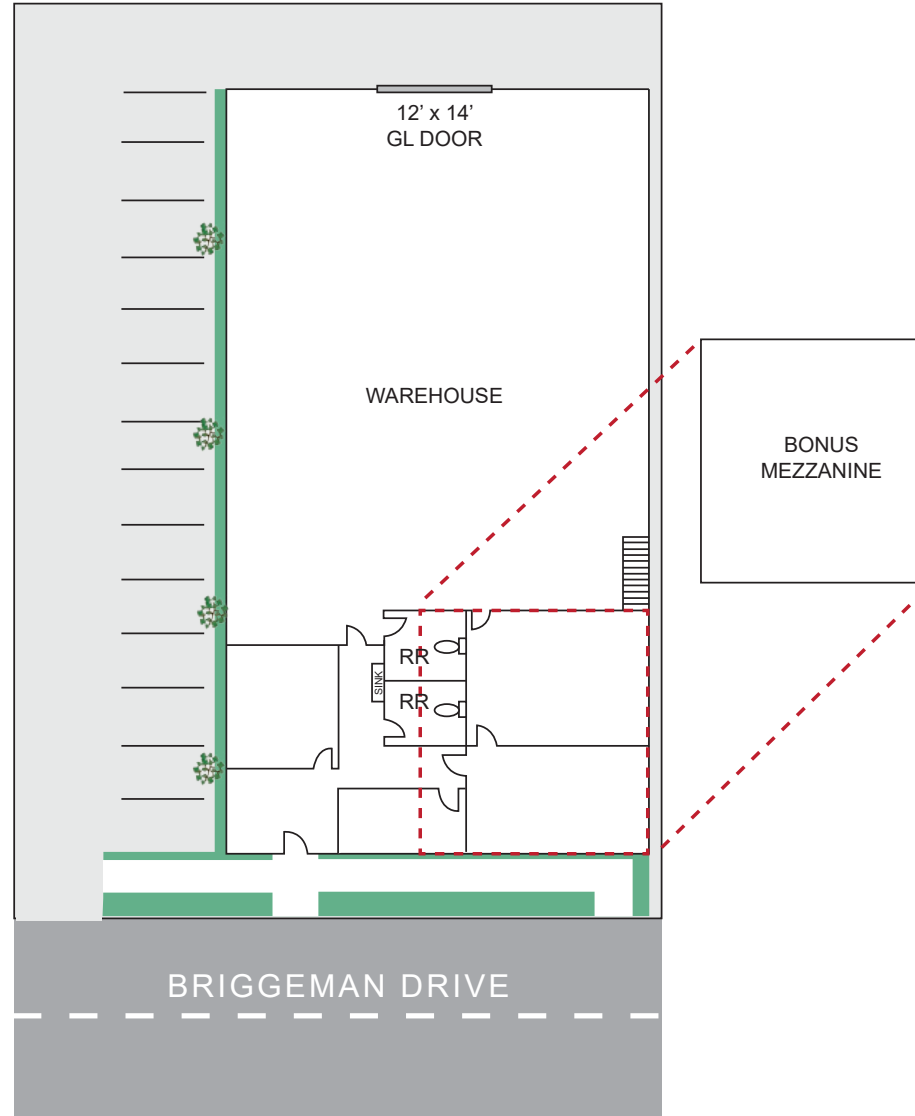

CONTACT EXCLUSIVE LISTING AGENTS:



**MIKE BARREIRO, SIOR**  
E.V.P. | PRINCIPAL  
P: 949.355.8500  
mbarreiro@daumcre.com  
CA DRE License #01712620



**DEVIN RAY**  
VICE PRESIDENT  
M: 714.322.1252  
dray@daumcre.com  
CA DRE License #02018130



PROPERTY PHOTOS





±6,728 SF  
FREESTANDING  
HIGH IMAGE  
INDUSTRIAL CONDO

3620 BRIGGEMAN DR.  
LOS ALAMITOS | CA

FOR SALE



CONTACT EXCLUSIVE LISTING AGENTS:



**MIKE BARREIRO, SIOR**  
E.V.P. | PRINCIPAL  
P: 949.355.8500  
mbarreiro@daumcre.com  
CA DRE License #01712620



**DEVIN RAY**  
VICE PRESIDENT  
M: 714.322.1252  
dray@daumcre.com  
CA DRE License #02018130



PROPERTY PHOTOS





±6,728 SF  
FREESTANDING  
HIGH IMAGE  
INDUSTRIAL CONDO

3620 BRIGGEMAN DR.  
LOS ALAMITOS | CA

FOR SALE



CONTACT EXCLUSIVE LISTING AGENTS:



**MIKE BARREIRO, SIOR**  
E.V.P. | PRINCIPAL  
P: 949.355.8500  
mbarreiro@daumcre.com  
CA DRE License #01712620



**DEVIN RAY**  
VICE PRESIDENT  
M: 714.322.1252  
dray@daumcre.com  
CA DRE License #02018130



PROPERTY PHOTOS





±6,728 SF  
FREESTANDING  
HIGH IMAGE  
INDUSTRIAL CONDO

3620 BRIGGEMAN DR.  
LOS ALAMITOS | CA

FOR SALE



CONTACT EXCLUSIVE LISTING AGENTS:



**MIKE BARREIRO, SIOR**  
E.V.P. | PRINCIPAL  
P: 949.355.8500  
mbarreiro@daumcre.com  
CA DRE License #01712620



**DEVIN RAY**  
VICE PRESIDENT  
M: 714.322.1252  
dray@daumcre.com  
CA DRE License #02018130



PROPERTY PHOTOS

**DAUM**  
COMMERCIAL REAL ESTATE SERVICES



±6,728 SF  
FREESTANDING  
HIGH IMAGE  
INDUSTRIAL CONDO

3620 BRIGGEMAN DR.  
LOS ALAMITOS I CA

FOR SALE



CONTACT EXCLUSIVE LISTING AGENTS:



**MIKE BARREIRO, SIOR**  
E.V.P. | PRINCIPAL  
P: 949.355.8500  
mbarreiro@daumcre.com  
CA DRE License #01712620



**DEVIN RAY**  
VICE PRESIDENT  
M: 714.322.1252  
dray@daumcre.com  
CA DRE License #02018130



AMENITIES MAP





±6,728 SF  
FREESTANDING  
HIGH IMAGE  
INDUSTRIAL CONDO

3620 BRIGGEMAN DR.  
LOS ALAMITOS | CA

FOR SALE

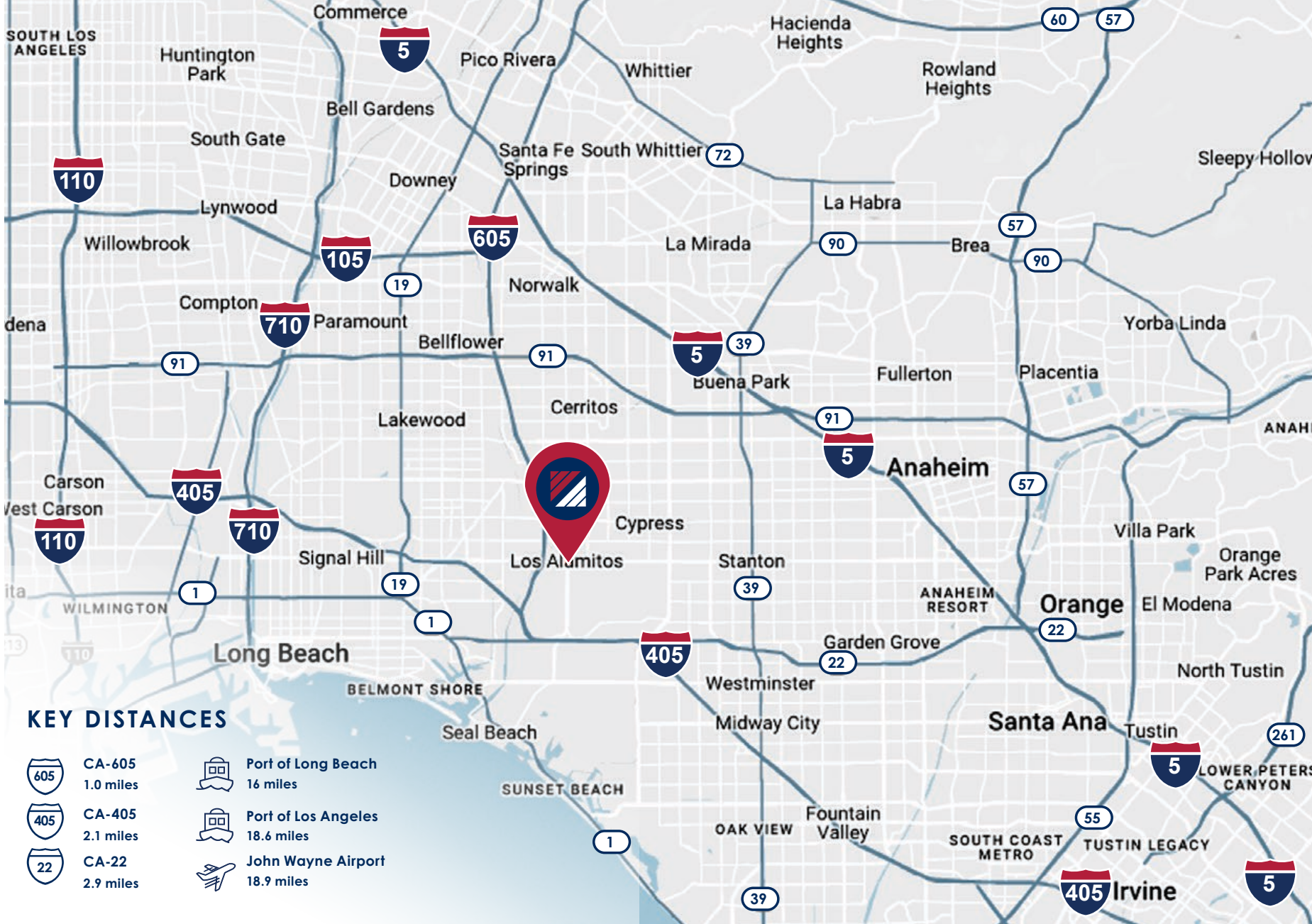

CONTACT EXCLUSIVE LISTING AGENTS:



**MIKE BARREIRO, SIOR**  
E.V.P. | PRINCIPAL  
P: 949.355.8500  
mbarreiro@daumcre.com  
CA DRE License #01712620



**DEVIN RAY**  
VICE PRESIDENT  
M: 714.322.1252  
dray@daumcre.com  
CA DRE License #02018130



LOCATION MAP

