

**Developmental Commercial Land**  
**Lot C-13 N Federal - 8 Acres**  
**\$1,568,160**



**Large Commercial lot in Eastern Shoshone Business Park. Located in the north end of the Eastern Shoshone Business Park, adjacent to Honor Farm Road, this 8.0 acre parcel is available for Commercial development. This premium site will be located near shopping, dining and medical options and is available to be connected to city utilities.**

**Current zoning allows for a variety of commercial development options: whether you're looking to build a hotel, restaurant, retail shopping center, or some other commercial development. Purchase is contingent on survey and replat approval by City of Riverton. Contact David Kellner at 307-851-4629 for more details**



**David Kellner**  
**Associate Broker**  
**307-851-4629**



**804 W Main Street, Riverton, WY**  
**307-856-4663**  
**[www.WyomingHomeSource.com](http://www.WyomingHomeSource.com)**

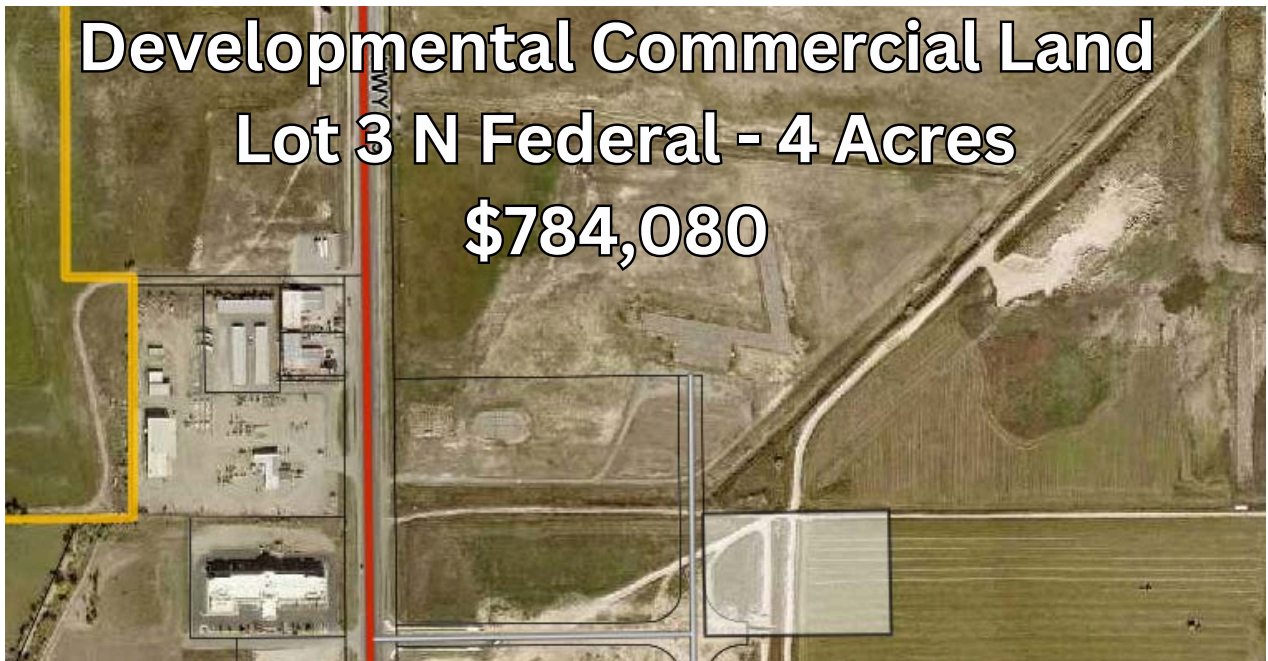

**Large Commercial lot in Eastern Shoshone Business Park. Located in the heart of the Eastern Shoshone Business Park, this 4.0 acre parcel is available for Commercial development. This premium site will be located near shopping, dining and medical options and is available to be connected to city utilities. Current zoning allows for a variety of commercial development options: whether you're looking to build a coffee shop, restaurant, retail shopping center, or some other commercial development. Purchase is contingent on survey and replat approval by City of Riverton.**

**Contact David Kellner at 307-851-4629 for more details.**



**David Kellner  
Associate Broker  
307-851-4629**



**804 W Main Street, Riverton, WY  
307-856-4663  
[www.WyomingHomeSource.com](http://www.WyomingHomeSource.com)**