

FOR LEASE ±15,405 Sq. Ft.

FREESTANDING INDUSTRIAL BUILDING

331 W. Levers Pl., Orange



Property Features

- ±2,500 Sq. Ft. of Office Space
- 18' Minimum Warehouse Clearance
- Two (2) 12' x 14' Ground Level Loading Doors
- Two (2) Dock High Doors
- Fire Sprinklered (.21 GPM/1,500 Sq. Ft.)
- 400 Amps of Distributed Power
- Double Exterior Truck Well
- Drive Around Access
- 2:1000 Parking Ratio
- Excellent Access to the 57, 91 and 5 Freeways



MIKE HEFNER, SIOR
Executive Vice President
714.935.2331
Lic. #00857352
mhefner@voitco.com

BRENDEN HEFNER
Senior Associate
714.935.2326
Lic. #02114046
bhefner@voitco.com

Voit
REAL ESTATE SERVICES

HV HEFNER
VERNICK
TEAM

FOR LEASE ±15,405 Sq. Ft.

FREESTANDING INDUSTRIAL BUILDING

331 W. Levers Pl., Orange

SITE PLAN

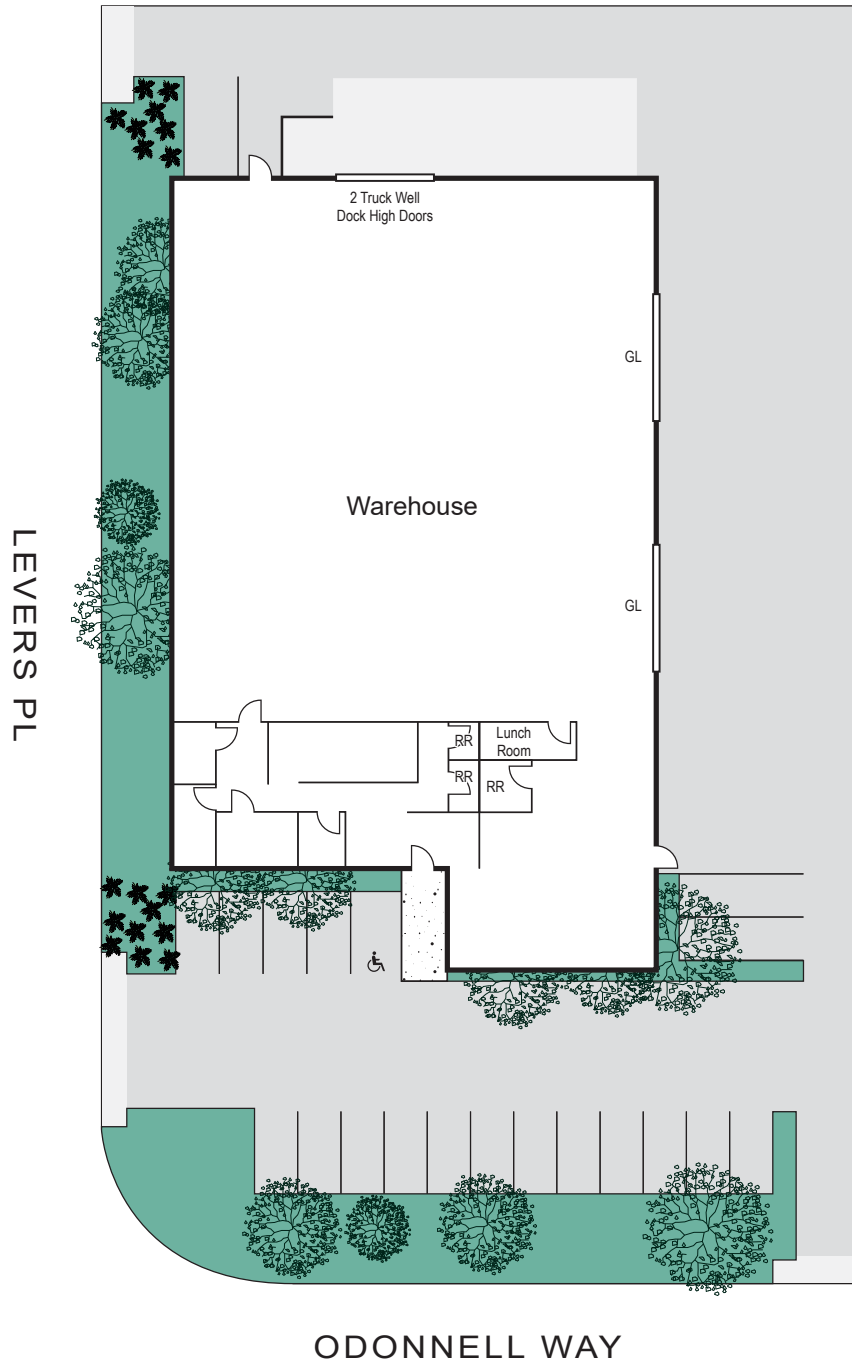

*Site plan not to scale.

MIKE HEFNER, SIOR
Executive Vice President
714.935.2331
Lic. #00857352
mhefner@voitco.com

BRENDEN HEFNER
Senior Associate
714.935.2326
Lic. #02114046
bhefner@voitco.com

Voit
REAL ESTATE SERVICES

**HEFNER
VERNICK
TEAM**

2400 E. Katella Ave., Suite 750, Anaheim, CA 92806 • 714.978.7880 • 714.978.9431 Fax

Licensed as Real Estate Broker and Salesperson by the CA Bar of Real Estate. The information contained herein has been obtained from sources we deem reliable. While we have no reason to doubt its accuracy, we do not guarantee it. ©2025 Voit Real Estate Services, Inc. All Rights Reserved. License #0133376.

www.VoitCo.com