



TRANSWESTERN

REAL ESTATE  
SERVICES

# SAINT PAUL INDUSTRIAL PROPERTIES #17

6286 CLAUDE WAY EAST

INVER GROVE HEIGHTS, MN 554076

# PROPERTY SPECIFICATIONS



**Building Size:** 60,280 SF

**Availability:** 3,984 SF Office  
7,754 SF Warehouse  
11,738 SF Total

**Loading:** 2 Dock | 1 Drive-In

**Clear Height:** 22'

**Lease Rates:** \$10.00 PSF Office  
\$5.00 PSF Warehouse

**Taxes:** \$1.35 PSF (2023)

**Operating Expenses:** \$1.15 PSF (2023)



# FLOORPLAN

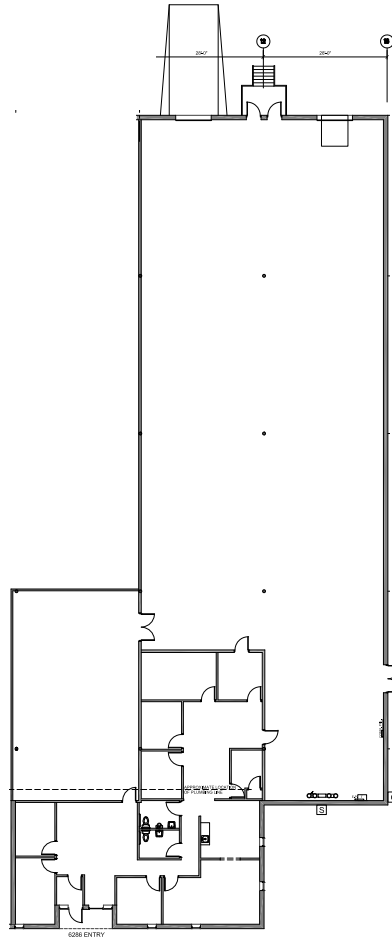

## SQUARE FEET

Office: 3,984 SF

Warehouse: 7,754 SF

---

Total: 11,738 SF





**TRANSWESTERN**

REAL ESTATE  
SERVICES

# THINKING BEYOND THE OBVIOUS

---

**ALEX BARON**

612.359.1658

[alex.baron@transwestern.com](mailto:alex.baron@transwestern.com)

**JOHN THOMPSON, SIOR**

612.359.1645

[john.thompson@transwestern.com](mailto:john.thompson@transwestern.com)