

Available SF 15,680 SF

Industrial For Sale

Building Size 15,680 SF



Address: 851 E 60th St, Los Angeles, CA 90001

Cross Streets: S Central Ave/E 60th St

Fabulous Multi-Purpose Brick Building
True – 46" – Dock High Loading Via Covered Dock
High Clear – 30' Center Bay – Loads of Natural Light
Fenced Yard W/ Good Loading for 53' Trucks- + GL Loading
Very Functional 2,800 SF + "Bonus" Mezzanine - Part AC
Business Improvement District w/ Cameras & Security Patrol

Sale Price: \$3,418,000.00
Sale Price/SF: \$217.98
Available SF: 15,680 SF
Prop Lot Size: 0.51 Ac / 22,300 SF
Taxes:
Yard: Yes
Zoning: M2

Sprinklered: No
Clear Height: 14' - 30'
GL Doors/Dim: 1 / 12'x10'
DH Doors/Dim: 1 / 10'x9'
A: 400 V: 240 O: 3 W: 3
Construction Type: Masonry
Const Status/Year Blt: Existing / 1930R85

Whse HVAC: No
Parking Spaces: 12 / Ratio: 0.8:1
Rail Service: No
Specific Use: Light Industrial

Office SF / #: 1,775 SF / 5
Restrooms: 4
Office HVAC: None
Finished Ofc Mezz: 0 SF
Include In Available: No
Unfinished Mezz: 2,874 SF
Include In Available: No
Possession: COE
Vacant: No
To Show: Call broker
Market/Submarket: Outlying Los Angeles
APN#: 6007-004-012

Listing Company: Dorin Realty Company
Agents: [Mark Whitman 213-627-0007](mailto:mwhitman@dorinrealty.com)

Listing #: 43309374

Listing Date: 09/05/2025

FTCF: CB000N000S200/A0AA

Notes: 30' clear in center bay. Front section 8 car parking head in street parking. Roof type: Monitor & WBD. Additional power panel: 200A, 240V, 1 Phase. Property can be delivered with existing pallet racking. All details must be verified. Possession is 60 days after COE.



Mark Whitman
mwhitman@dorinrealty.com
213-627-0007

851 E. 60th Street, Los Angeles, CA 90001

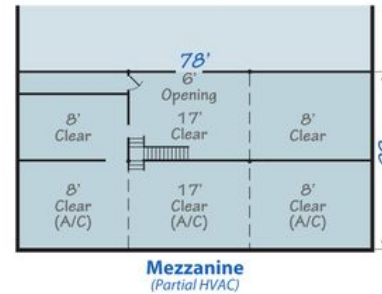
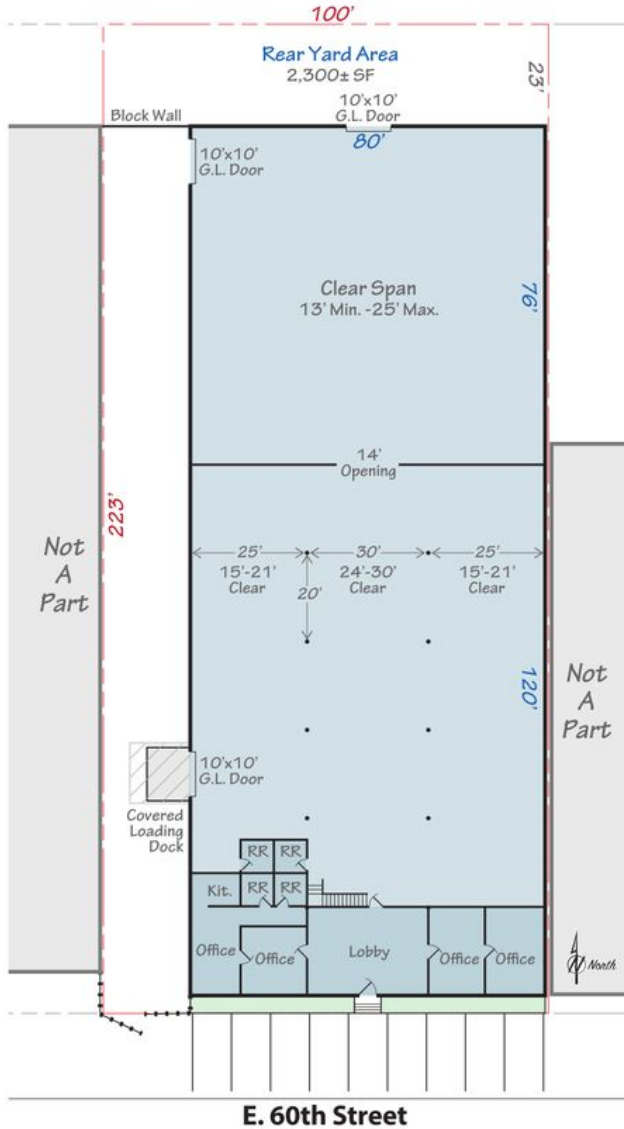

Contact exclusive agent:

Mark Whitman

Lic. No. 00918875

mwhitman@dorinrealty.com

213-627-0007 Ext 124

4555 Pacific Blvd., Vernon, CA 90058-2207

Industrial and Commercial Real Estate Specialists

Since 1959

www.dorinrealty.com

The information contained herein is from sources we believe to be reliable but, we do not guarantee its accuracy. All measurements & dimensions are approximations and are not to scale. Clients are encouraged to verify their accuracy.



Mark Whitman

mwhitman@dorinrealty.com

213-627-0007



Powered by
MOODY'S