

OFFICE/FLEX UNITS - FOR LEASE MURRAY BUSINESS CENTER

7273-7475 MURRAY DRIVE, STOCKTON, CA



- **AVAILABLE SF:** 4,224± SF (2 UNITS)
- **ZONING:** C-G (COMMERCIAL GENERAL)
- **CONSTRUCTION:** Concrete Tilt-up
- **CLEARANCE:** 10'± - 16'±
- **POWER:** 100-200 Amp, 120-208 volt
- **DOORS:** One (1) GL Door in most units
- **AMPLE PARKING**
- **PROFESSIONALLY MANAGED**
- **BUILDING SIGNAGE AVAILABLE**
- **GATED PERIMETER**



CONTACT:

Jim Martin, SIOR
BRE #01214270
jmartin@lee-associates.com
D 209.983.4088
C 925.352.6948

Jake Cardinale
BRE #02190768
jcardinale@lee-associates.com
D 209.983.1111
C 209.480.5108

FLEX UNITS / FOR LEASE MURRAY BUSINESS CENTER

7273-7475 MURRAY DRIVE, STOCKTON, CA

Murray Business Center	7273 Murray Drive SUITE 4A	7273 Murray Drive SUITE 5	7273 Murray Drive SUITE 6	7475 Murray Drive SUITE 7
SPACE SIZE	LEASED	LEASED	2,497± SF	1,727± SF
LEASE RATE	\$1.00 PSF Gross	\$1.00 PSF Gross	\$1.00 PSF Gross	\$1.00 PSF Gross
COMMENTS / FEATURES	1 GL DOOR ALL SHOP STORAGE	100% CONDITIONED SPACE, 2 GL DOORS	2 OFFICES, BREAKROOM, 1 GL DOOR	1 GL DOOR ALL SHOP STORAGE

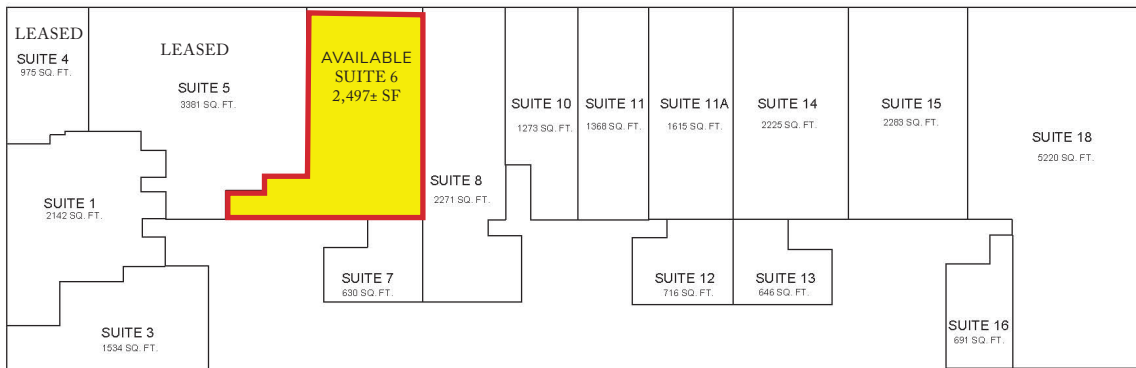

Updated common area restroom



SUITE 6:

Two (2) private offices, Breakroom, Insulated Warehouse/Shop area with LED lights, One (1) GL door



FLEX UNITS / FOR LEASE MURRAY BUSINESS CENTER

7273-7475 MURRAY DRIVE, STOCKTON, CA

7475 MURRAY DRIVE

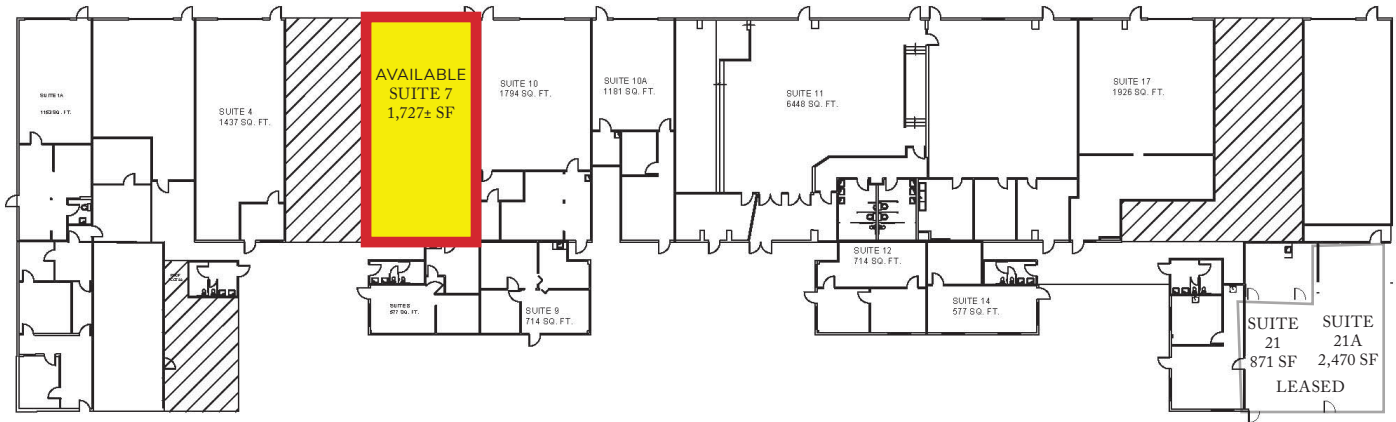

SUITE 7: 1 GL door, insulated, skylights. All storage/shop.



CONTACT:

Jim Martin, SIOR
BRE #01214270
jmartin@lee-associates.com
D 209.983.4088
C 925.352.6948

Jake Cardinale
BRE #02190768
jcardinale@lee-associates.com
D 209.983.1111
C 209.480.5108

All information furnished regarding property for sale, rental or financing is from sources deemed reliable, but no warranty or representation is made to the accuracy thereof and same is submitted to errors, omissions, change of price, rental or other conditions prior to sale, lease or financing or withdrawal without notice. No liability of any kind is to be imposed on the broker herein.

FLEX UNITS / FOR LEASE MURRAY BUSINESS PARK

7273 - 7475 MURRAY DRIVE, STOCKTON,

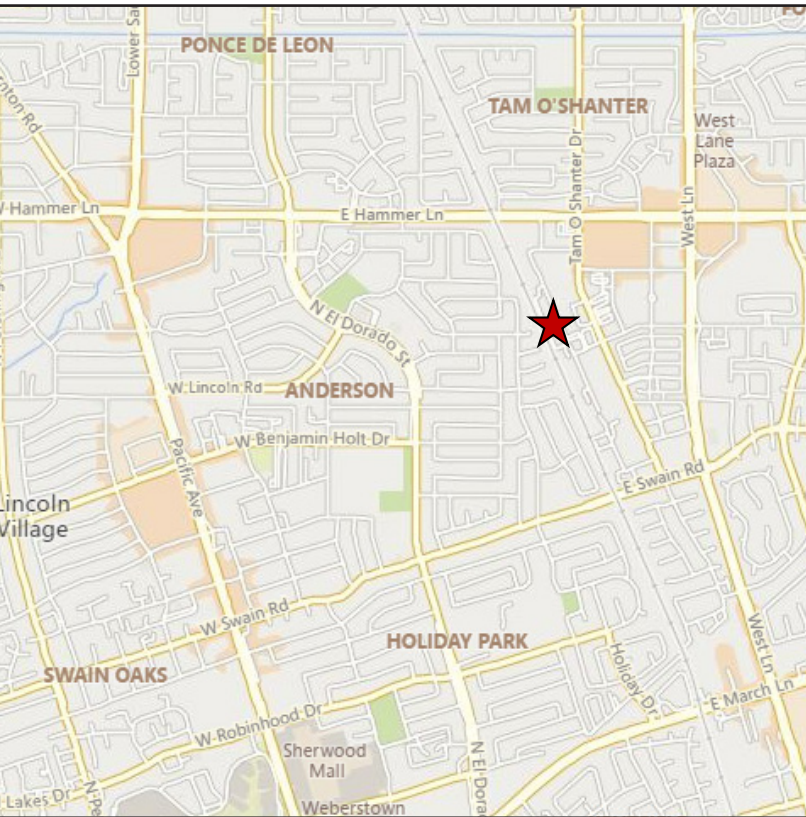
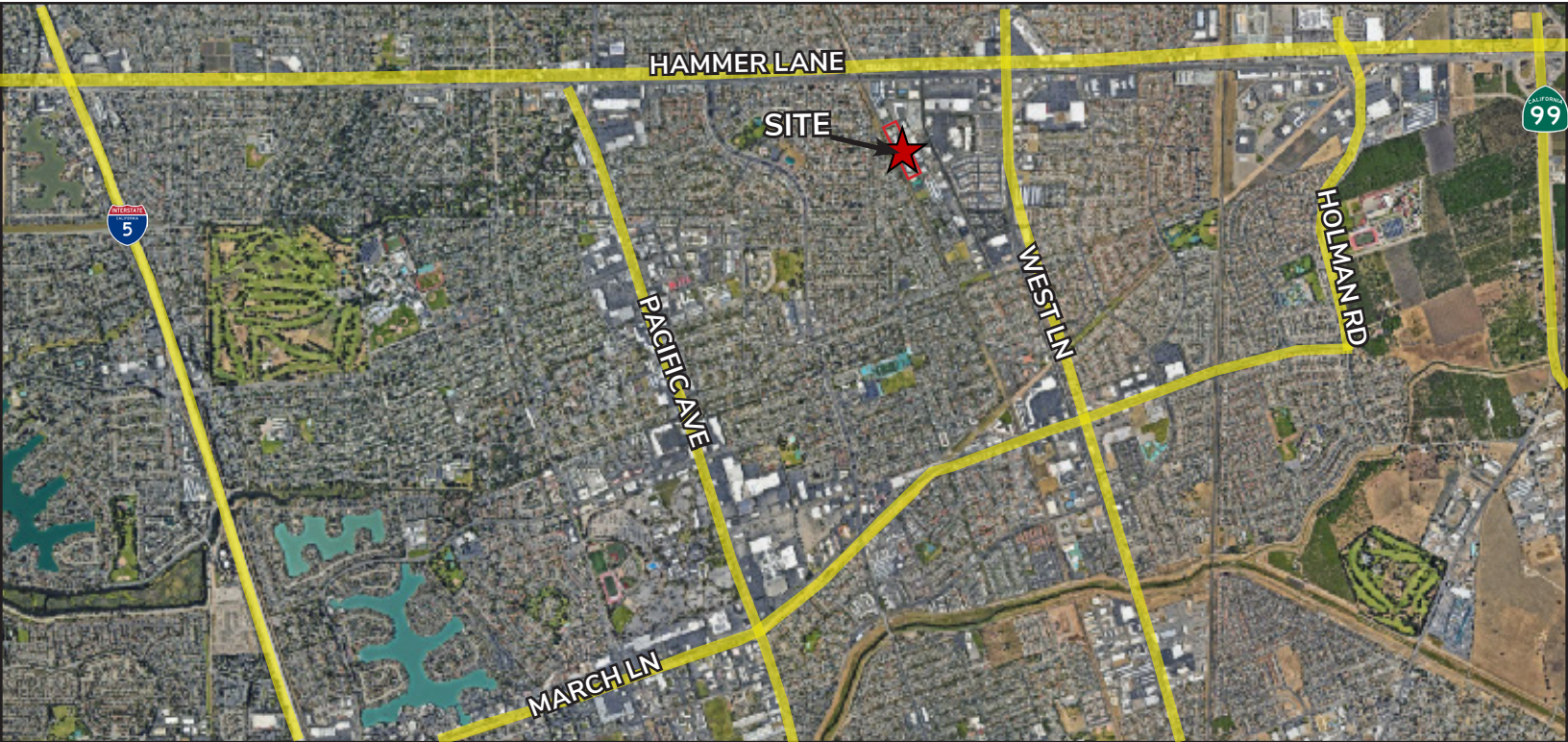

All information furnished regarding property for sale, rental or financing is from sources deemed reliable, but no warranty or representation is made to the accuracy thereof and same is submitted to errors, omissions, change of price, rental or other conditions prior to sale, lease or financing or withdrawal without notice. No liability of any kind is to be imposed on the broker herein.