



# Premera Headquarters

Sale Price: \$9,995,000

3900 E. Sprague, Spokane, WA 99202

**KIEMLE  
HAGOOD**

**Craig Soehren,**

Broker

509.755.7548

[craigs@kiemlehagood.com](mailto:craigs@kiemlehagood.com)



# PROPERTY OVERVIEW

## Premera Spokane Campus

Spokane | Washington

This well-maintained Class A asset is now available for sale to an Investor or User. Three buildings containing  $\pm 103,000$  square feet plus structured parking facility on the  $\pm 5.8$  Acre site is ideal for a corporate headquarters or redevelopment opportunity.



# PROPERTY DETAILS

## Premera Spokane Campus

Spokane | Washington

Sale price: \$9,995,000



**PARCEL #:** 35221.0311

**ZONING:** CB-55 / GC-70

- Well maintained campus in excellent condition
- 491 on-site parking stalls, both surface and structured, a ratio of 4.77:1000 Square Feet
- Data Center and Large Cafeteria located in Building 1, with small Cafeteria in Building 3
- Emergency generators in place
- Easy access to I-90 via Freya interchange
- Existing furniture available for plug and play users

# THE CAMPUS

The 5.8 Acre Spokane Campus consists of three office buildings plus a 308-space parking structure that was constructed in 2006.

Surface parking consists of 167 employee spaces and a separate 16 stall customer parking area.

Located on East Sprague in the City of Spokane, the campus sites within one half mile of I-90 and near the future North/South freeway couplet.

Each Building is laid out in a basic open office concept with hard wall private offices, conference rooms and quiet rooms. Building One and Two are of tilt up construction while Building Three and the Parking Garage are of post tension design.

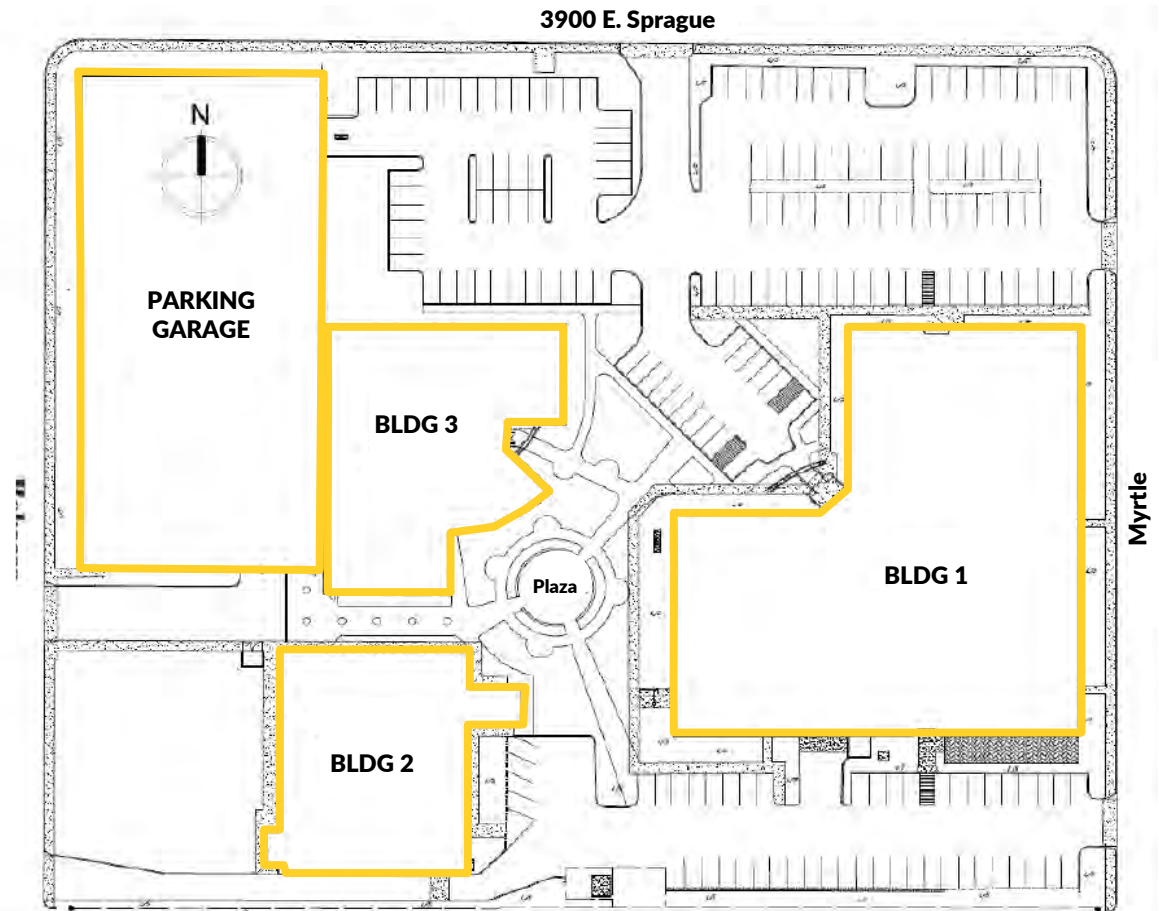

BUILDING #	RSF	YEAR BUILT/ REMODELED
ONE	41,759 SF	1982/2001
TWO	19,973 SF	1992/2001
THREE	40,980 SF	2006
GARAGE		2006

# THE LOCATION

## Premera Spokane Campus Spokane | Washington



# AERIAL VIEW

## Premera Spokane Campus Spokane | Washington







Conference Room



Office Furniture



Cafe



Loading Dock



# PREMERA HEADQUARTERS

3900 E Sprague | Spokane, WA 99202



**Craig Soehren,**

Broker

509.755.7548

[craigs@kiemlehgagood.com](mailto:craigs@kiemlehgagood.com)

## KIEMLE HAGOOD

No warranty or representation, expressed or implied, is made by Kiemle Hagood, its agents or its employees as to the accuracy of the information contained herein. All information furnished is from sources deemed reliable and submitted subject to errors, omissions, change of terms and conditions, prior sale, lease or financing, or withdrawal without notice. No one should rely solely on the above information, but instead should conduct their own investigation to independently satisfy themselves.

Kiemle Hagood respects the intellectual property of others: If you believe the copyright in your work has been violated through this Website, please contact our office for notice of claims of copyright infringement. For your complaint to be valid under the Digital Millennium Copyright Act of 1998 (DMCA), you must provide the following information when providing notice of the claimed copyright infringement: Identify the material on the Website that you believe infringes your work, with enough detail so that we may locate it on the Website; provide your address, telephone number and email address; provide a statement that you have a good faith belief that the disputed use is not authorized by the copyright owner, its agent, or the law; provide a statement that the information in the notification is accurate, and under penalty of perjury, that the complaining party is authorized to act on behalf of owner of an exclusive right that is allegedly infringed; provide your physical or electronic signature. Upon receiving your complaint, Kiemle Hagood will, upon review, remove content that you believe infringes your copyright if the complaint is found valid.

