

8181 Arista Place

MIXED-USE URBAN LIFESTYLE CENTER FEATURING
PREMIUM CLASS A OFFICE AND STREET-LEVEL RETAIL

19,621 - 39,242 RSF
Office Space For Lease

(FULL FLOORS AVAILABLE)



Nestled in the heart of vibrant Arista Place, this property overlooks beautiful Arista Park, featuring a choreographed dancing water fountain, bandstand and fire pit

NEWMARK

ARISTA
PLACE
BROOMFIELD CO



8181 Arista Place

Property Information:

Address	8181 Arista Place Broomfield, Colorado 80021
Building Size	90,013 SF
Class	Class A
Year Built	2016
Stories	5
Typical Floor Size	19,621 SF
Available	19,621 - 39,242 RSF
Rental Rate	Negotiable
Expenses	\$16.82/SF (2025 expenses)
Parking	4.72 : 1,000 SF (includes covered spaces)

Property Highlights:

- Creative High-End Finishes
- 3 Conference Rooms
- 126 Workstations
- Large Training Room
- 10 Huddle Rooms
- Kitchen/Tenant Lounge
- Collaboration Spaces
- Lobby/Reception Area



Surrounding Amenities:

- 8 landscaped parks
- Aloft Hotel
- The Colorado Keg House
- Comfort Suites Hotel
- Hickory & Ash
- Proto's Pizza
- RTD Park-n-Ride
- Starbucks
- US 36 bike trails



- 200,000 SF of office space
- 300,000 SF future office mixed-use
- 200,000 SF future of medical

- 1,590 multi-family units
- 34 row-homes
- 13 Live Work lofts
- 387 units under construction

- 139-room Aloft Hotel
- 104-room Comfort Suites

- 8 landscaped parks
- US 36 bike trail
- Retail shops— Salon Cosabella, Denver Restorative Dentistry, ARISTA Wine & Spirits, Polish Nails, Edward Jones, SPACES. Co-working.
- Restaurants— Arista Deli, Hickory & Ash, Colorado Keg House, Proto's Pizza, WXYZ Bar, Starbucks, Hops N Drops, VINCA Wine Bar
- Turnpike Shops at ARISTA— WeatherTech Factory Retail Store
- More retail planned

- Bus Rapid Transit
- Broomfield Station
- Flatiron Flyer

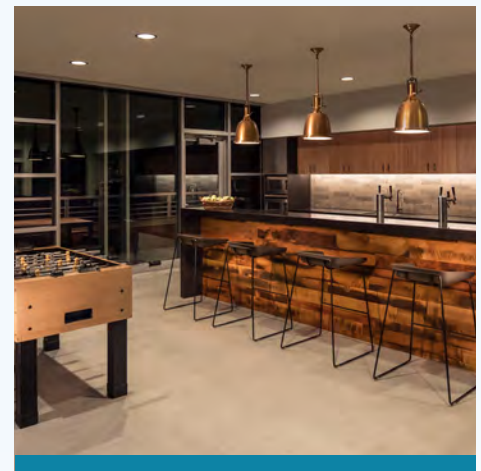

Location:

At the intersection of US 36, Wadsworth Parkway and West 120th Avenue, with excellent visibility and signage from US 36.

BOULDER: 13 MILES | **DOWNTOWN DENVER: 19 MILES** | **DIA: 37 MILES**

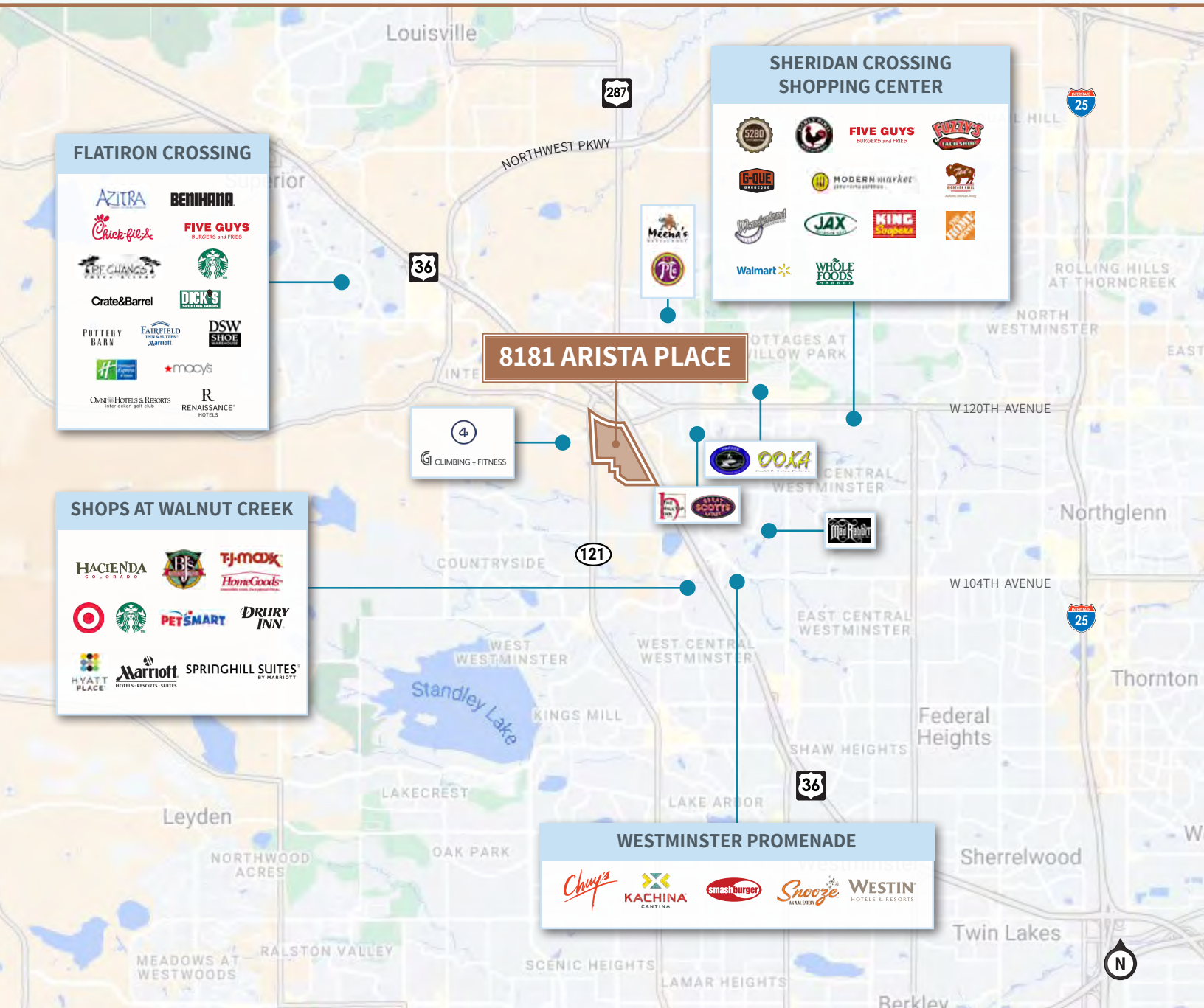

FOR MORE INFORMATION, CONTACT

DON MISNER Senior Managing Director
303-882-5730
don.misner@nmrk.com

JOE HEATH Senior Managing Director
303-960-5525
joe.heath@nmrk.com

ARISTA
PLACE
BROOMFIELD CO

NEWMARK

The information contained herein has been obtained from sources deemed reliable but has not been verified and no guarantee, warranty or representation, either express or implied, is made with respect to such information. Terms of sale or lease and availability are subject to change or withdrawal without notice.