

One Mile to I-465 & I-69
Interchange Northeast Indy

VIDEO



TCN
WORLDWIDE
REAL ESTATE SERVICES

AVAILABLE SF

6,300 SF

LEASE RATE

\$10.00 SF/YR (NNN)

PROPERTY HIGHLIGHTS

- Flex/Industrial for lease
- Only one (1) space left
- New ownership
- Easy access
- Binford Blvd. frontage exposure
- Ample parking

FOR LEASE

PARK PLAZA

5705-5797

Park Plaza Ct.,
Indianapolis, IN
46220



PETE ALVEAL

O: 317.454.7171 | C: 317.997.9362
palveal@premiercres.com

TOM FERGUSON

O: 317.454.7171 | C: 317.714.7171
tferguson@premiercres.com

Premier Commercial | TCN Worldwide • 9785 Crosspoint Blvd., Ste. 118, Indianapolis, IN 46256 • 317.454.7171 • premiercres.com

The information contained herein has been obtained from sources we deem reliable. Although we have no reason to doubt its accuracy, we do not guarantee the information is correct or complete. Marketing materials & documents alike may only be reproduced in their entirety, without modification or deletion. Photos are the property of their respective Owners, & use of these without the written consent of said Owner is prohibited. © 2024, Premier Commercial Real Estate Services, LLC

PARK PLAZA

5705-5797 Park Plaza Ct., Indianapolis, IN 46220

FOR LEASE



PROPERTY DESCRIPTION

Industrial/Flex Space in a wonderful location. Close to interstates, city thoroughfares, & several amenities, such as shopping, restaurants, gas stations, etc. This is a flexible & efficient space for lease. Act fast to secure the last available unit. Enjoy the convenience of easy access & prime exposure along Binford Blvd. with ample parking for your business needs. Whether you're a startup, expanding enterprise, or established business, this is the ideal location to grow & thrive. Don't miss this opportunity to elevate your operations in this sought-after industrial space.

LOCATION DESCRIPTION

Located just off of Binford Boulevard. One mile south of the I-465 / I-69 interchange. Building frontage directly on Binford Boulevard, between 65th Street & 71st Street. Very high visibility on Indy's northside. Discover the vibrant industrial landscape surrounding Park Plaza. Nestled within a dynamic economic hub, the location offers easy access to key transport routes & a diverse range of industrial & flex space tenants. The area also hosts a thriving network of manufacturing, logistics, & distribution facilities, cementing Park Plaza's position as an industrial hotspot. Join this thriving community & unlock unparalleled opportunities for growth & success in the heart of Indianapolis.

PETE ALVEAL

O: 317.454.7171 | C: 317.997.9362
palveal@premiercres.com

TOM FERGUSON

O: 317.454.7171 | C: 317.714.7171
tferguson@premiercres.com

PARK PLAZA

5705-5797 Park Plaza Ct., Indianapolis, IN 46220

FOR LEASE



PETE ALVEAL

O: 317.454.7171 | C: 317.997.9362
palveal@premiercres.com

TOM FERGUSON

O: 317.454.7171 | C: 317.714.7171
tferguson@premiercres.com

Premier Commercial | TCN Worldwide • 9785 Crosspoint Blvd., Ste. 118, Indianapolis, IN 46256 • 317.454.7171 • premiercres.com

PARK PLAZA

5705-5797 Park Plaza Ct., Indianapolis, IN 46220

FOR LEASE

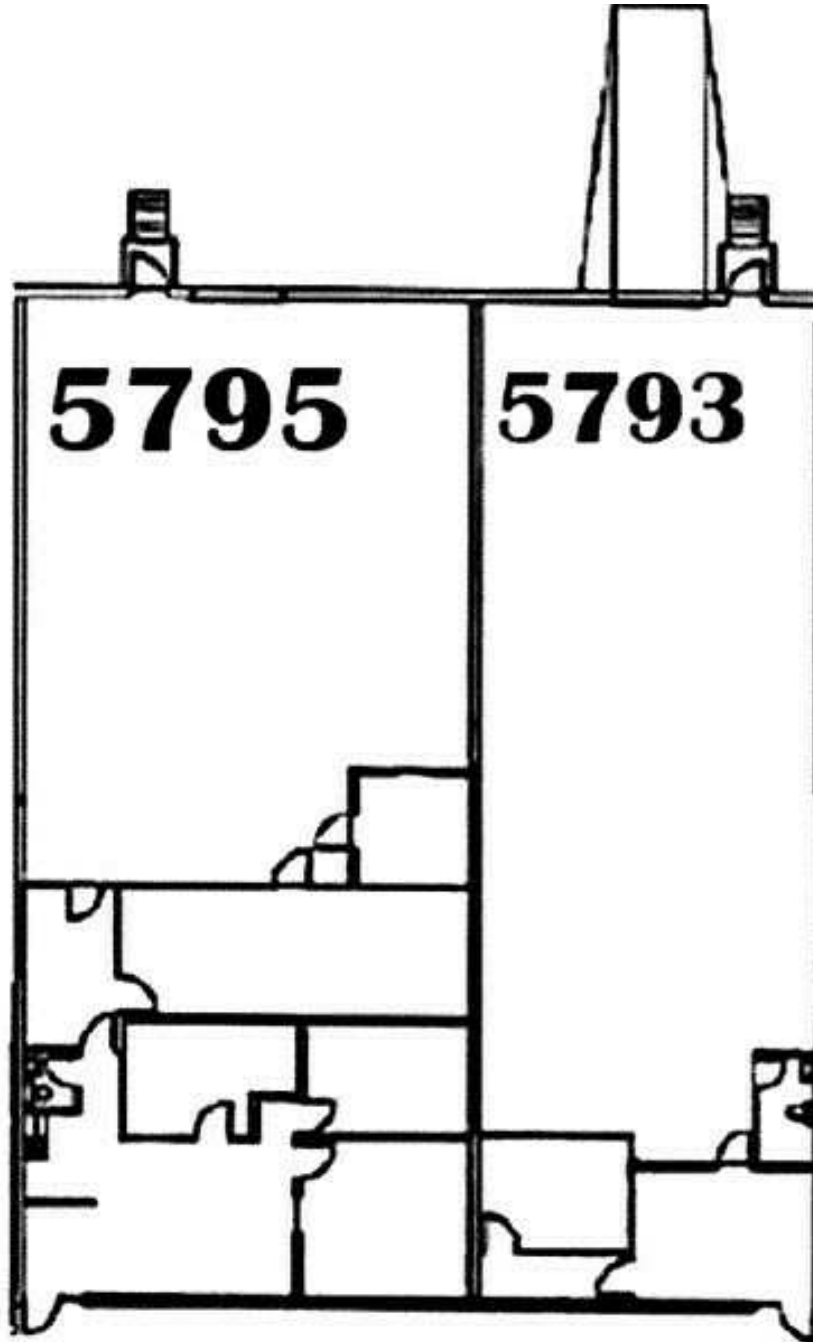

PETE ALVEAL

O: 317.454.7171 | C: 317.997.9362
palveal@premiercres.com

TOM FERGUSON

O: 317.454.7171 | C: 317.714.7171
tferguson@premiercres.com

PARK PLAZA

5705-5797 Park Plaza Ct., Indianapolis, IN 46220

FOR LEASE

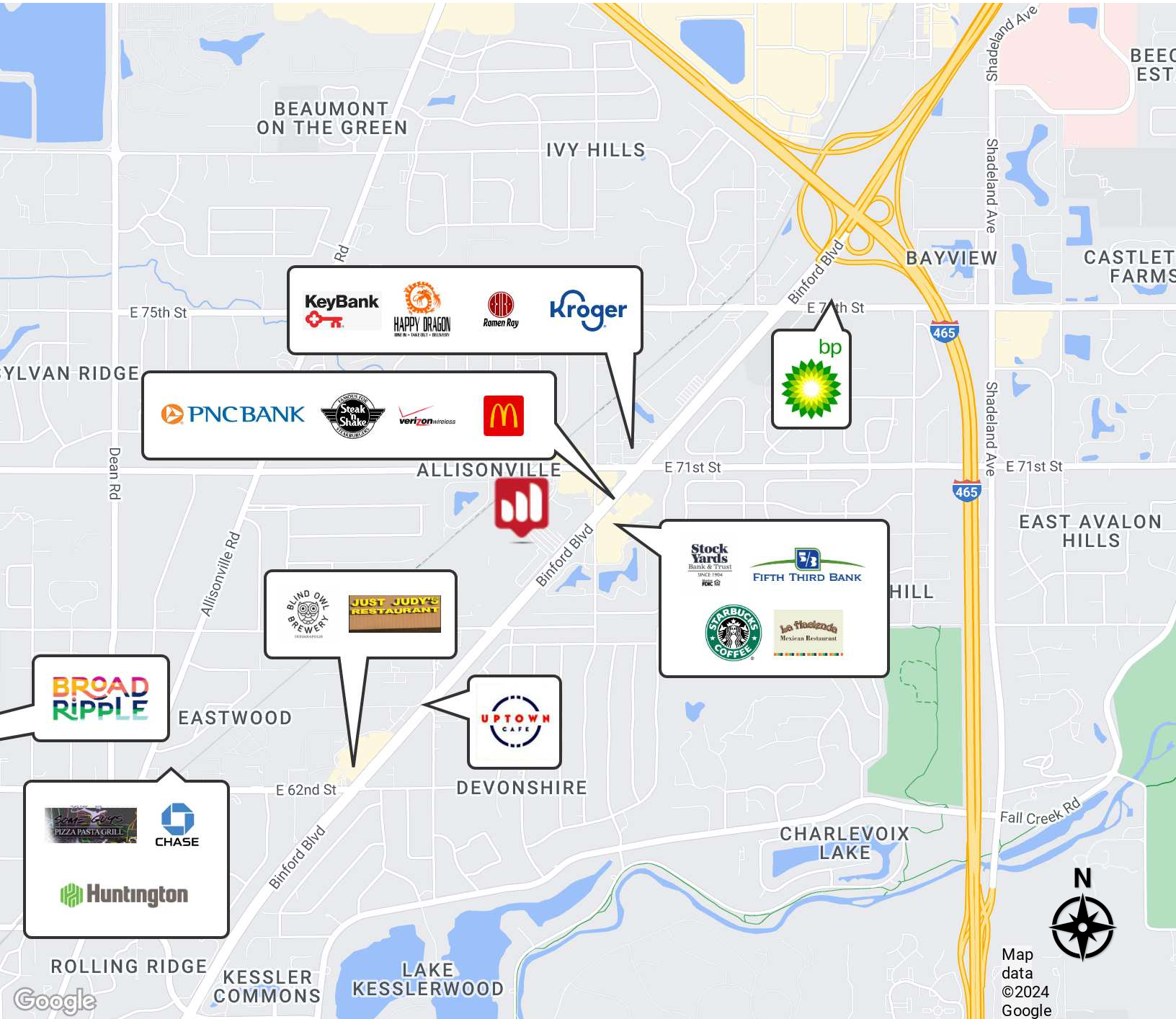

PETE ALVEAL

O: 317.454.7171 | C: 317.997.9362
palveal@premiercres.com

TOM FERGUSON

O: 317.454.7171 | C: 317.714.7171
tferguson@premiercres.com

PARK PLAZA

FOR LEASE

5705-5797 Park Plaza Ct., Indianapolis, IN 46220



POPULATION	0.5 MILES	1 MILE	1.5 MILES
Total Population	1,614	6,602	14,539
Average Age	40	40	40
Average Age (Male)	0	0	0
Average Age (Female)	0	0	0

HOUSEHOLDS & INCOME	0.5 MILES	1 MILE	1.5 MILES
Total Households	653	2,600	5,868
# of Persons per HH	2.5	2.5	2.5
Average HH Income	\$134,543	\$140,984	\$137,812
Average House Value	\$405,795	\$408,608	\$420,103

* Demographic data derived from 2020 ACS - US Census

PETE ALVEAL

O: 317.454.7171 | C: 317.997.9362
palveal@premiercres.com

TOM FERGUSON

O: 317.454.7171 | C: 317.714.7171
tferguson@premiercres.com