

EASEMENT RECORDED IN VOLUME 554, PAGE 502, DEED RECORDS, TRAVIS COUNTY, TEXAS. SAID EASEMENT BEING FURTHER AFFECTED BY THOSE INSTRUMENTS RECORDED IN VOLUME 661, PAGE 565 AND VOLUME 676, PAGE 298, DEED RECORDS, TRAVIS COUNTY, TEXAS. (DOES NOT AFFECT THIS TRACT)

EASEMENT RECORDED IN VOLUME 744, PAGE 532, DEED RECORDS, TRAVIS COUNTY, TEXAS. (DOES NOT AFFECT THIS TRACT)

EASEMENT RECORDED IN VOLUME 4832, PAGE 536, DEED RECORDS, TRAVIS COUNTY, TEXAS. (DOES NOT AFFECT THIS TRACT)

BASIS OF BEARING IS THE TEXAS STATE PLANE COORINATE SYSTEM, NAD 83, CENTRAL ZONE.

- LEGEND**
- = IRON ROD FOUND
  - = IRON ROD SET
  - = CONCRETE MONUMENT
  - ⊗ = 60D NAIL FOUND
  - E- = O/H POWERLINE

CURVE TABLE					
CURVE	LENGTH	RADIUS	CHORD	BEARING	DELTA
C1	120.66'	117.57'	115.43'	N64°04'53"E	58°48'08"
C2	76.45'	634.33'	76.40'	S89°53'22"E	6°54'18"
C3	157.35'	1237.47'	157.24'	S21°16'22"W	7°17'07"

**ADDRESS:** NORTH WILD BASIN ROAD, AUSTIN, TEXAS

**LEGAL DESCRIPTION:** A 1.031 ACRE TRACT OF LAND OUT OF THE T. J. CHAMBERS SURVEY NO. 504, ABSTRACT NO. 198, AND BEING ALL OF THAT CERTAIN TRACT OF LAND CONVEYED TO PLACID DEVELOPMENT, INC., RECORDED IN DOCUMENT NO. 2018087280, OFFICIAL PUBLIC RECORDS OF TRAVIS COUNTY, TEXAS.

### CERTIFICATION

THE UNDERSIGNED DOES HEREBY CERTIFY TO THE PARTIES LISTED BELOW THAT THIS PLAT CORRECTLY REPRESENTS A SURVEY MADE UPON THE GROUND OF THE PROPERTY SHOWN HEREON, AND THAT THERE ARE NO ENCROACHMENTS OF VISIBLE IMPROVEMENTS, EXCEPT AS SHOWN HEREON, AND THAT THIS PROPERTY HAS ACCESS TO A PUBLIC ROADWAY, EXCEPT AS SHOWN HEREON.

**BUYER:** N/A  
**TITLE CO:** INDEPENDENCE TITLE COMPANY  
**G.F.#:** 1930506-COM

**LENDER:** N/A

**PLAN No.:** 2019-0952

**SURVEY DATE:** AUGUST 29, 2019

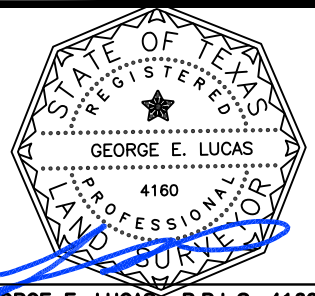

GEORGE E. LUCAS R.P.L.S. 4160