

6%

Co-operating
Broker Fee*

RenCorpRealty^{AD}

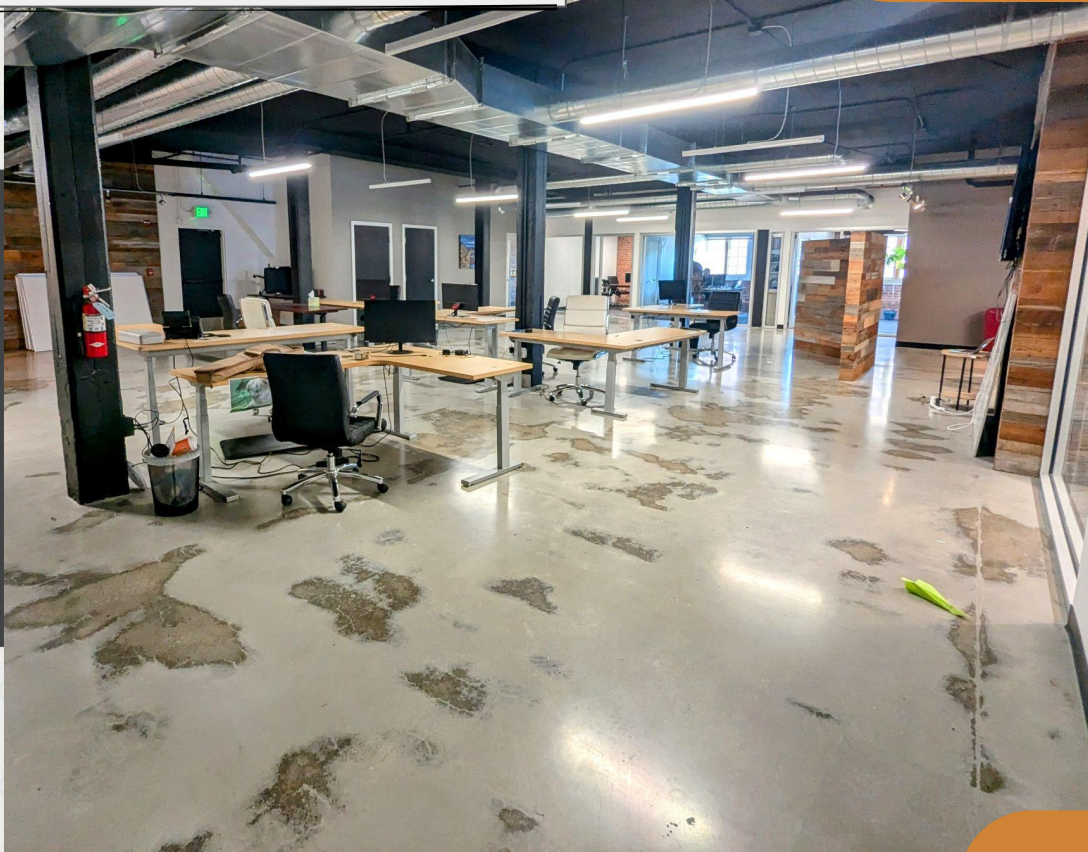

Centrally
Located

Renovated

Open
Layout



FREE
Parking

FREE PARKING
NOW LEASING

RENTAL RATES

\$14 RSF (\$5,993/mo)
Full Service (Less Janitorial)

SPACE AVAILABLE

5,137 RSF

THE HISTORIC HOLLEY MASON

157 S Howard St, Suite 605, Spokane WA 99201

NEIGHBORHOOD

The Holley-Mason Building is an important Spokane landmark that is beautifully executed with Renaissance-inspired brick and terra cotta details.

AMENITIES

- ✓ Secure Building
- ✓ High Speed Elevator
- ✓ Centrally Located
- ✓ Detailed Craftsmanship
- ✓ 5 Onsite Parking Spaces Included
- Additional space available at Market Rates)
- ✓ 7 Offices
- ✓ Conference Room
- ✓ Kitchen & Break Area

Information is deemed reliable but not guaranteed. Broker not responsible for changes errors or commissions. All square footages are for conveniences only. All information should be verified prior to leasing or purchasing property. *6% Co-operating Broker Fee is offered for a limited time and is based on marketed rates.

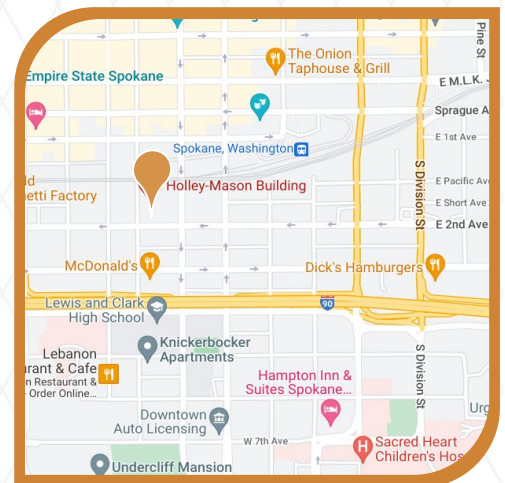

KYHRA STRAMPE
509-309-8444

JUSTIN FOLKINS
509-991-8387

CHRIS BATTEN
509-217-5508

info@rencorprealty.com
509-315-2998

FLOOR PLAN

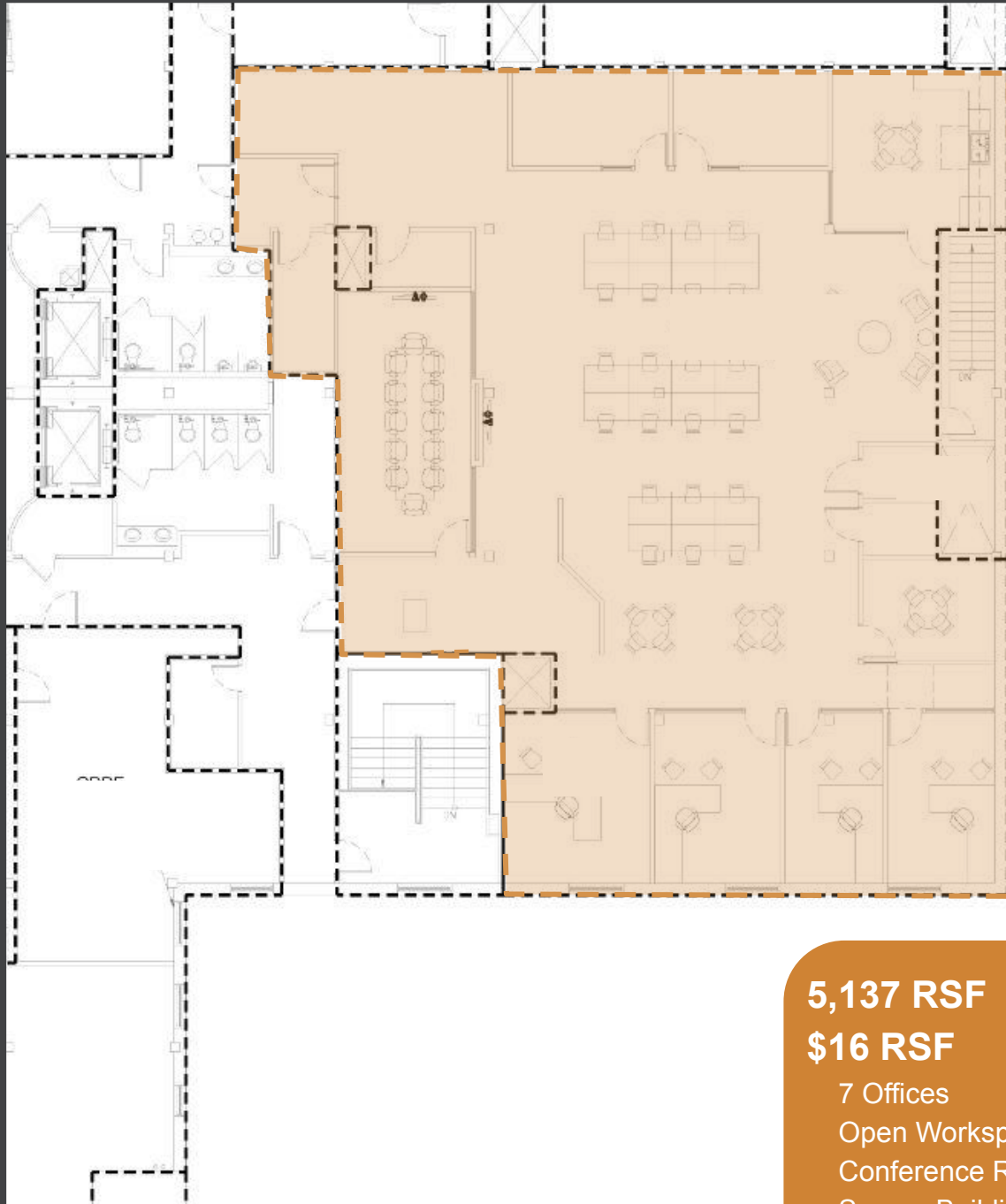

5,137 RSF

\$16 RSF

- 7 Offices
- Open Workspace
- Conference Room
- Secure Building
- Kitchen & Break area

Information is deemed reliable but not guaranteed. Broker not responsible for changes errors or commissions. All square footages are for conveniences only. All information should be verified prior to leasing or purchasing property.

ADDITIONAL PHOTOS

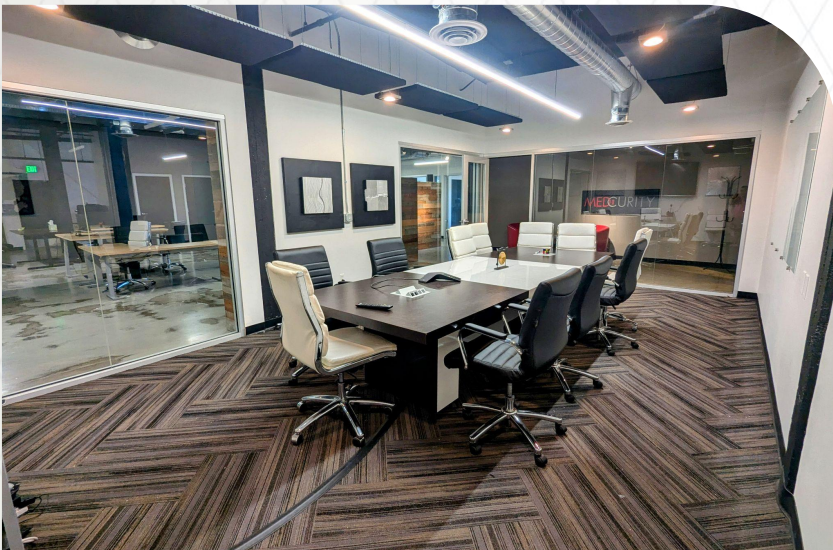

Information is deemed reliable but not guaranteed. Broker not responsible for changes errors or commissions. All square footages are for conveniences only. All information should be verified prior to leasing or purchasing property.