

3210 E Woodmen Rd, Ste 100, Colorado Springs, CO 80920

2,548 SF  
CONDO FOR SALE

# WOODMEN VIEWS OFFICE CONDO



# WOODMEN VIEWS OFFICE CONDO

3210 E Woodmen Rd, Ste 100, Colorado Springs, CO 80920



DISCLAIMER: All of the information contain in this Marketing Brochure has been gathered from reliable sources. Kinsey & Company Commercial Real Estate, LLC makes no guarantee, warranty or representation regarding the accuracy of this information. Photos in this Marketing Brochure may have been enhanced using photo editing software; all prospects are encouraged to visit the property in person to verify its current condition. Interested parties are responsible to independently verify the information contained within this Marketing Brochure.



**KINSEY & COMPANY**  
COMMERCIAL REAL ESTATE

**Jason F. Kinsey**  
Managing Principal  
720-280-5757  
Jason@KinseyCRE.com

**Brady Kinsey**  
Principal  
303-847-1295  
Brady@KinseyCRE.com



# WOODMEN VIEWS OFFICE CONDO

Colorado Springs, CO 80920

## UNIT 100 - FLOOR PLAN

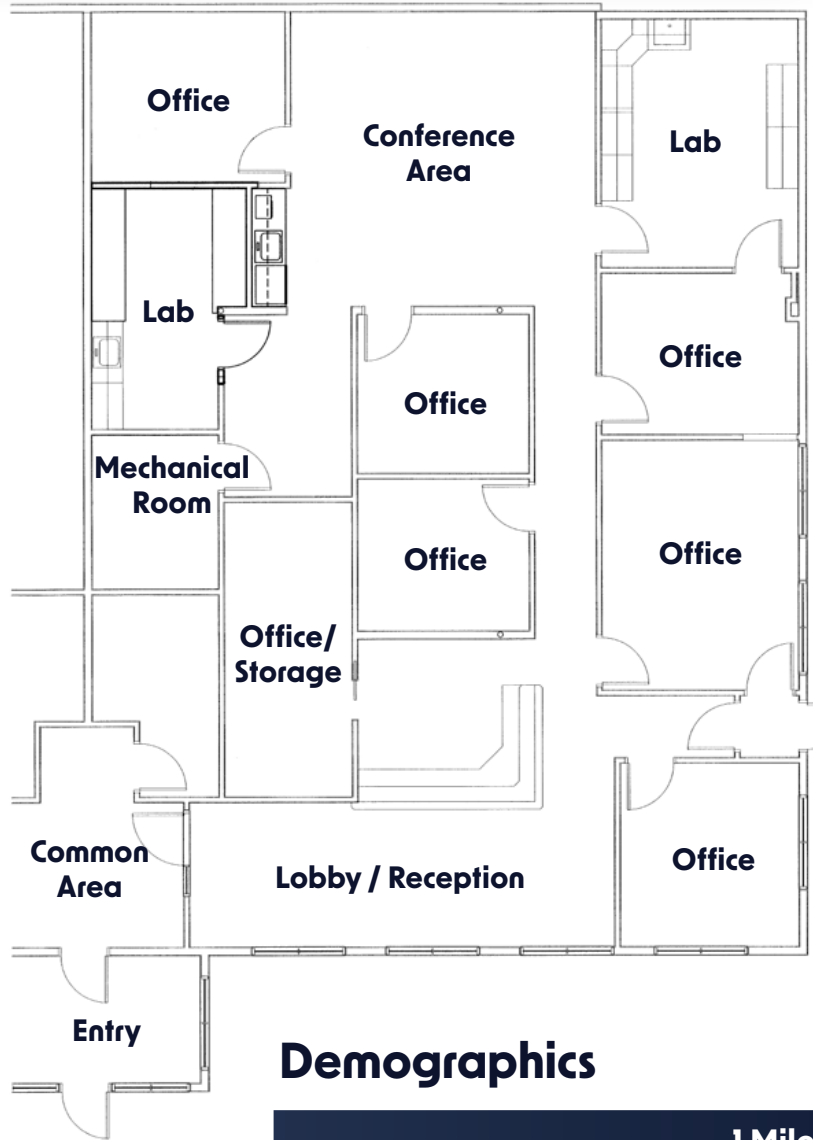

### Demographics

	1 Mile	3 Miles	5 Miles
<b>Population</b>	14,486	108,302	235,931
<b>Average Household Income</b>	\$84,617	\$112,241	\$110,156
<b>Daytime Population</b>	4,670	57,714	106,528



### Availability Information

Condo SF: 2,548 SF  
Pricing: \$830,000

### Highlights

- Built out office condo with:
  - Six (6) existing offices
  - Reception / lobby
  - Two (2) labs
  - Kitchenette
  - Conference area
- Beautiful views of Pikes Peak
- Owner / user opportunity with ability to continue to rent to short term individual office Tenants
- Well maintained office park with established Owners Association
- Conveniently located off Woodmen Rd one of the main thoroughfares in Colorado Springs

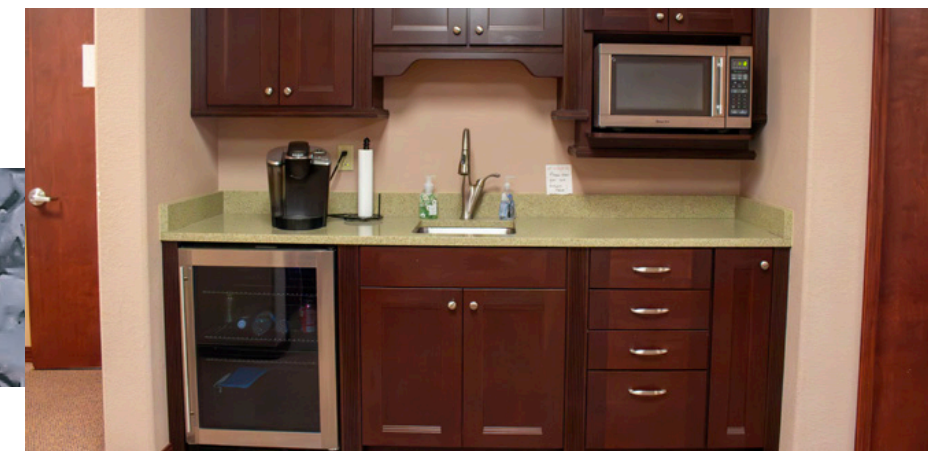

**Jason F. Kinsey**  
Managing Principal  
720-280-5757  
Jason@KinseyCRE.com

**Brady Kinsey**  
Principal  
303-847-1295  
Brady@KinseyCRE.com