

10496 Katy Fwy

4,932 RSF | Medical Office Sublease



Premises: 4,932 RSF

Availability: June 1, 2026

Term: Available through July 31, 2028

Rental Rate: Negotiable

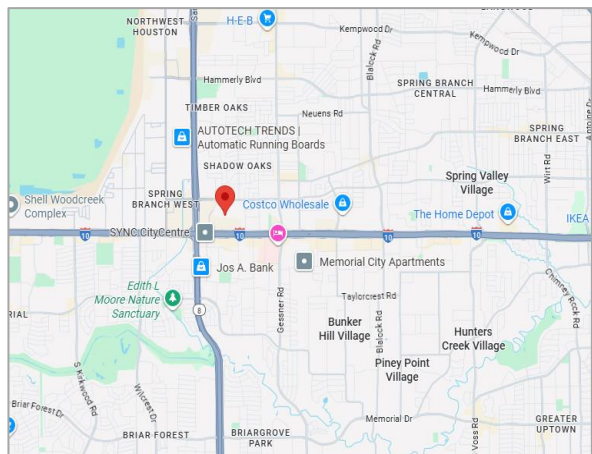

POPE
CORPORATION

Brady Wright, Vice President
(281) 904-7672 | bwright@popecorp.com

10496 Katy Fwy | 4,932 RSF Available

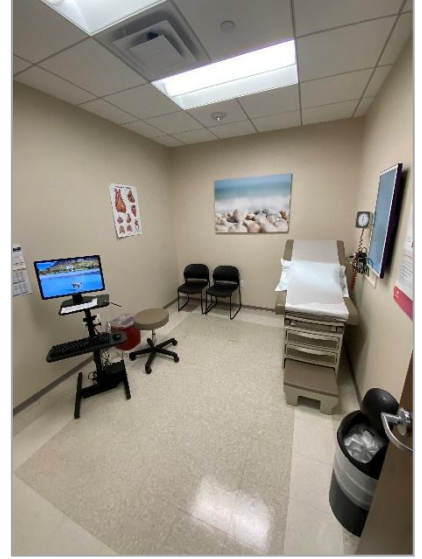

POPE
CORPORATION

Brady Wright, Vice President
(281) 904-7672 | bwright@popecorp.com

Floor Plan

4,932 SF

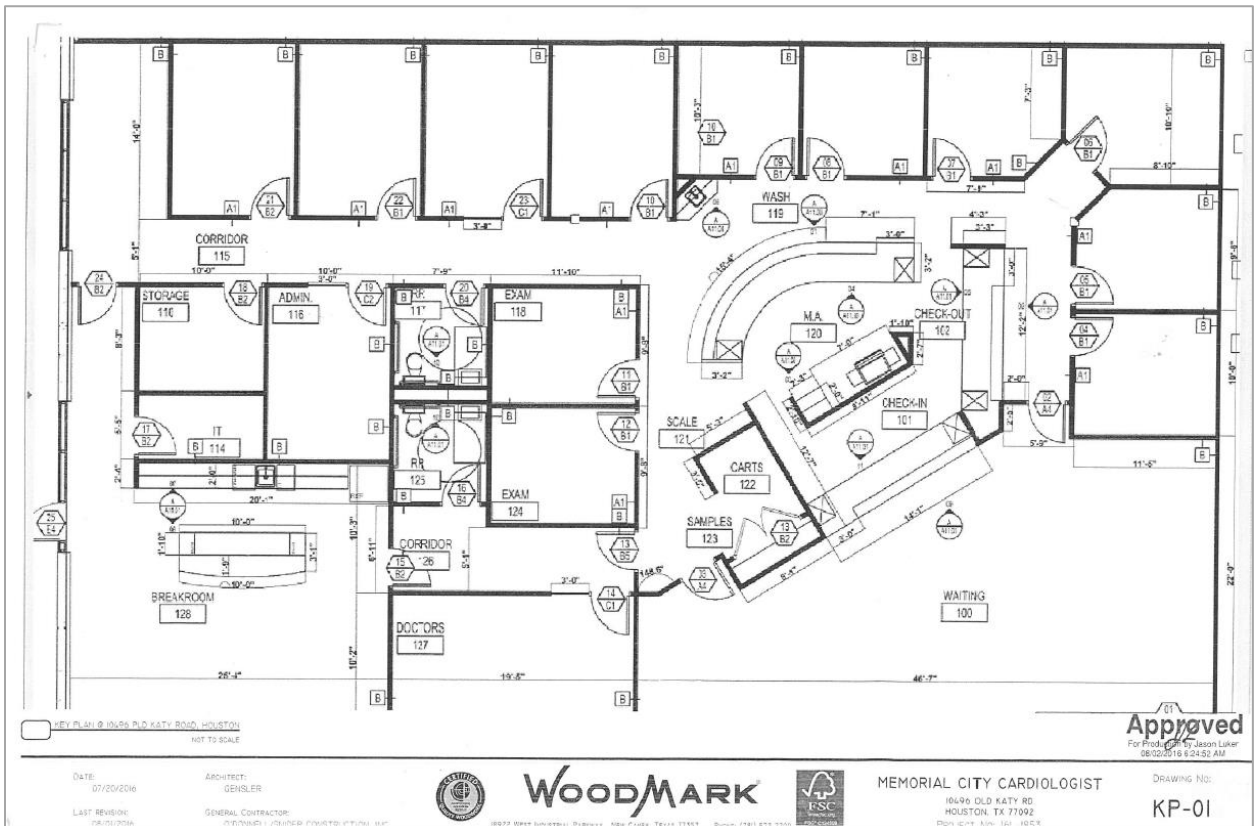

10496 Katy Fwy