



**LINCOLN PARK
RETAIL / MEDICAL SPACE
FOR LEASE**

1970 N. Clybourn, Chicago, IL

8,500 Square Feet

Prime location along Clybourn Corridor,
just south of Cortland with dedicated
surface parking lot.



LINCOLN PARK | CHICAGO

1970 North Clybourn Avenue



PROPERTY DETAILS



- The subject property is located on a prime block along Clybourn Avenue in Chicago's coveted Lincoln Park neighborhood.
- Clybourn Avenue is the dominant retail corridor for many national tenants and the preferred shopping destination for several north-side neighborhoods.
- Lincoln Yards, a 50+ acre redevelopment of former industrial land is immediately adjacent to the site. The site will add millions of square feet of office, residential and retail to an already vibrant corridor.
- The single story, +/- 8,500 square foot building comes with an adjacent and dedicated surface parking lot with approximately 25 spaces.
- The property is ideal for a variety of uses including grocery, restaurant, furniture, convenience, medical and other.



AREA CO-TENANTS

Arhaus, Blue Dot, Protein Bar, Petco, Protein Bar, Walter E. Smithe, Moosejaw, Jayson Home, HomeGoods, Natuzzi, Trader Joe's, Steinway, Binny's Beverage Depot

DEMOGRAPHICS

Estimated Population

.25 mi: 2,239 | .5 mi: 9,113 | 1 mi: 50,670

Daytime Population

.25 mi: 4,996 | .5 mi: 13,609 | 1 mi: 50,705

Average HH Income

.25 mi: \$194,603 | .5 mi: \$188,903 | 1 mi: \$167,356

LINCOLN PARK | CHICAGO

1970 North Clybourn Avenue

RETAIL MAP

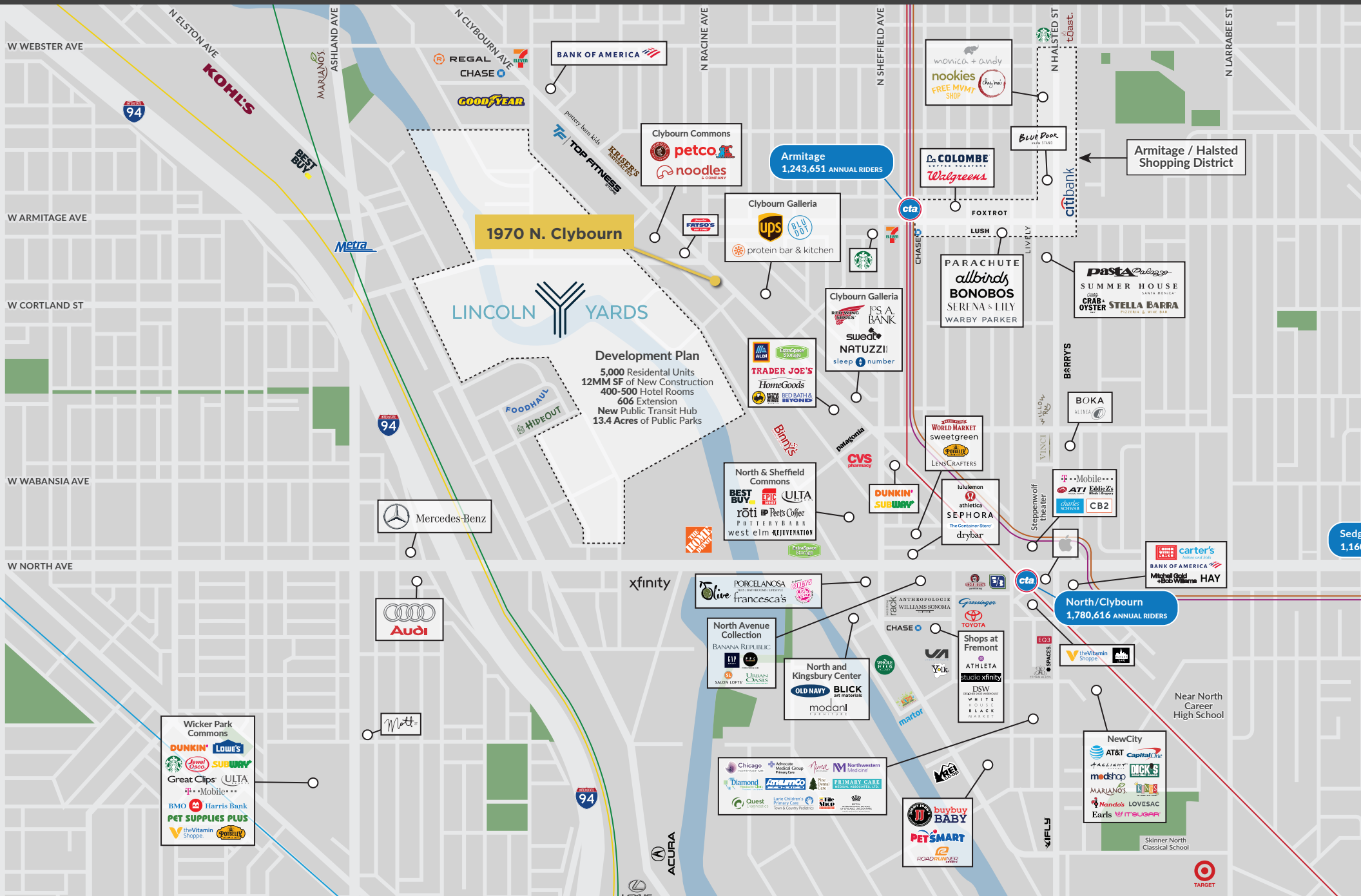



SITE PLAN

N. CLYBOURN AVENUE

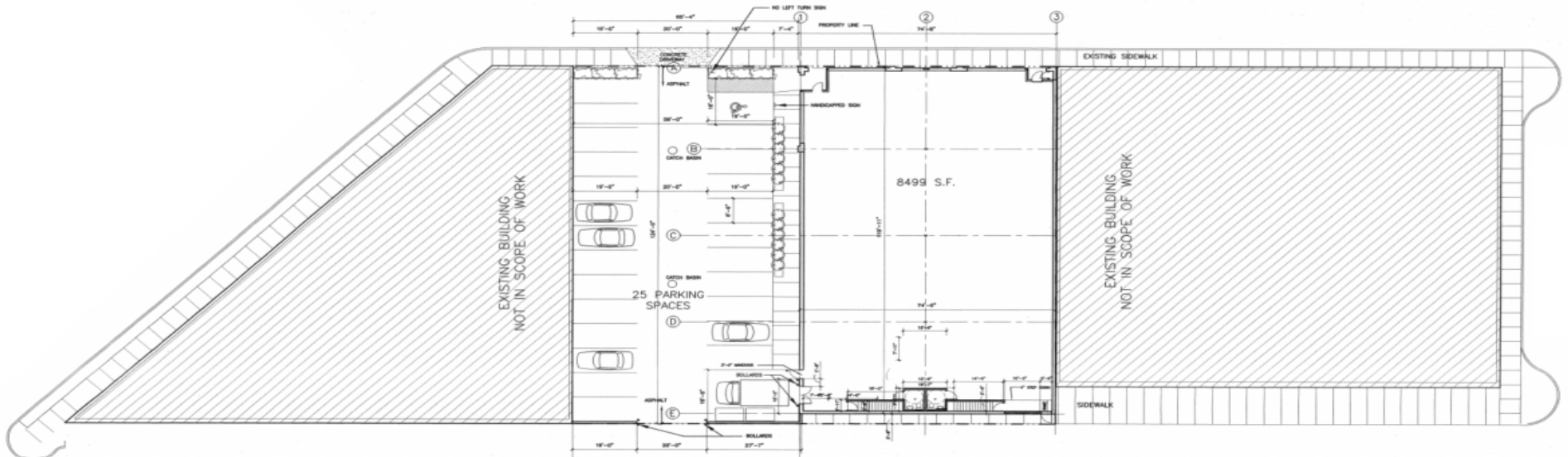



SITE PLAN

N. CLYBOURN AVENUE

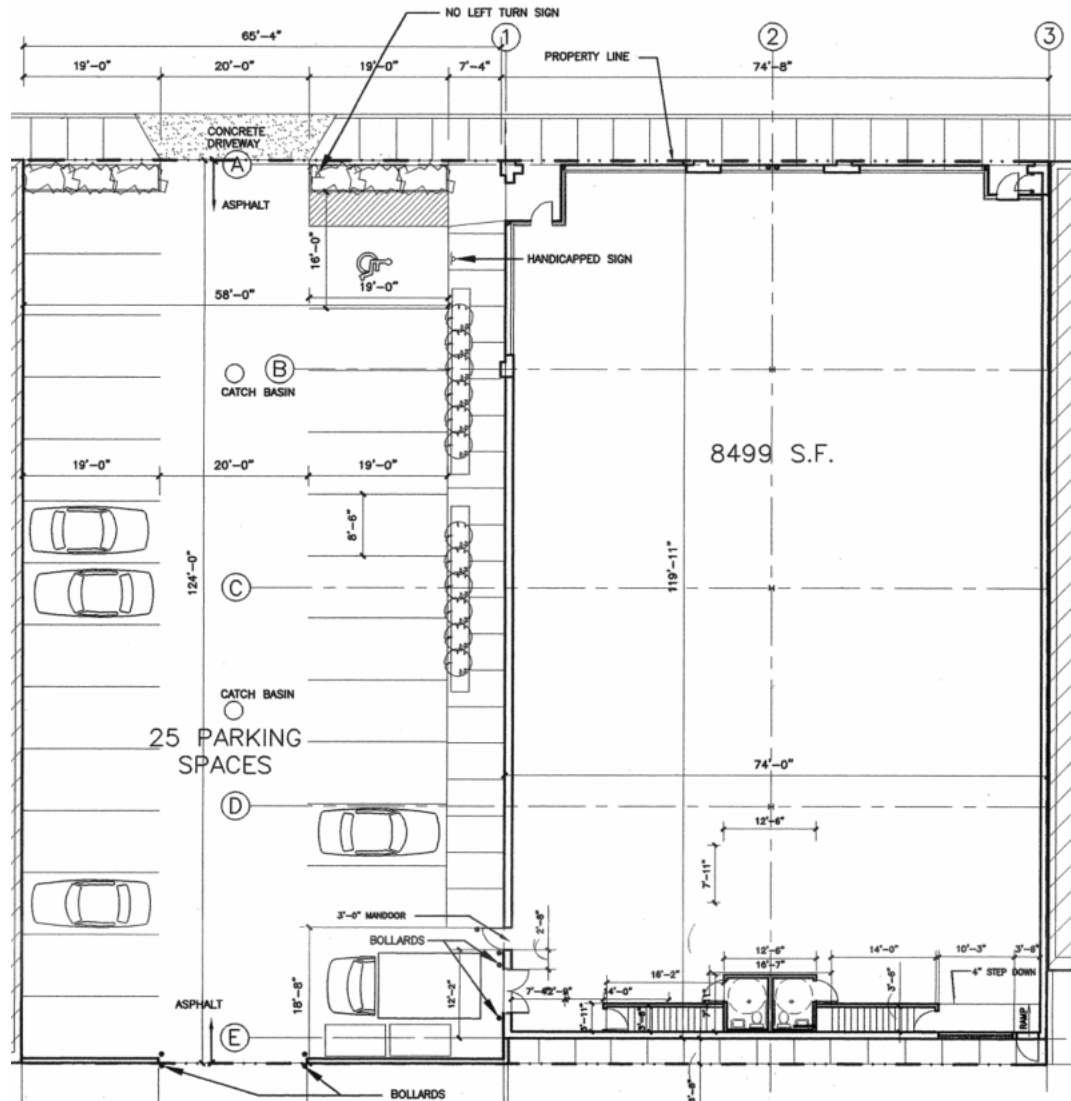



ANDREW BECKER

312.231.2600

Abecker@canvasrealestate.com

JOHN BASSI

708.822.4583

Jbassi@canvasrealestate.com

MICHAEL WEXLER

773.426.1759

Mwexler@canvasrealestate.com