

FOR LEASE

1020 Matsonford Road
West Conshohocken, PA 19428



McFadden
Real Estate Group



18,000 SF Industrial Building
Divisible from 3,800 SF

Warehouse / Showroom /
Manufacturing / Production

- Loading dock
- Two drive-in doors
- 18' clear height
- Large lot
- Building fully sprinklered
- 1/4 mi. to Schuylkill Expressway (I-76)
- Located at the exit of the Blue Route (I-476)

CONTACT:

David McFadden
610-529-9773

david@mcfaddenreg.com



No warranty or representation, express or implied, is made to the accuracy of the information contained herein, and the same is submitted subject to errors, omissions, change of price, rental or other conditions, prior sale, lease of financing, or withdrawal without notice, and of any special listing conditions imposed by our principles, no warranties or representations are made as to the conditions of the property or any hazards contained therein are only to be implied.

CONTACT:
David McFadden
610-529-9773
david@mcfaddenreg.com

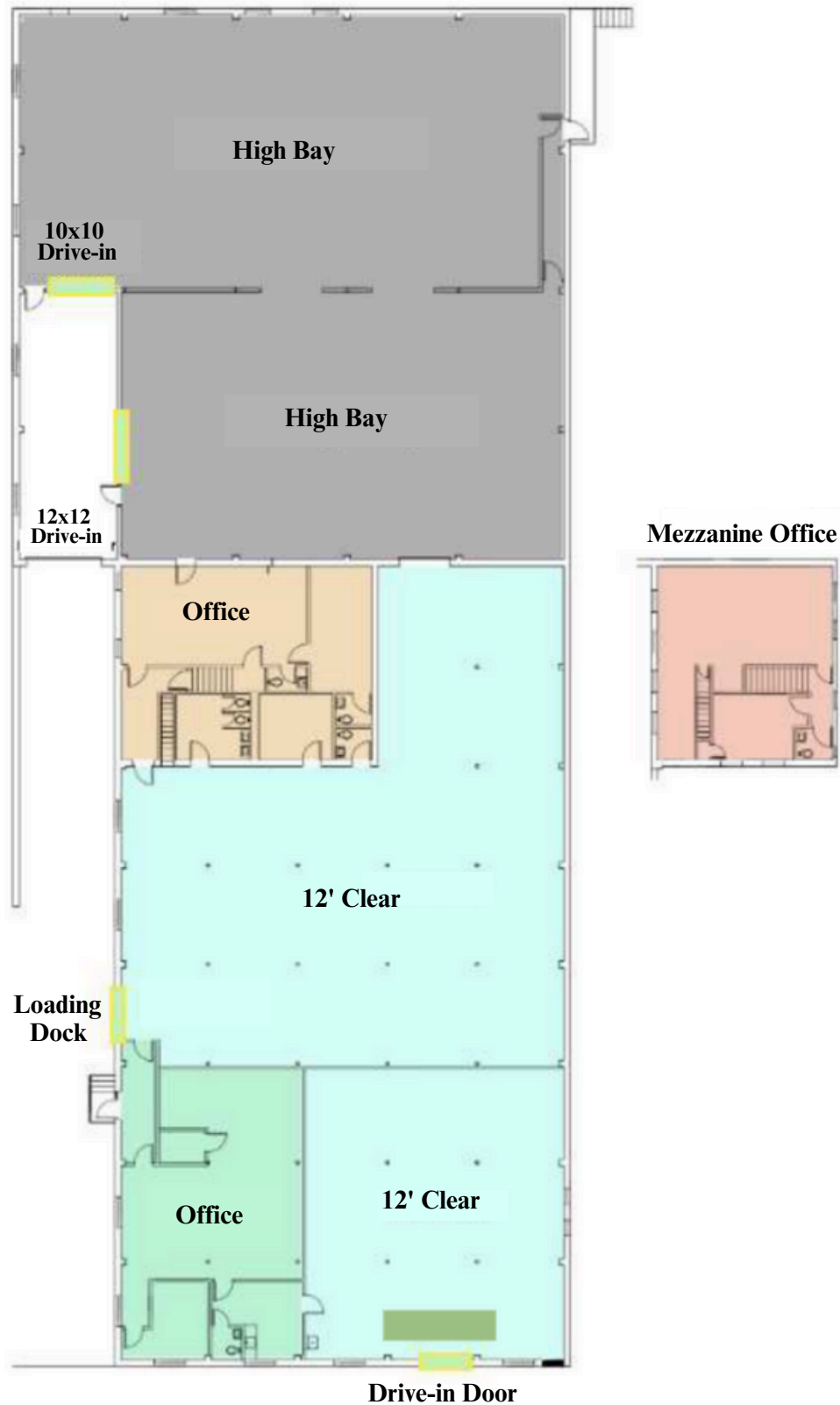

No warranty or representation, express or implied, is made to the accuracy of the information contained herein, and the same is submitted subject to errors, omissions, change of price, rental or other conditions, prior sale, lease of financing, or withdrawal without notice, and of any special listing conditions imposed by our principles, no warranties or representations are made as to the conditions of the property or any hazards contained therein are only to be implied.