

indianapolis, in

3702 N. Mitthoeffer Road | retail space available in raintree plaza



Available 900 SF, 2,000 SF, 3,6000 SF, 7,500 SF

GLA 61,718 SF

Possession Immediate

Asking Rent Upon Request

Highlights

- Grocery anchored shopping center at signalized corner
- Traffic Counts: $\pm 6,067$ ADT along N. Mitthoeffer $\pm 21,327$ ADT along E. 38th
- Dense surrounding population of 16,166 within one mile and 167,194 within three miles
- 70% of center has occupancy history greater than 8 years

For More Information:

Stephanie Zulic | Leasing Director | Licensed Real Estate Salesperson | stephanie@malachitegroup.com | T 516 877 1677

malachitegroup.com

Site Plan

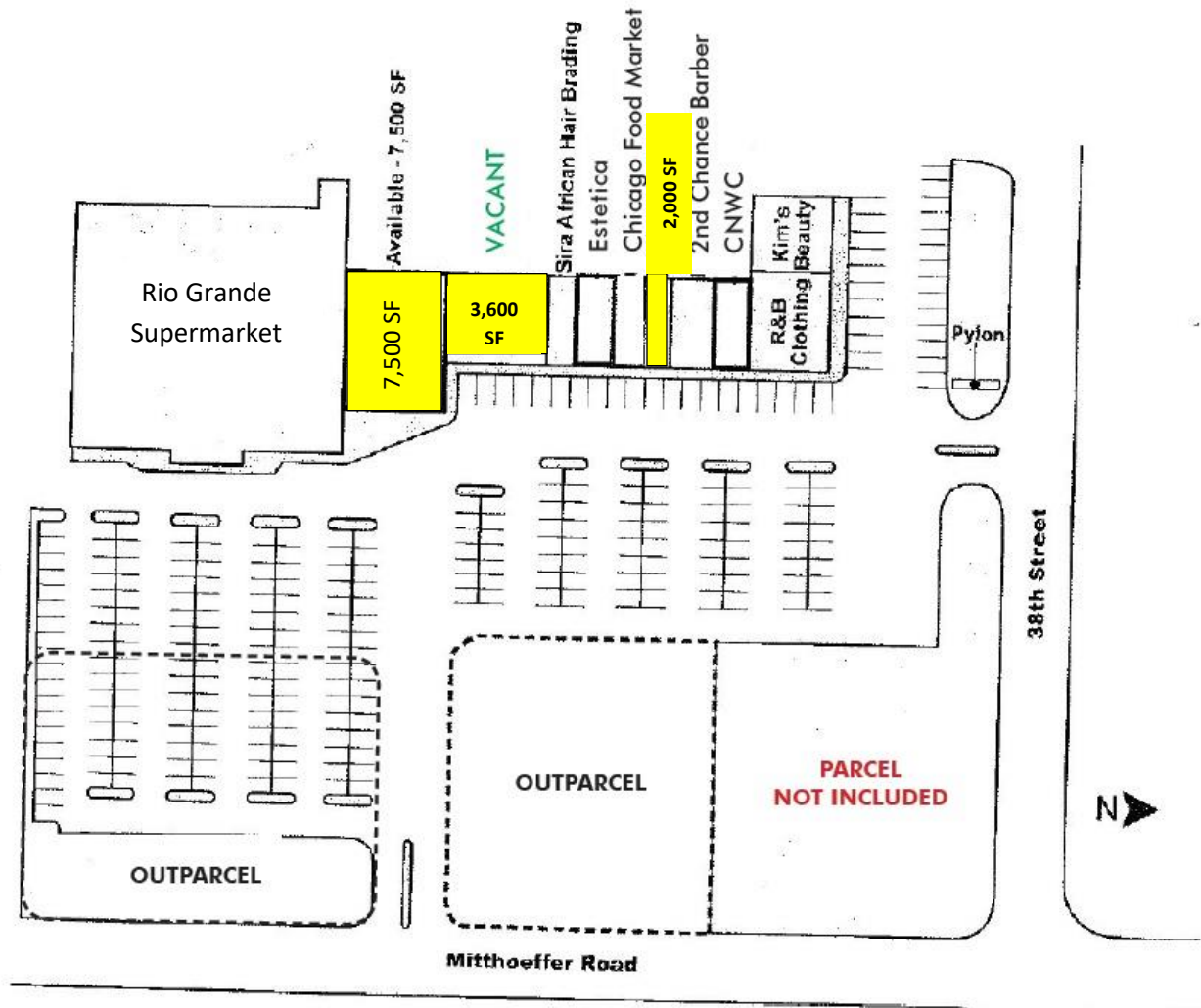

For More Information:

Stephanie Zulic | Leasing Director | Licensed Real Estate Salesperson | stephanie@malachitegroup.com | T 516 877 1677

malachitegroup.com

Aerial



For More Information:

Stephanie Zulic | Leasing Director | Licensed Real Estate Salesperson | stephanie@malachitegroup.com | T 516 877 1677

malachitegroup.com