

OPPORTUNITY KNOCKS



5950 Hazeltine National Dr., Orlando, FL 32822



CITADEL INTERNATIONAL III Class A Office Space

Convenience within 1 mile

- Restaurants
- Hotels
- Apartments



Jeff Patterson, Senior Vice President, Market Leader
 m: 407.948.1425 | o: 407.634.2814
 e: jpatterson@equity.net



Commercial Real Estate Solutions®

201 S. Orange Ave. Ste. 675, Orlando, FL 32801

CITADEL INTERNATIONAL III

Class A | 6-story | 139,042 ± RSF | Lee Vista | Parking: 4/1,000 Full Service

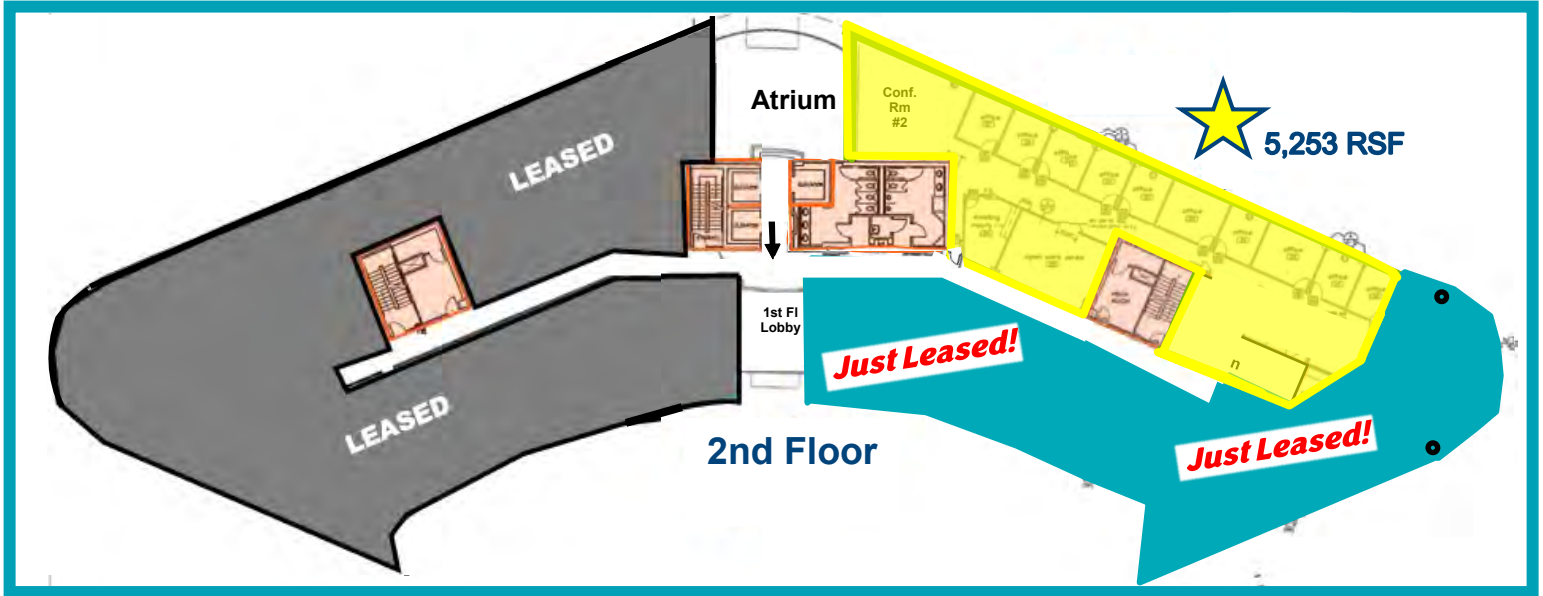

Jeff Patterson, Senior Vice President, Market Leader
m: 407.948.1425 | o: 407.634.2814
e: jpatterson@equity.net



Commercial Real Estate Solutions®

201 S. Orange Ave. Ste. 675, Orlando, FL 32801

CITADEL INTERNATIONAL III

Class A | 6-story | 139,042 ± RSF | Lee Vista | Parking: 4/1,000 Full Service

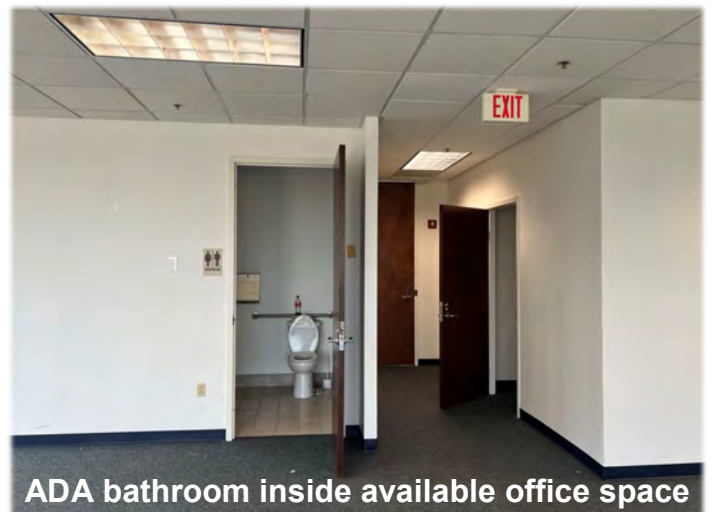
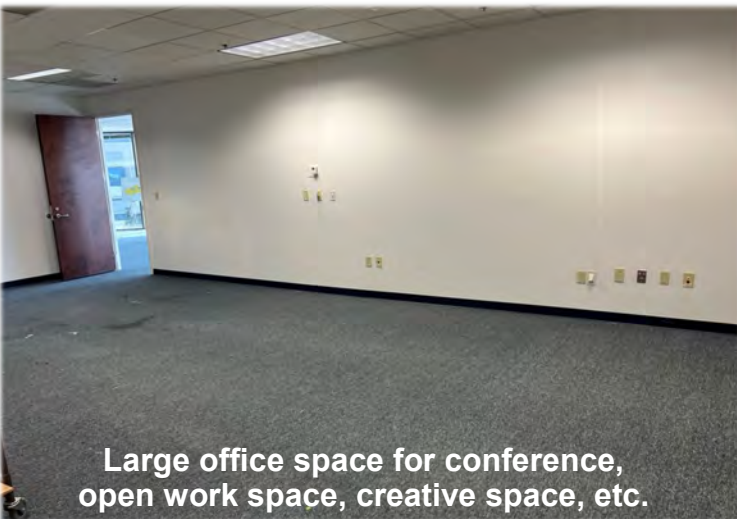
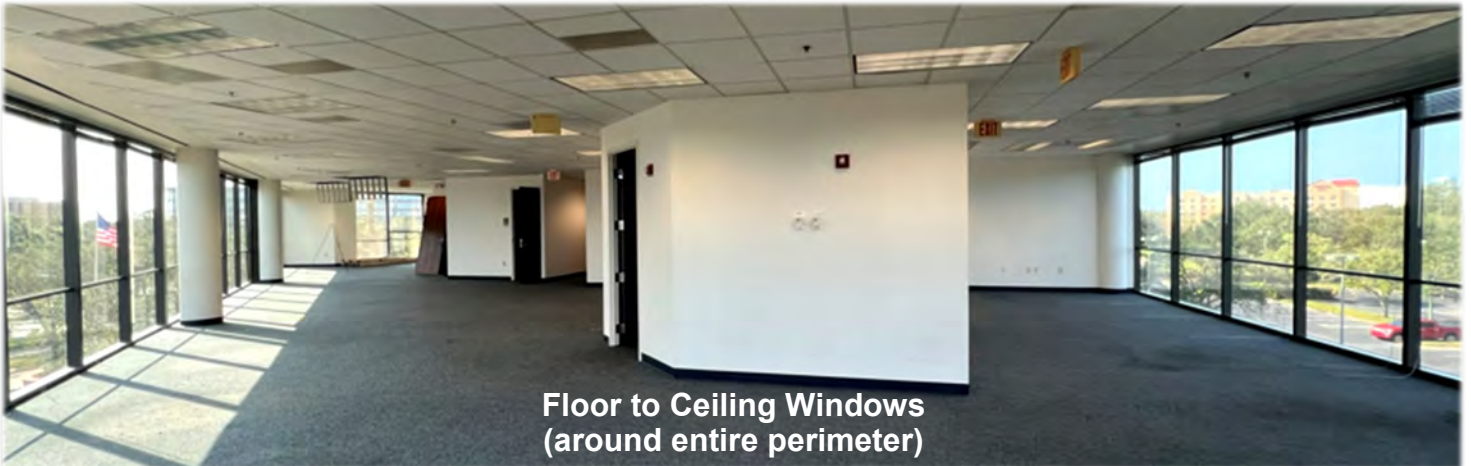
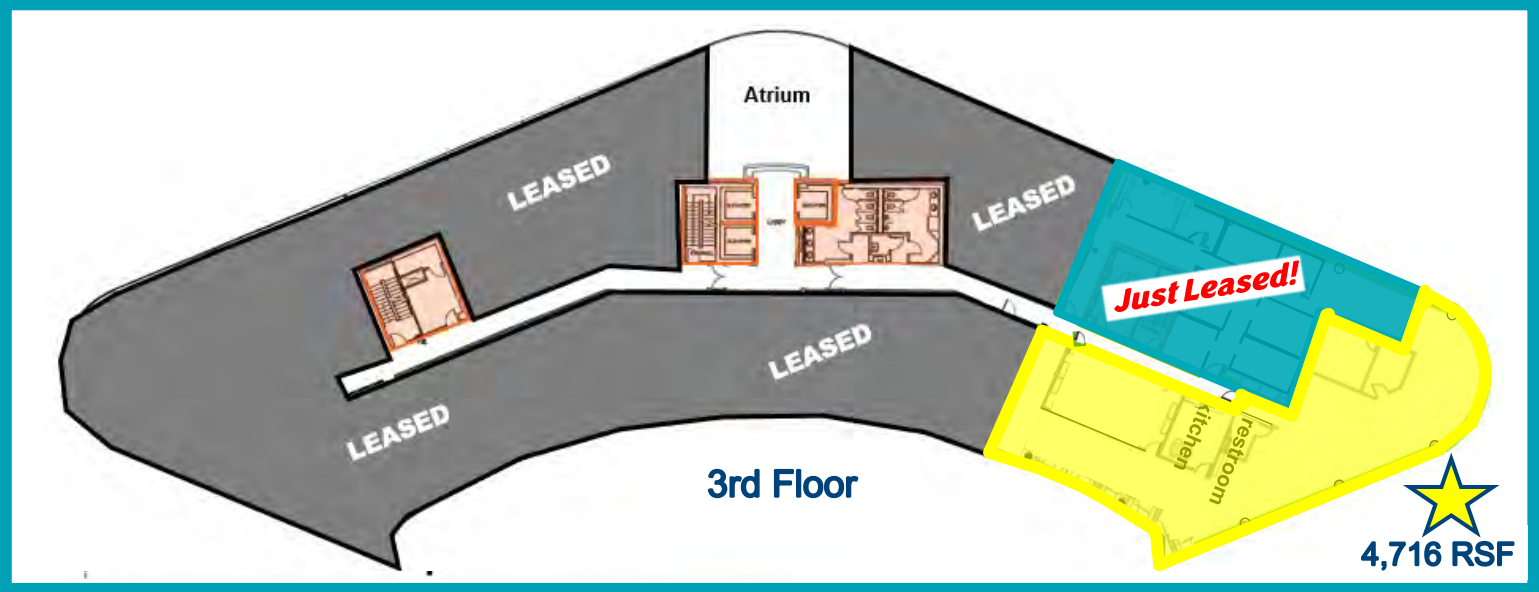

Jeff Patterson, Senior Vice President, Market Leader
m: 407.948.1425 | o: 407.634.2814
e: jpatterson@equity.net

equity

Commercial Real Estate Solutions®

201 S. Orange Ave. Ste. 675, Orlando, FL 32801

CITADEL INTERNATIONAL III

Class A | 6-story | 139,042 ± RSF | Lee Vista | Parking: 4/1,000 Full Service

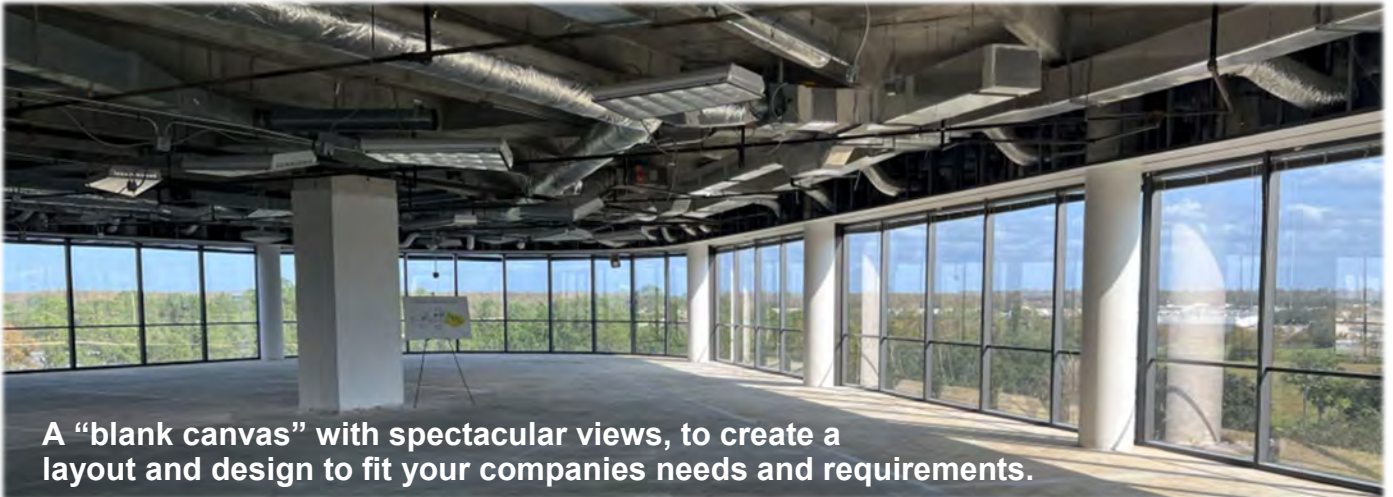
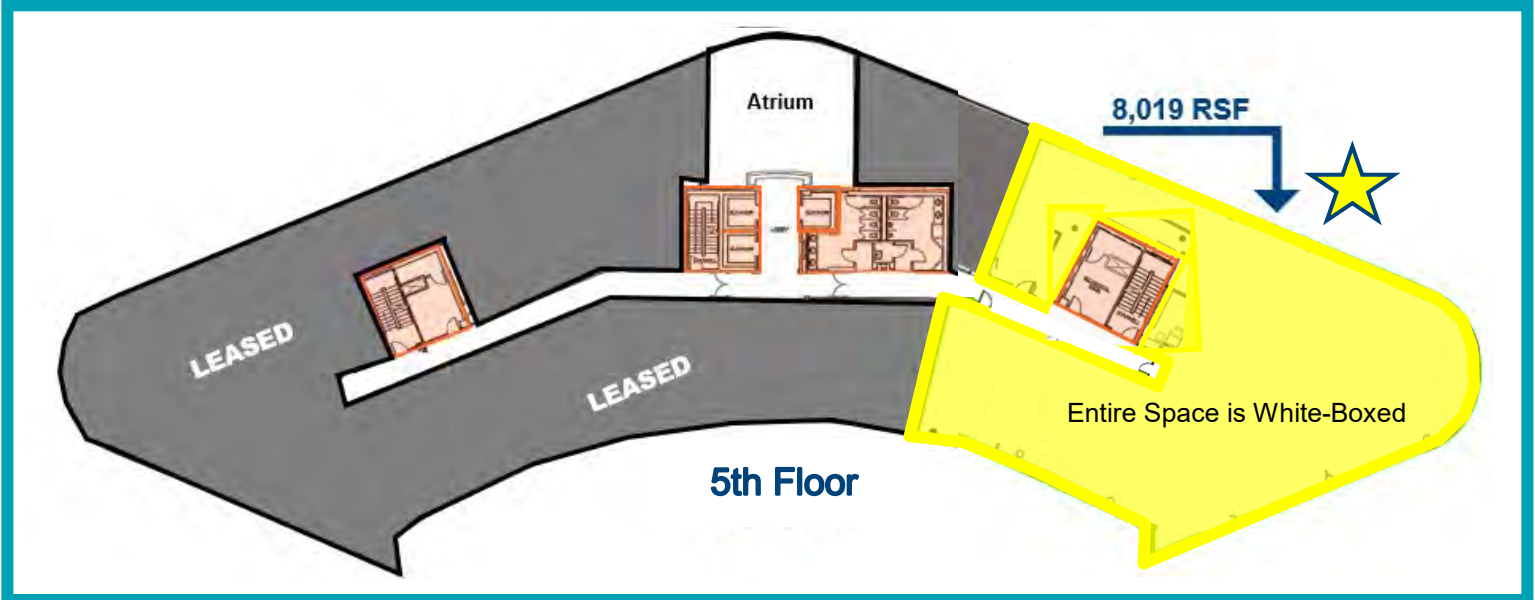

Jeff Patterson, Senior Vice President, Market Leader
m: 407.948.1425 | o: 407.634.2814
e: jpatterson@equity.net



Commercial Real Estate Solutions®

201 S. Orange Ave. Ste. 675, Orlando, FL 32801