

# Attractive, Professional Office Suite For Lease



## 116 South River Road Building E Bedford NH

### Property Features

- 1,089 ± SF
- Performance Zoning
- Excellent access to Rts 101, I-93 and I-293 at Kilton Road exit
- Located in a high profile park with great visibility
- Property is broker owned

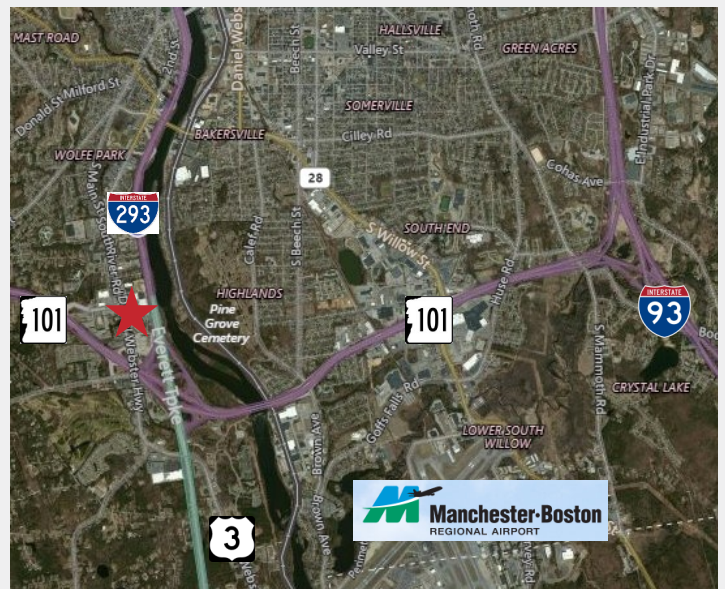

**Karl Norwood**

603 496 1532

[karl@nainorwoodgroup.com](mailto:karl@nainorwoodgroup.com)

**Louise Norwood**

603 657 1932

[louise@nainorwoodgroup.com](mailto:louise@nainorwoodgroup.com)

[Click here for more information.](#)

# NAI Norwood Group

The information contained herein has been given to us by the owner of the property or other sources we deem reliable, we have no reason to doubt its accuracy, but we do not guarantee it. All information should be verified prior to purchase or lease.

116 South River Road  
Bedford NH 03110  
+1 603 668 7000  
[nainorwoodgroup.com](http://nainorwoodgroup.com)

116 South River Road  
Bedford NH

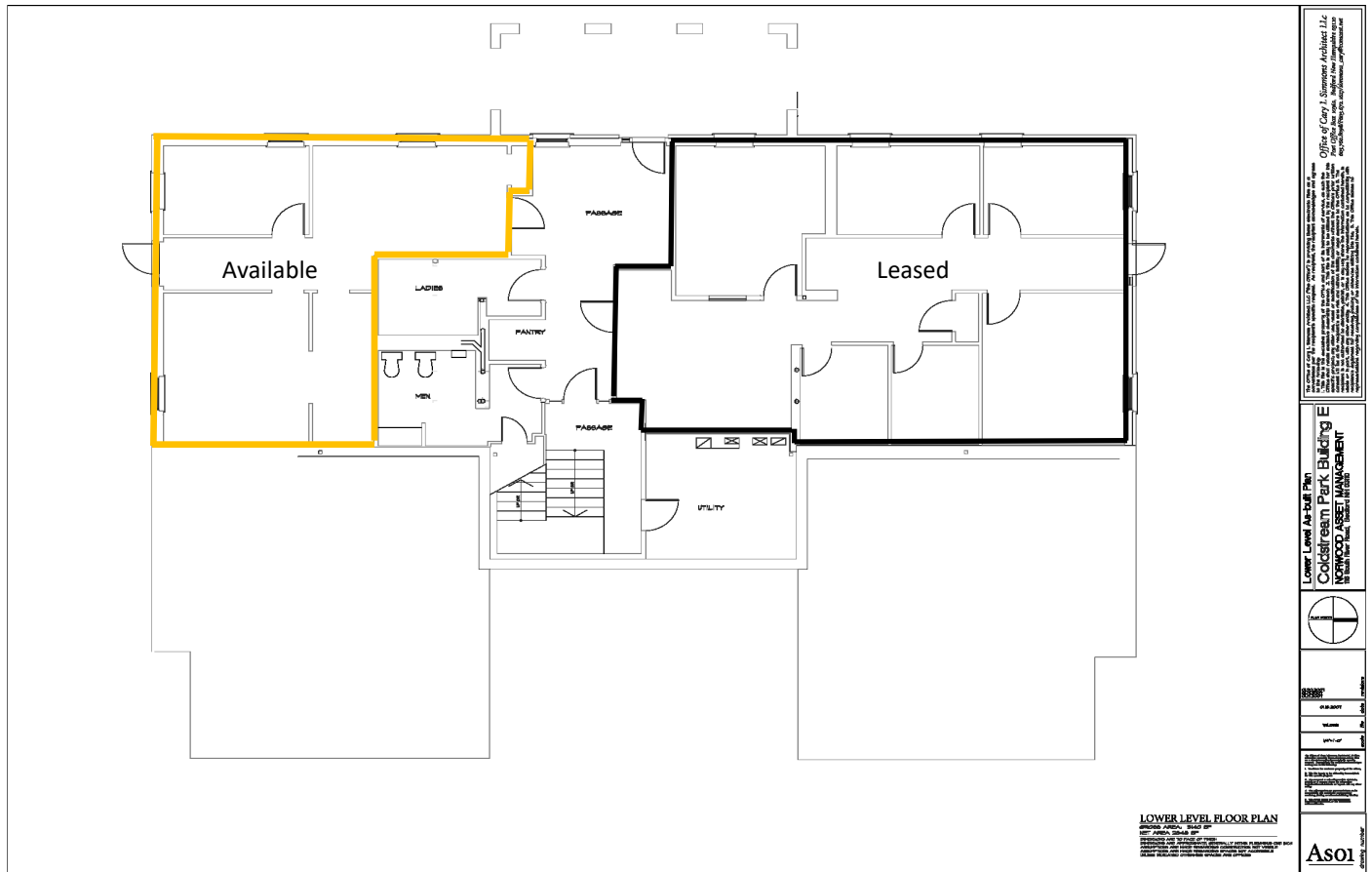

Attractive, professional office suite with a furnished reception area for guests and patrons, overlooking picturesque Bowman Brook right off South River Road with ease of accessibility to all major highways. Situated at Coldstream Park on six acres of groomed grounds with buildings reflecting a Williamsburg style environment. This compact office suite comprised of 1,089 SF has a great window line and ready for immediate occupancy.

**Lease Rate: \$16.00 PSF  
Mod Gross**