



#### Lease Rate:

# \$20.00/SF

Net Utilities and Janitorial

#### CONTACT

##### Mary Winter Teaster

Senior Brokerage Associate  
+1 803 401 4308  
mary.teaster@colliers.com

##### Sydney Lanham

Brokerage Associate  
+1 803 401 4284  
sydney.lanham@colliers.com



#### Colliers | South Carolina

1301 Gervais Street, Ste 600  
Columbia, SC 29201  
+1 803 254 2300

#### FOR LEASE

## ± 5,670 SF Office/Medical Building Located in Cayce's Central Hub

**1105 State Street | Cayce, SC 29033**

#### Highlights

- ±5,670 SF one-story building
- Ideal for professional or medical office use
- ADA accessible
- Large fenced parking lot
- Loading door to the rear
- Walking distance to Guignard Park, multiple residential areas, retail and shopping venues and a variety of restaurants.

The property is situated near the corner of Knox Abbott Drive and State Street and is surrounded by restaurants and retail stores. It is conveniently located minutes away from the Congaree River, West Columbia's retail hub, Columbia's downtown Vista, Central Business District, the University of South Carolina and Interstate 77.

Copyright © 2025 Colliers International. Information herein has been obtained from sources deemed reliable, however its accuracy cannot be guaranteed. The user is required to conduct their own due diligence and verification.



**FOR LEASE**

Subdividable as shown

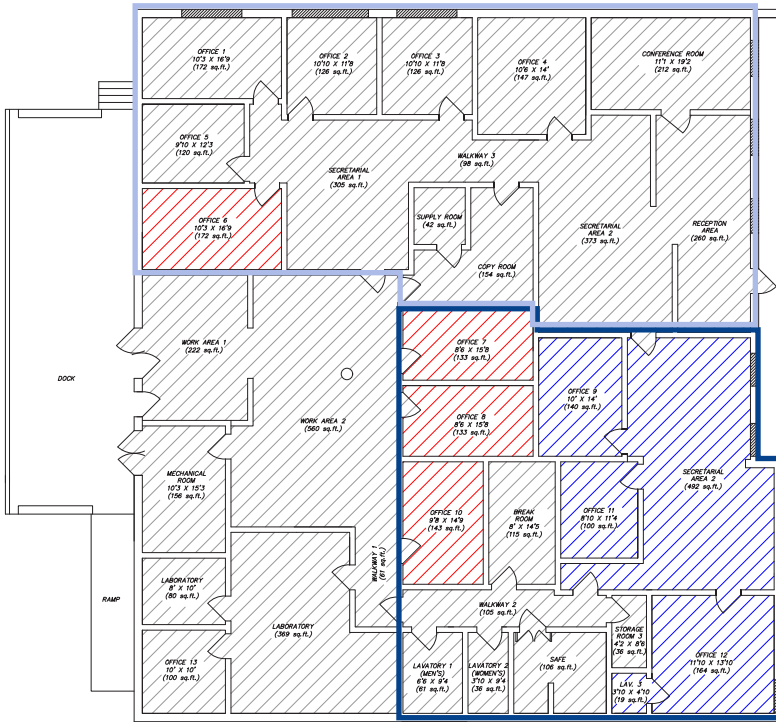

Reception area



Loading dock & parking



**CONTACT**

**Mary Winter Teaster**  
Senior Brokerage Associate  
+1 803 401 4308  
mary.teaster@colliers.com

**Sydney Lanham**  
Brokerage Associate  
+1 803 401 4284  
sydney.lanham@colliers.com

**Colliers | South Carolina**  
1301 Gervais Street, Ste 600  
Columbia, SC 29201  
+1 803 254 2300

