

For Lease  
**Tucson West**  
Up to 26,004 SF Available



## 333 E Wetmore Rd

Tucson, Arizona 85705

### Property Features

- 142,148 SF Class “A” Energy Star rated office
- Ample Parking, 5.27:1,000 ratio
- Fenced courtyard area
- Interior common lobby
- Locker rooms & showers
- Located on “The Loop” running/biking Trail

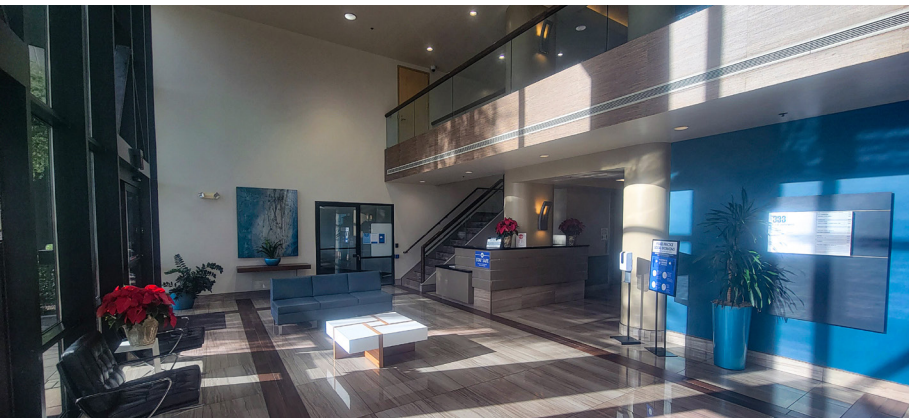

Exclusive Contact:

**Phil Skillings**

+1 520 977 6369

phil.skillings@naihorizon.com

**NAI**Horizon

NO WARRANTY OR REPRESENTATION, EXPRESS OR IMPLIED, IS MADE AS TO THE ACCURACY OF THE INFORMATION CONTAINED HEREIN, AND THE SAME IS SUBMITTED SUBJECT TO ERRORS, OMISSIONS, CHANGE OF PRICE, RENTAL OR OTHER CONDITIONS. PRIOR SALE, LEASE OR FINANCING, OR WITHDRAWAL WITHOUT NOTICE, AND OF ANY SPECIAL LISTING CONDITIONS IMPOSED BY OUR PRINCIPALS NO WARRANTIES OR REPRESENTATIONS ARE MADE AS TO THE CONDITION OF THE PROPERTY OR ANY HAZARDS CONTAINED THEREIN ARE ANY TO BE IMPLIED.

2900 N Swan Rd, Suite 200  
Tucson, AZ 85712  
+1 520 326 2200  
naihorizon.com

# Available Spaces

For Lease  
**Tucson West**  
 Up to 26,004 SF Available



Suite	Size (SF)	Lease Type	Lease Rate
Suite 100	5,765 SF	Full Service	Contact Agent For Pricing
Suite 140	2,557 SF	Full Service	Contact Agent For Pricing
Suite 165	1,311 SF	Full Service	Contact Agent For Pricing
Suite 240	2,230 SF	Full Service	Contact Agent For Pricing
Suite 280	7,955 SF	Full Service	Contact Agent For Pricing
Suite 300	8,775 SF	Full Service	Contact Agent For Pricing
Suite 400	7,004 SF	Full Service	Contact Agent For Pricing
Suite 420	2,286 SF	Full Service	Contact Agent For Pricing
Suite 450 [Available 11/1/24]	12,828 SF	Full Service	Contact Agent For Pricing
Suite 500, Full Floor	26,004 SF	Full Service	Contact Agent For Pricing

*\*Contact Agents for Building Plans*