

COLONNADES AT STANDLEY LAKE

9910 & 9940 WADSWORTH PKWY. | WESTMINSTER CO 80021



2,665–3,511 SF RETAIL SPACE
FOR LEASE



KINSEY & COMPANY
COMMERCIAL REAL ESTATE

Jason F. Kinsey
Managing Principal
720-280-5757
Jason@KinseyCRE.com

Brady Kinsey
Principal
303-847-1295
Brady@KinseyCRE.com

Availability

- SF Available: 2,665–3,511 SF
- Pricing: Contact Broker

Traffic Counts

- Wadsworth Parkway: 36,019 VPD
- Church Ranch Boulevard: 20,703 VPD

MPSI 2022 Estimates

Demographics

	1 Mile	3 Miles	5 Miles
Population	13,833	91,688	264,384
Average Household Income	\$123,176	\$111,198	\$108,142
Daytime Population	4,020	30,439	86,314

Source: CoStar

Highlights

- **WELCOMING NEW TENANTS:**
Colorado Movement Lab (dance studio) and Hero's Puppy For Life
- 3,511 SF space has great visibility and exposure
- Located at busy, fully signalized intersection of Church Ranch Blvd. & Wadsworth Pkwy. (56,722 VPD)
- Join area tenant's such as Lamar's Donuts, Walgreens, Arbor Dental Group, VASA Fitness, King Soopers and more





9910 & 9940 WADSWORTH PKWY. | WESTMINSTER CO 80021

Floor Plans

2,665 SF

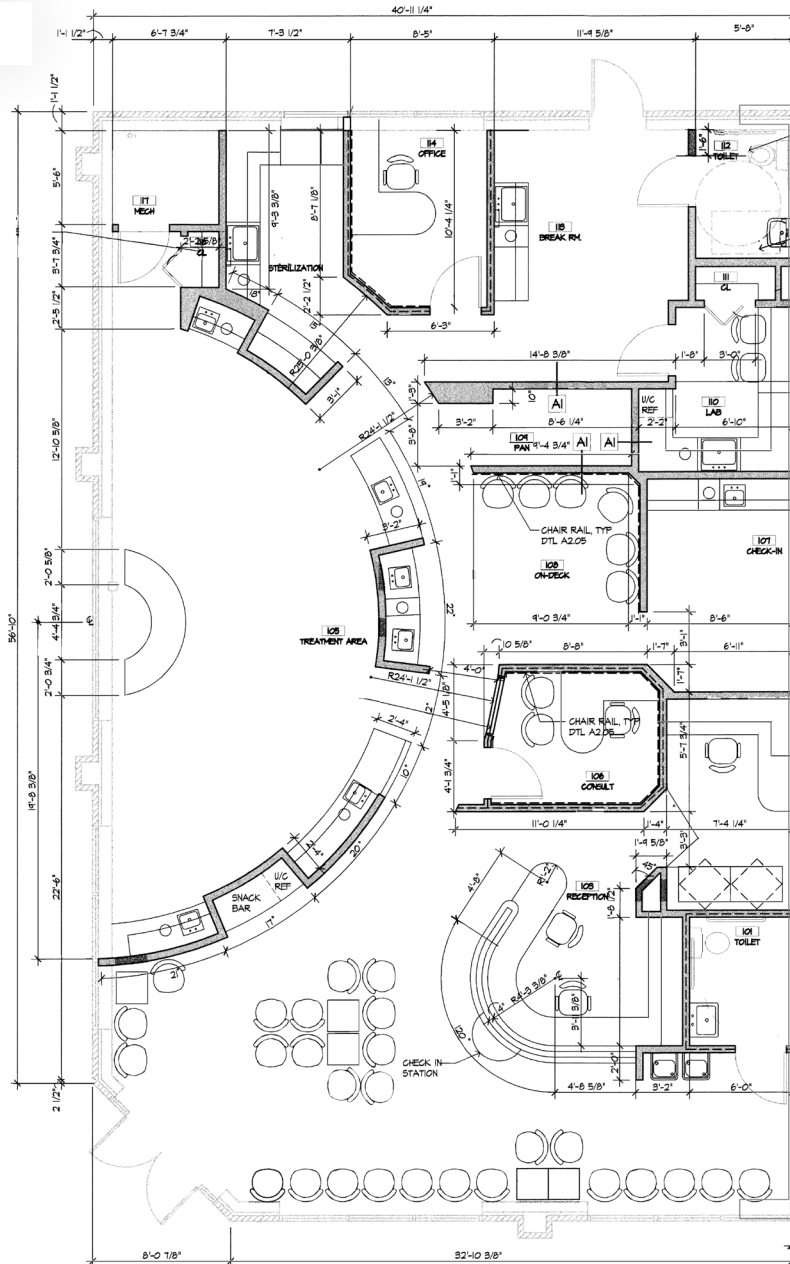

COLONNADES AT STANDLEY LAKE

9910 & 9940 WADSWORTH PKWY. | WESTMINSTER CO 80021

3,511 SF

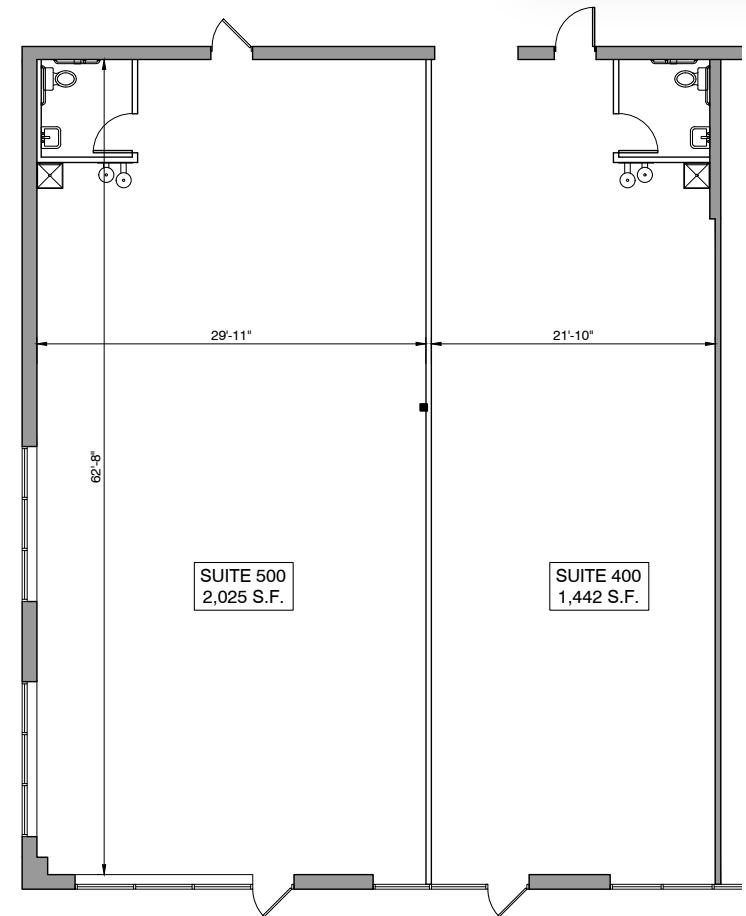

STANDLEY LAKE MARKETPLACE



Standley
Lake
High
School



Lukas
Elementary

STANDLEY SHORES



THE SHOPS AT WALNUT CREEK



CHURCH RANCH BLVD. - 20,703 VPD

COLONNADES AT STANDLEY LAKE

WADSWORTH PKWY. - 36,019 VPD



KINSEY & COMPANY
COMMERCIAL REAL ESTATE

Jason F. Kinsey
Managing Principal
720-280-5757
Jason@KinseyCRE.com

Brady Kinsey
Principal
303-847-1295
Brady@KinseyCRE.com

Disclaimer: The Interested Party acknowledges that any documents or information ("Materials") received from the Property Owner are provided solely for reference and review. The Property Owner makes no representations, expressed or implied, regarding the accuracy or completeness of these Materials. The Interested Party assumes full responsibility for evaluating all provided documents, which may include maps, schematics, and other property-related data. This includes, but is not limited to: (i) the structural integrity, condition, and features of the Property, including roofing, foundation, utilities, and landscaping; (ii) soil composition, geological factors, and groundwater conditions; (iii) the availability and adequacy of utility services; (iv) zoning, land use regulations, and development feasibility; (v) legal restrictions affecting the Property; (vi) adherence to applicable laws, codes, and regulations; (vii) potential environmental hazards on or near the premises; (viii) the quality of workmanship and materials in any existing structures; and (ix) the status of the Property's title. The Property Owner is not responsible for any conclusions drawn by the Interested Party based on these Materials. It is the sole duty of the Interested Party to conduct independent due diligence before finalizing any transaction. All documents are provided without warranty, and the Interested Party waives any claims against the Listing Agent and Property Owner regarding the accuracy or reliability of the information furnished.