

# SOUTHERN PLAZA

4200 S. East Street, Indianapolis, IN 46227

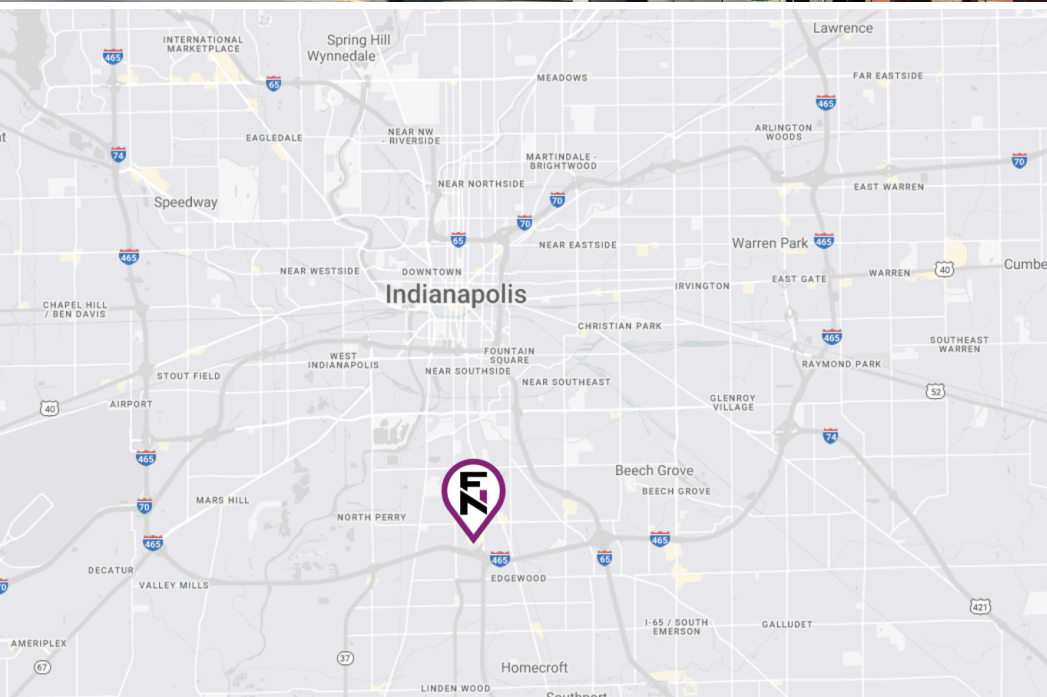

## HIGHLIGHTS

MSA	Indianapolis
COUNTY	Marion
GLA	267,673
ACRES	40.62
PARKING	1,722

## DEMOGRAPHICS

	1 Mile	3 Mile	5 Mile
	9,987	69,735	211,868
	3,846	27,590	87,765
	\$67,990	\$80,115	\$86,635

## PROPERTY FEATURES

- Southern Plaza is a 267,652 SF shopping center anchored by a 59,520 SF Kroger grocery store.
- High-quality tenant roster including Ross, Harbor Freight, Oak Street Health, Goodwill, Qdoba, Cosmo Prof, BMO Bank and Sally Beauty.
- Situated in a dense and growing market approximately 5 miles south of downtown Indianapolis.
- Located directly off Interstate 465, an eight-lane expressway that sees average traffic counts of over 92,000 VPD and the property sits at the intersection of East Street and Hanna Avenue, with combined traffic counts of over 36,000 VPD.
- Within a 5-mile radius of the property, the population is over 211,000 people with an average household income over \$86,000.



PROPERTY WEBSITE

David Roth | 914-610-5193 | droth@fnrpusa.com

fnrpusa.com

# SOUTHERN PLAZA

4200 S. East Street, Indianapolis, IN 46227

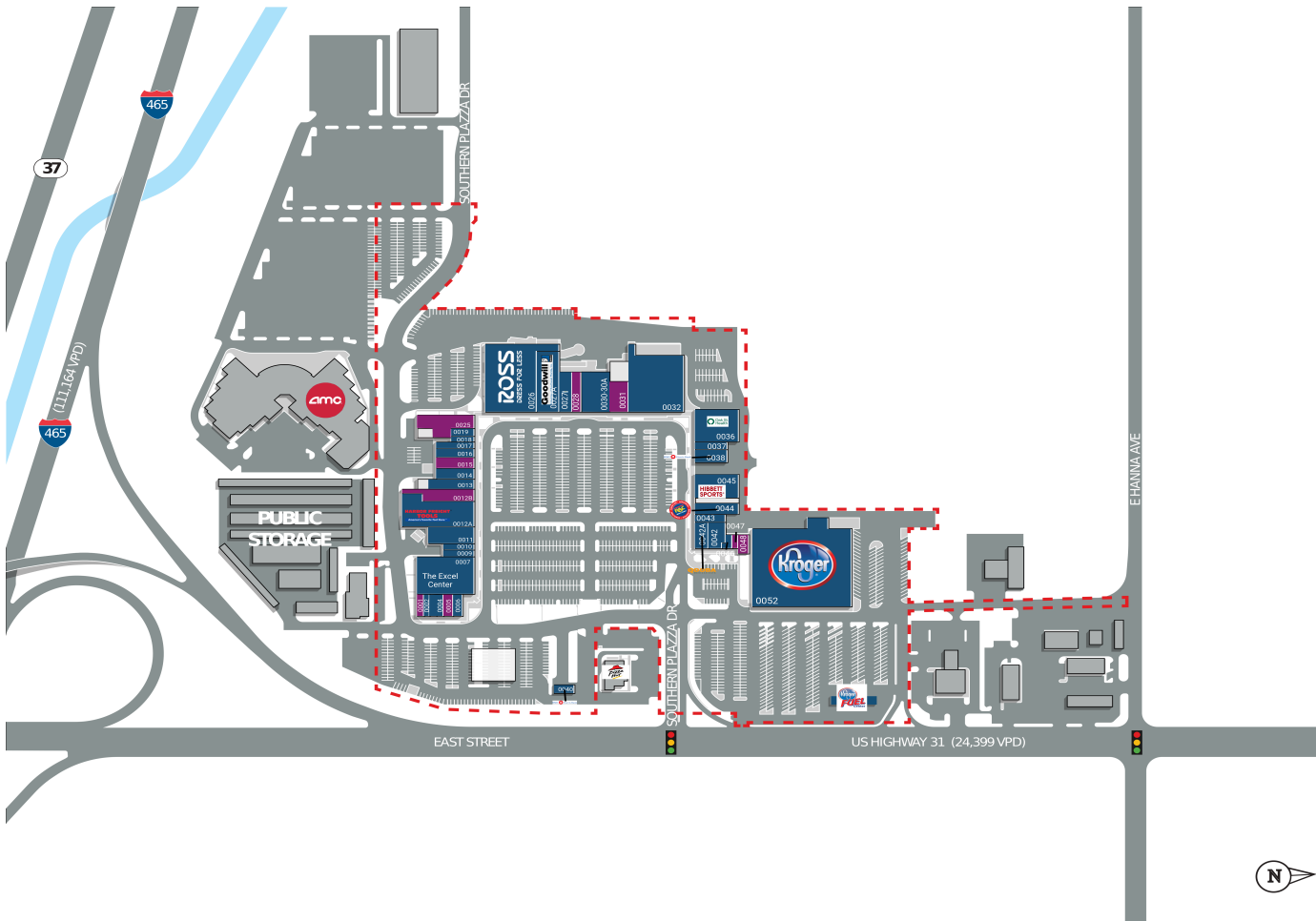

AVAILABLE
  AVAILABLE SOON
  LEASED
  NAP (NOT A PART)

SUITE	TENANT NAME	SF
<b>0001</b>	<b>Available</b>	<b>929</b>
0002	Freeway Insurance	800
0004	Top Nails	1,924
<b>0005</b>	<b>Available</b>	<b>1,392</b>
0006	Bert & Den's Grille	1,429
0007	The Excel Center	18,143
0009	People Ready	1,622
0010	Consumer Financial	1,622
0011	El Azabache	6,000
0012A	Harbor Freight	14,885
<b>0012B</b>	<b>Available</b>	<b>5,993</b>
0013	Gilvin's Boots & Shoes	3,300
0014	ComDent	2,500
<b>0015</b>	<b>Available</b>	<b>3,550</b>
0016	Seleny's Hair Salon & Barber Shop	2,527
0017	H&R Block	2,500
0018	Eyebrows Gallery	1,222
0019	China Garden	1,222
<b>0025</b>	<b>Available</b>	<b>6,755</b>
0026	Ross	29,238
0027	CosmoProf	3,658
0027A	Goodwill	10,984
<b>0028</b>	<b>Available</b>	<b>3,029</b>
0030-30A	Leased - National Tenant	9,600
<b>0031</b>	<b>Available</b>	<b>5,003</b>
0032	Leased - National Tenant	24,084
0036	Oak Street Health	11,210
0037	Sally Beauty Supply	1,700
0038	BMO Harris Bank	3,250
0040	BMO Harris Bank	1,200
0042	Eyeglass World	4,000
0042A	Qdoba	2,472
0043	Life Center, Inc.	1,870
0044	Rent-A-Center	4,084
0045	Hibbett Sports	7,822
0046	Smoker's Zone	881
<b>0047</b>	<b>Available</b>	<b>930</b>
<b>0048</b>	<b>Available</b>	<b>930</b>
0052	Kroger	59,520



PROPERTY WEBSITE

David Roth | 914-610-5193 | droth@fnrpusa.com

fnrpusa.com



# SOUTHERN PLAZA

4200 S. East Street, Indianapolis, IN 46227

**FIRST NATIONAL**  
REALTY PARTNERS



Disclaimer: All product and company names are trademarks™ or registered® trademarks of their respective holders. Use of them does not imply any affiliation with or endorsement by them. Any product names, logos, brands, and other trademarks or images featured or referred to within are the property of their respective trademark holders. These trademark holders are not affiliated with FNR. The information contained herein is for general informational purposes only. FNR makes no representation or warranty, express or implied. Your use of the information is solely at your own risk. This document may contain information concerning third party content, which FNR does not warrant, endorse, or assume liability for.

[fnrpusa.com](http://fnrpusa.com)