

7TH STREET RESTAURANT/RETAIL ROW

# Retail Campus in DTLA's Fashion District

**KENNEDY WILSON**  
BROKERAGE

700 South Main Street, Los Angeles, CA 90014

 [CLICK FOR VIRTUAL TOUR](#)

 [PROPERTY VIDEO](#)

## **BROKER BONUS**

Broker to receive \$5.00 PSF on  
minimum five year lease



JUSTIN WEISS · 213-538-8631 · [JWeiss@kennedywilson.com](mailto:JWeiss@kennedywilson.com) · DRE #01920886

LEE SHAPIRO · 310.887.6226 · [LShapiro@kennedywilson.com](mailto:LShapiro@kennedywilson.com) · DRE #00961769

FRANC MAGAÑA · 310.887.3572 · [FMagana@kennedywilson.com](mailto:FMagana@kennedywilson.com) · DRE #01866952

7  
MAIN





# Retail Campus in DTLA's Fashion District

700 South Main Street, Los Angeles, CA 90014

GROUND FLOOR  
±1,100 SF - 6,200 SF

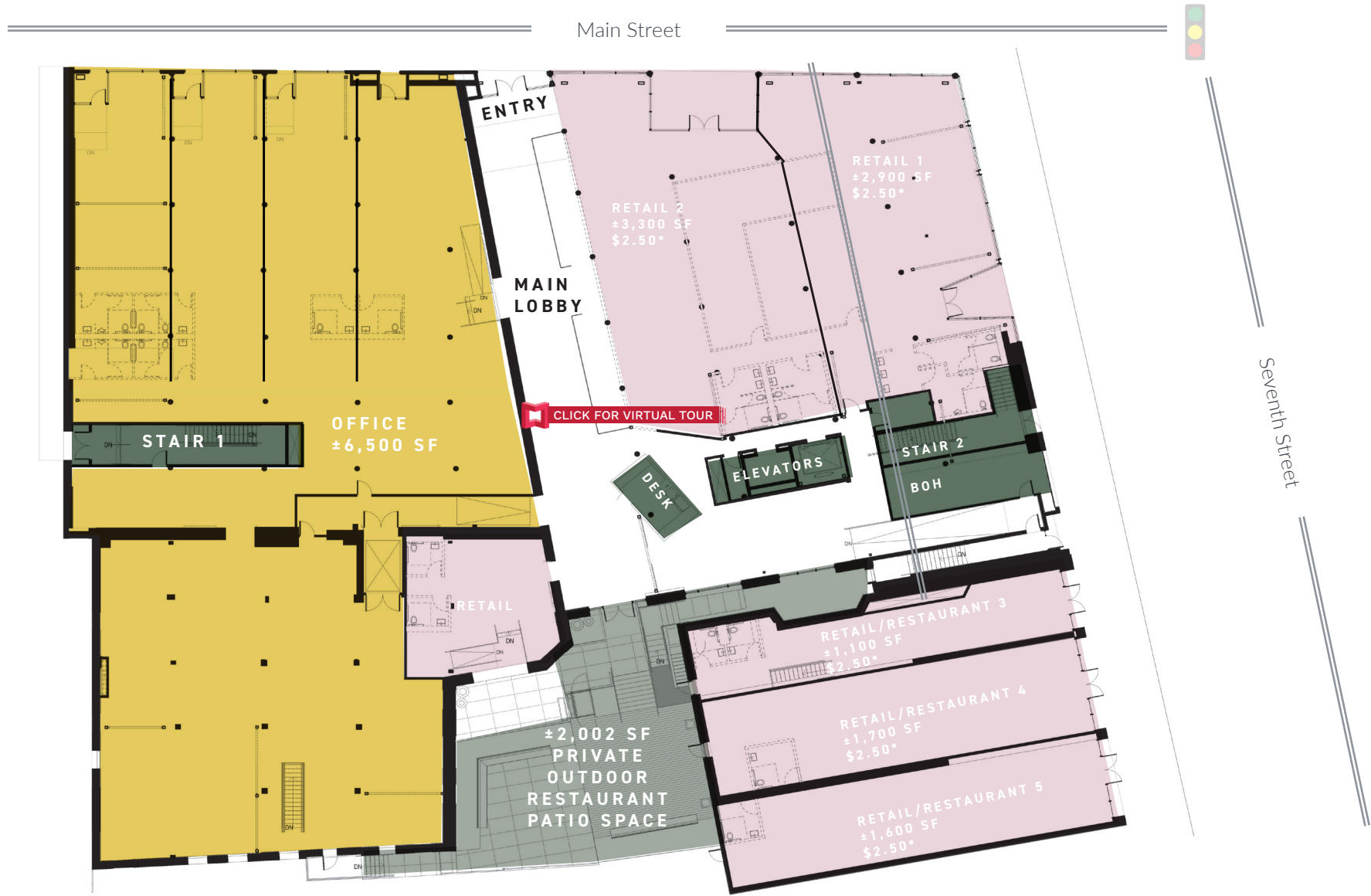

# Retail Campus in DTLA's Fashion District

700 South Main Street, Los Angeles, CA 90014

## BASEMENT BAR SPACE ±2,000 - 4,000 SF





7TH STREET RESTAURANT/RETAIL ROW

# Retail Campus in DTLA's Fashion District

KENNEDY WILSON

BROKERAGE

700 South Main Street, Los Angeles, CA 90014

## EXTERIORS





## 7TH STREET RESTAURANT/RETAIL ROW

# Retail Campus in DTLA's Fashion District

KENNEDY WILSON

BROKERAGE

700 South Main Street, Los Angeles, CA 90014

## ADDITIONAL PARKING



**LOT 212**  
212 EST 7TH ST.  
UNRESERVED  
Monthly: \$140

**759 MAPLE AVE.**  
UNRESERVED  
Monthly: \$180

**300 E. 8TH ST.**  
UNRESERVED  
Monthly: \$180



**700 S. MAIN ST.**

**710 SPRING ST.**  
UNRESERVED  
Daily: \$10 Flat

**825 SANTEE ST.**  
UNRESERVED  
Monthly: \$200

**820 S. MAIN ST.**  
UNRESERVED  
Monthly: \$200

**843 S. SPRING ST.**  
UNRESERVED  
Monthly: \$200

**843 S. SPRING ST.**  
UNRESERVED  
Monthly: \$200

**817 S. SPRING ST.**  
RESERVED DAILY ONLY  
Monthly: \$200

**UNIFIED PARKING**  
805 S. SPRING ST.  
RESERVED  
Monthly: Varies



# Retail Campus in DTLA's Fashion District

700 South Main Street, Los Angeles, CA 90014

## NEIGHBORHOOD



### OFFICES

- 01 William Randolph Hearst's original office
- 08 Calmart
- 14 Broadway Trade Center
- 32 Fabric

### HOTELS

- 02 Proper Hotel
- 04 The Hoxton Hotel
- 06 Ace Hotel
- 09 Freehand Hotel

- 23 Tuck Hotel
- 36 Nomad Hotel

### RESIDENTIAL

- 05 Broadway Palace Apartments
- 11 Eastern Columbia
- 26 Copper Design Space
- 33 Santee Village
- 37 The Grace
- 38 The Griffin

### RETAIL

- 03 Santee Alley
- 12 Acne Studios
- 13 Theory
- 15 A.P.C. & Aesop
- 16 A.L.C.
- 17 Gentle Monster
- 18 Urban Outfitters
- 19 Vans
- 20 Apple
- 21 Tanner Goods
- 27 Ron Tomson
- 29 COS
- 35 LA Flower Mart

### F&B

- 07 Pattern Bar
- 10 Shake Shack & Sweetgreen
- 22 Verve Coffee
- 24 Terroni
- 25 Stumptown Coffee
- 28 Sonoratown
- 30 Little Damage
- 31 Wild Living Foods
- 34 No Ghost Bears

# Retail Campus in DTLA's Fashion District

BROKERAGE

700 South Main Street, Los Angeles, CA 90014

## ROOFTOP BARS

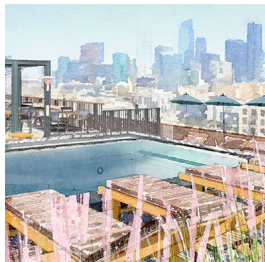

01 Proper Hotel



02 The Hoxton Hotel

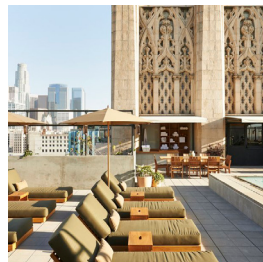

03 Ace Hotel



04 Freehand Hotel



05 Nomad Hotel



06 Perch



07 Fabric



# Retail Campus in DTLA's Fashion District

700 South Main Street, Los Angeles, CA 90014

## DTLA DEMOGRAPHICS

### Live 80,000+ RESIDENTS

**\$93,000**

AVERAGE HHI

**90%** RESIDENTIAL OCCUPANCY

**26%** RESIDENTIAL INVENTORY GROWTH SINCE 2010

**41%** POPULATION GROWTH 2010-2022

**61%**

25-54 YEARS OLD

**67%**

LOVE DTLA



**67%** POST SECONDARY EDUCATION



**46%** WALK, BIKE, OR TAKE TRANSIT TO WORK

### Work 288,000+ JOBS

**\$95,000**

AVERAGE HHI

**79%** EXPECT TO BE IN THE OFFICE AT LEAST HALF THE TIME

**19%** JOB GROWTH IN "KNOWLEDGE INDUSTRIES"

**19%** OF CITYWIDE JOBS

**61%**

30-54 YEARS OLD



**57%** POST SECONDARY EDUCATION



**57%** COMMUTE LESS THAN 7 MILES FROM THEIR HOME



### Visit 17 MILLION VISITORS IN 2023

**\$4.5 Billion**

SPENT YEARLY

**58%** HAVE VISITED GRAND CENTRAL MARKET

**58%** HAVE VISITED ARTS DISTRICT

**55%** HAVE VISITED LITTLE TOKYO

**745**

RETAIL BUSINESSES PER SQUARE MILE



**171** FOOD/BEVERAGE BUSINESSES PER SQUARE MILE



**93** WALK SCORE



Source: DCBID Demographic Survey 2024

# KENNEDY WILSON

## BROKERAGE

### JUSTIN WEISS

213-538-8631

[JWeiss@kennedywilson.com](mailto:JWeiss@kennedywilson.com)

DRE #01920886

### LEE SHAPIRO

310-887-6226

[LShapiro@kennedywilson.com](mailto:LShapiro@kennedywilson.com)

DRE #00961769

### FRANC MAGAÑA

310-887-3572

[FMagana@kennedywilson.com](mailto:FMagana@kennedywilson.com)

DRE #01866952

Kennedy Wilson Brokerage | 151 S. El Camino Drive, Beverly Hills, CA 90212 | 310-887-6400

Kennedy-Wilson Properties, Ltd. (Responsible Broker Identity, DRE #00659610) makes no warranty or representation as to the accuracy of the information contained herein. Terms of sale or lease and availability of the property are subject to change or withdrawal without notice.