

FOR LEASE

250 Diamond Avenue

Spruce Grove, AB



FLEXIBLE OPTIONS TO RECONFIGURE TO SUIT

Grant Ranslam
Principal
780.702.5853
grant.ranslam@avisonyoung.com

Bryce Williamson
Principal
587.984.6199
bryce.williamson@avisonyoung.com

**AVISON
YOUNG**

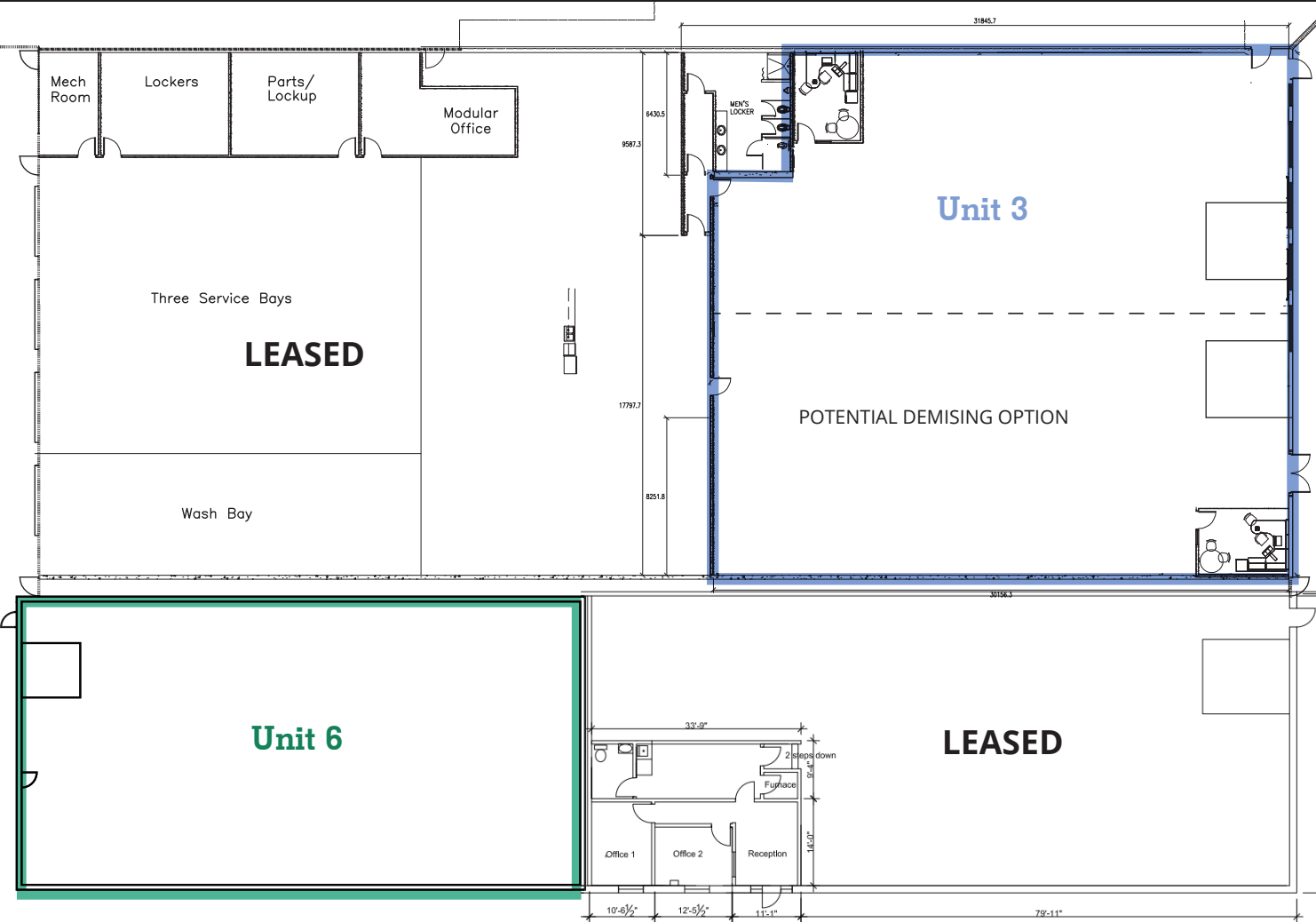

Unit 6	
Area Available:	4,900 sf
Zoning:	M1 - General Industrial
Loading:	Grade (1 - 12'x14')
Lease Rate:	\$11.00 psf
Operating Costs:	\$5.60 psf (Common Area)

- Grade loading
- Competitive land cost base allows for below market lease rates

Unit 3	
Area Available:	8,800 sf (Demising option available)
Zoning:	M1 - General Industrial
Loading:	Possibility for grade loading
Lease Rate:	\$11.00 psf
Operating Costs:	\$5.60 psf (Common Area)

- Excellent access to Diamond Avenue with close proximity to Golden Spike Road, Century Road and Highway 16A

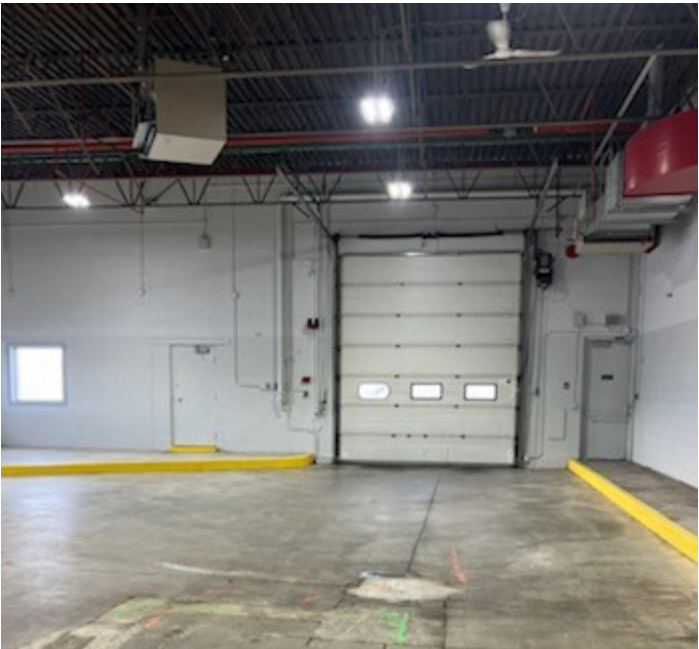
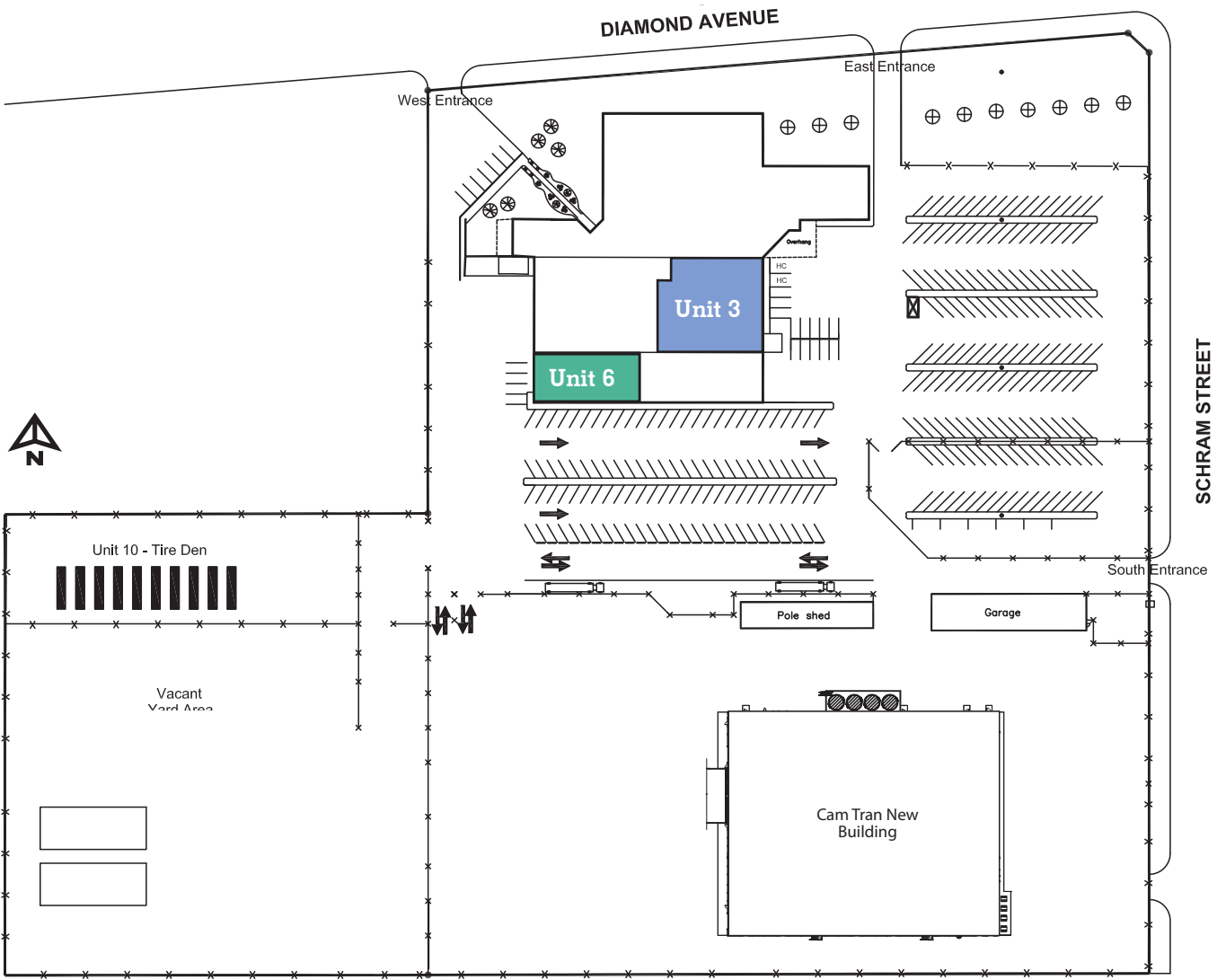

FOR LEASE

250 Diamond Avenue
Spruce Grove, AB



**Get more
information**

Grant Ranslam
Principal
780.702.5853
grant.ranslam@avisonyoung.com

Bryce Williamson
Principal
587.984.6199
bryce.williamson@avisonyoung.com

**AVISON
YOUNG**