

# Industrial Space

31,440 Square Feet

8 Marway Circle  
Gates, New York 14624

Accessible Location Near I-490



## Property Overview

Conveniently located space zoned for industrial use in the Town of Gates near I-490. 8 Marway Circle is a 31,440 square foot facility offering 25' clear height, ESFR sprinklers, 6 docks, 200amp 277/480volt 3 phase power, 40' x 50' column spacing.

## Offering Details

- + 31,440 SF Industrial Building
- + 25' Clear, 6 Docks
- + ESFR Sprinklers
- + Lease Rate: \$8.50/sf NNN

## Industrial Space

8 Marway Circle | Gates, NY 14624

For Lease



# Property Details

- + 31,440 Square Feet Available
- + 200 amps, 277/480 volt, 3 phase power
- + Paved Parking Area
- + General Industrial Zoning
- + 6 Loading Docks
- + ESFR Sprinklers
- + 25' Clear Height
- + 40' x 50' Column Spacing
- + Lease Rate \$8.50/sf NNN

## Contact Us

### Patrick Wahl

+1 585 784 3633

patrick.wahl@cbre-rochester.com

Licensed Real Estate Salesperson

### Harry Gleason, SIOR

+1 585 784 3639

harry.gleason@cbre-rochester.com

Licensed Associate Real Estate Broker

© 2025 CBRE Upstate NY, part of the CBRE Affiliate Network. All rights reserved. This information has been obtained from sources believed reliable, but has not been verified for accuracy or completeness. You should conduct a careful, independent investigation of the property and verify all information. Any reliance on this information is solely at your own risk. CBRE Upstate NY and the CBRE Upstate NY logo are service marks of CBRE Upstate NY. All other marks displayed on this document are the property of their respective owners, and the use of such logos does not imply any affiliation with or endorsement of CBRE Upstate NY. Photos herein are the property of their respective owners. Use of these images without the express written consent of the owner is prohibited.

### CBRE Upstate NY

1350 University Ave, Ste 100

Rochester, NY 14607

+1 585 240 8080

www.cbre.com/rochester

# CBRE Upstate NY

PART OF THE AFFILIATE NETWORK

## Industrial Space

8 Marway Circle | Gates, NY 14624

# For Lease

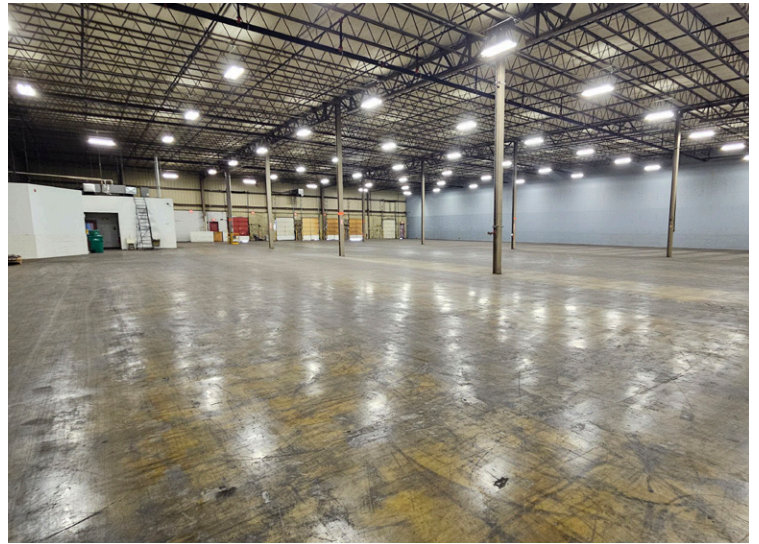

## Contact Us

### Patrick Wahl

+1 585 784 3633

[patrick.wahl@cbre-rochester.com](mailto:patrick.wahl@cbre-rochester.com)

Licensed Real Estate Salesperson

### Harry Gleason, SIOR

+1 585 784 3639

[harry.gleason@cbre-rochester.com](mailto:harry.gleason@cbre-rochester.com)

Licensed Associate Real Estate Broker

© 2025 CBRE Upstate NY, part of the CBRE Affiliate Network. All rights reserved. This information has been obtained from sources believed reliable, but has not been verified for accuracy or completeness. You should conduct a careful, independent investigation of the property and verify all information. Any reliance on this information is solely at your own risk. CBRE Upstate NY and the CBRE Upstate NY logo are service marks of CBRE Upstate NY. All other marks displayed on this document are the property of their respective owners, and the use of such logos does not imply any affiliation with or endorsement of CBRE Upstate NY. Photos herein are the property of their respective owners. Use of these images without the express written consent of the owner is prohibited.

### CBRE Upstate NY

1350 University Ave, Ste 100

Rochester, NY 14607

+1 585 240 8080

[www.cbre.com/rochester](http://www.cbre.com/rochester)

# CBRE Upstate NY

PART OF THE AFFILIATE NETWORK

## Industrial Space

8 Marway Circle | Gates, NY 14624

For Lease

Tire Centers, LLC #160  
8 Marway Circle  
Rochester, NY  
Enlarged Office Plan  
1,600+ SF Rev 6/10/11

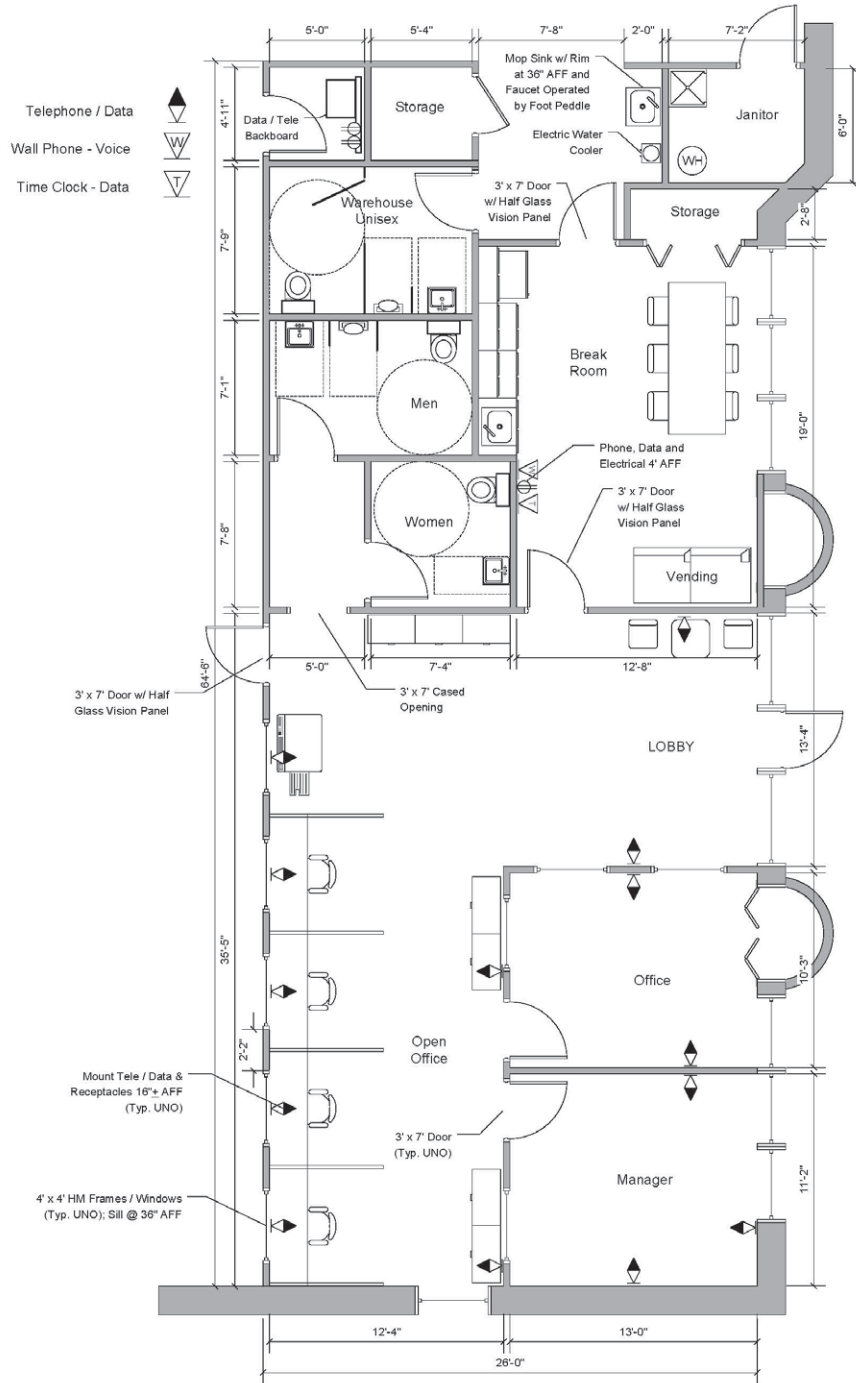

This layout is for General Arrangement only. Detailed drawings, compliance with applicable codes, and permits, if any, are the responsibility of the Contractor. See Detailed Scope of Work and Finish Schedule for Additional Notes.

## Contact Us

**Patrick Wahl**

+1 585 784 3633

patrick.wahl@cbre-rochester.com

Licensed Real Estate Salesperson

**Harry Gleason, SIOR**

+1 585 784 3639

harry.gleason@cbre-rochester.com

Licensed Associate Real Estate Broker

**CBRE Upstate NY**

PART OF THE AFFILIATE NETWORK

## Industrial Space

8 Marway Circle | Gates, NY 14624

For Lease

Tire Centers, LLC #160  
8 Marway Circle  
Rochester, NY  
GA w/ Racking Plan  
31,440+ SF Rev 6/10/11

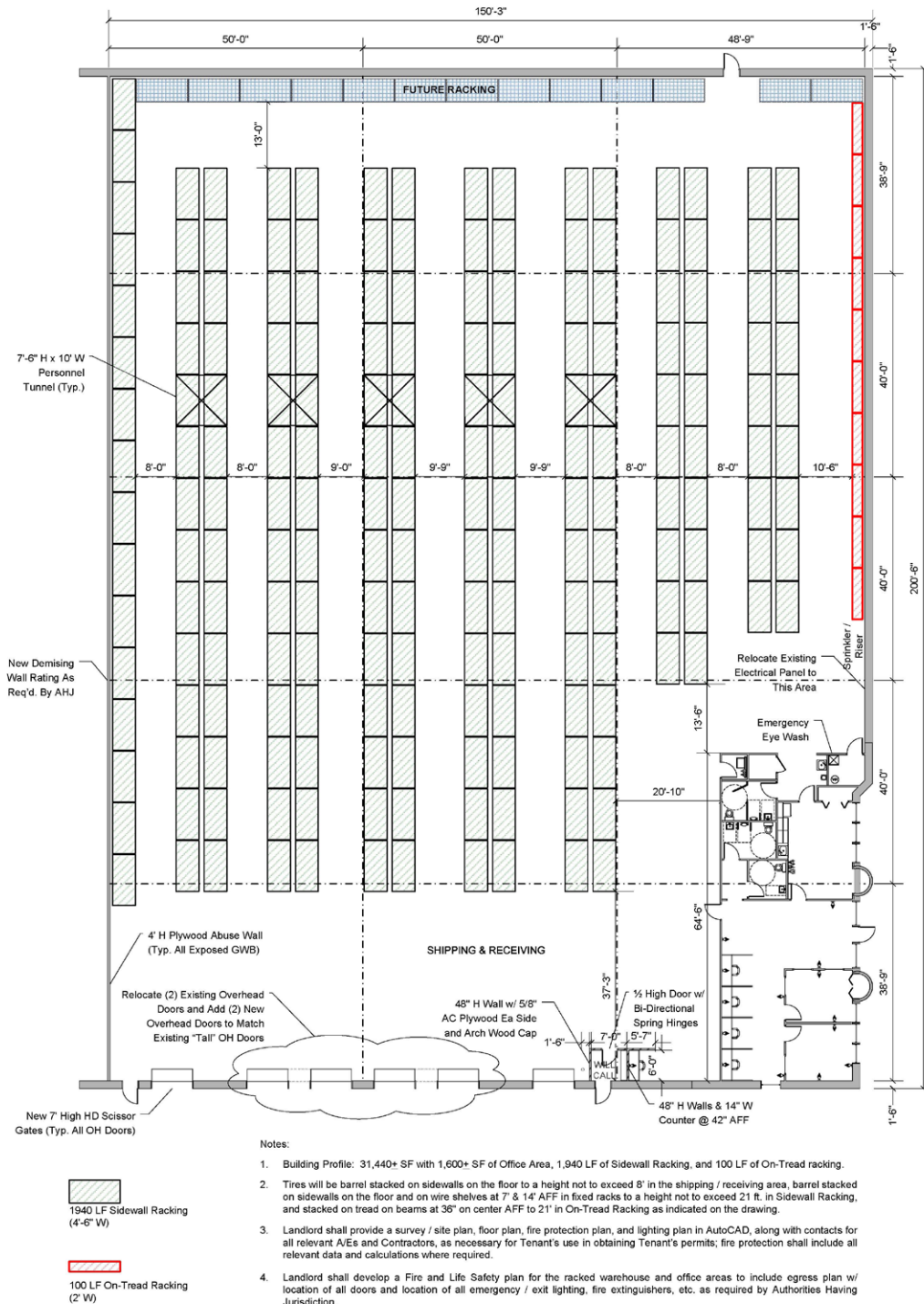

### Notes:

1. Building Profile: 31,440+ SF with 1,600+ SF of Office Area, 1,940 LF of Sidewall Racking, and 100 LF of On-Tread racking.
2. Tires will be barrel stacked on sidewalls on the floor to a height not to exceed 8' in the shipping / receiving area, barrel stacked on sidewalls on the floor and on wire shelves at 7' & 14' AFF in fixed racks to a height not to exceed 21 ft. in Sidewall Racking, and stacked on tread on beams at 36" on center AFF to 21' in On-Tread Racking as indicated on the drawing.
3. Landlord shall provide a survey / site plan, floor plan, fire protection plan, and lighting plan in AutoCAD, along with contacts for all relevant A/E's and Contractors, as necessary for Tenant's use in obtaining Tenant's permits; fire protection shall include all relevant data and calculations where required.
4. Landlord shall develop a Fire and Life Safety plan for the racked warehouse and office areas to include egress plan w/ location of all doors and location of all emergency / exit lighting, fire extinguishers, etc. as required by Authorities Having Jurisdiction.
5. Install new hi-bay fluorescent lighting in the center of aisles and shipping / receiving area as required to provide a minimum 35 fc @ 3' AFF. Maintain maximum clear height throughout.
6. Install additional emergency / exit lights for the racked warehouse as required by Authorities Having Jurisdiction.

This layout is for General Arrangement only. Detailed drawings, compliance with applicable codes, and permits, if any, necessary for Landlord's work are the responsibility of the Landlord. See Detailed Scope of Work and Finish Schedule for Additional Notes.

## Contact Us

Patrick Wahl

+1 585 784 3633

patrick.wahl@cbre-rochester.com

Licensed Real Estate Salesperson

Harry Gleason, SIOR

+1 585 784 3639

harry.gleason@cbre-rochester.com

Licensed Associate Real Estate Broker

**CBRE Upstate NY**  
PART OF THE AFFILIATE NETWORK