



# INDUSTRIOUS

## WICKER PARK - CHICAGO



**INDUSTRIOUS**

As the largest premium flexible workplace provider, Industrious helps modern companies of all sizes be both efficient and effective by creating workplace experiences designed to drive productivity. Leading the industry in performance and customer satisfaction, Industrious makes it easy to place your team in workspaces that fit their needs and keep them happy as they grow.



**CRAFT COFFEE & TEA**



**DAILY BREAKFAST & SNACKS**



**FULLY FURNISHED**



**DEDICATED ON-SITE STAFF**



**UNLIMITED COLOR PRINTING**



**OFFICE SUPPLIES**



**WEEKLY HAPPY HOURS**



**COMMUNITY EVENTS**



**FAST, SECURE WIFI**



**PROFESSIONAL-GRADE CLEANING**



**PACKAGE & MAIL HANDLING**



**24/7 ACCESS**



# 1720 W DIVISION ST | 2ND & 3RD FLOOR

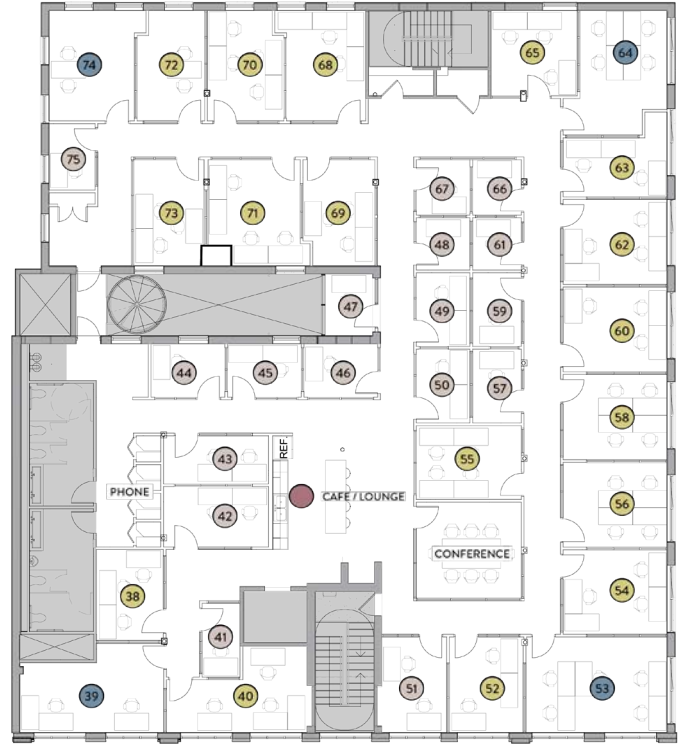
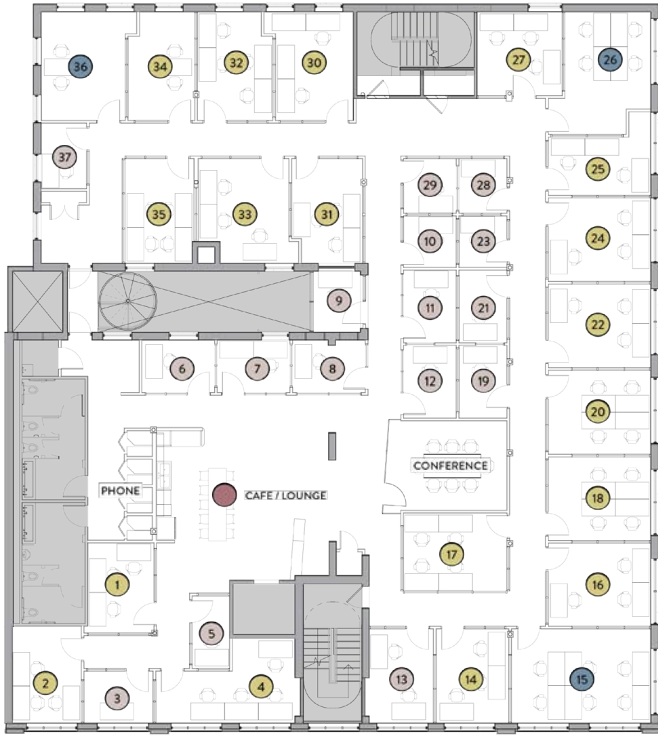

Steps away from the Blue Line, our premier workspace in Chicago's most creative neighborhood is designed to inspire you. Located in a newly renovated warehouse building, the space is complete with floor-to-ceiling windows, state-of-the-art technology, and all the amenities you need for a perfect workday.

The culture at Industrious Wicker Park is one of pace and excitement, surrounded by one of the city's most favored and fashionable neighborhoods and connected the most traveled transit options.

# COWORKING ■ PRIVATE OFFICES ■ MEETING ROOMS ■



## The Industrious difference

Traditional Lease vs. Industrious	Traditional Lease	Industrious
Flexible lease terms (1-3 years)		✓
Upfront capital investment (build-out costs, security deposit, furniture & fixtures)	✓	
Ability to scale up (or down) with headcount variability		✓
Fully-managed workplace experience includes everything from leasing to workplace design and management		✓
All-inclusive operational costs (office cleaning, maintenance, supplies, food & beverage)		✓
Dedicated Member Success Manager ensures company is happy and productive		✓
Increased employee engagement by 2.5X average score		✓

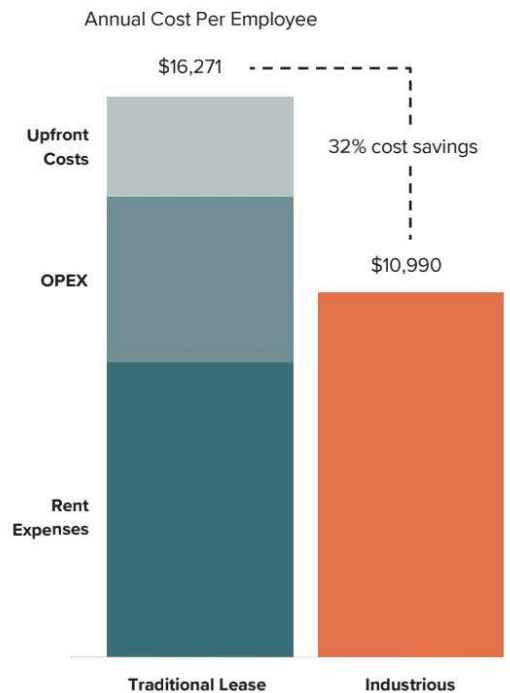

Based on annual costs per employee. Includes rent, operating expenses, upfront costs (buildout/design). Based on blended average of top 10 US cities.



# WICKER PARK

## *Amenities*

### Wicker Park



### Transit (CTA Blue Line at Damen/Milwaukee)

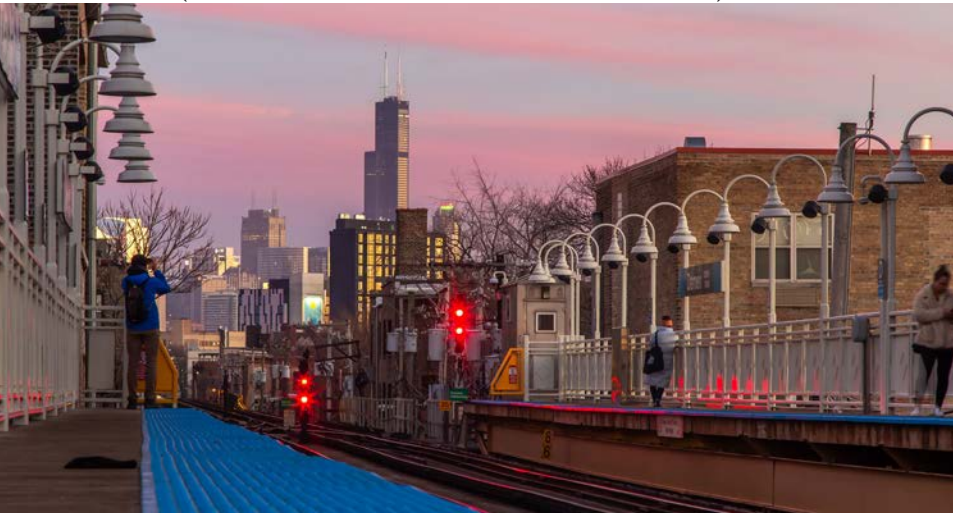

## *Transit*

- 1 BLOCK TO BLUE LINE**
- 1-3 BLOCKS TO BUS STOPS**
- DIVVY/LYFT STATION**
- EASY ACCESS TO I-90 & I-290**
- PARKING NEARBY**

### Shopping & Dining (Big Star Patio)



### **BROOKLINE REAL ESTATE**

brooklinellc.com  
info@brooklinellc.com

### **DOMINICK CANNATA**

630.590.5910 ext 113  
dc@brooklinellc.com

  
**INDUSTRIOUS**

X

