

FOR LEASE OFFICE BUILDING



2600 MICHELSON DRIVE | IRVINE, CALIFORNIA

PROPERTY HIGHLIGHTS

- Plug & Play
- Large Executive Office
- Approximately 18 Workstations
- Large Conference Room - Seating 18
- Six Window Offices
- AV Room for Recording
- Open Kitchen
- Sublease Thru June 30, 2025

EXCLUSIVELY LISTED BY:

Andy Batcheller

Senior Vice President
949.468.2378 Direct
abatcheller@naicapital.com
CA DRE #00872050



PROPERTY OVERVIEW

Class A Creative Office for Sublease

SPACES	LEASE RATE	SPACE SIZE
Suite 1400	\$1.75 SF/month	9,351 SF

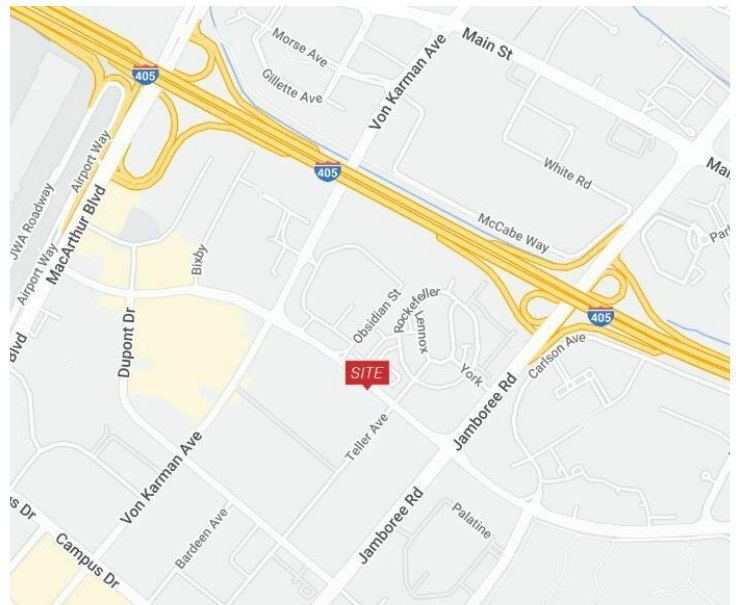

www.naicapital.com

PROPERTY PHOTOS



Andy Batcheller
Senior Vice President
949.468.2378 Direct
abatcheller@naicapital.com

CA DRE #00872050

No warranty, express or implied, is made as to the accuracy of the information contained herein. This information is submitted subject to errors, omissions, change of price, rental or other conditions withdrawal without notice, and is subject to any special listing conditions imposed by our principals. Cooperating brokers, buyers, tenants and other parties who receive this document should not rely on it, but should use it as a starting point of analysis, and should independently confirm the accuracy of the information contained herein through a due diligence review of the books, records, files and documents that constitute reliable sources of the information described herein. Logos are for identification purposes only and may be trademarks of their respective companies. NAI Capital Commercial, Inc. CAL DRE Lic. #02130474

NAI Capital | 1920 Main Street #100 | Irvine, CA 92614



NAI Capital
COMMERCIAL REAL ESTATE SERVICES, WORLDWIDE

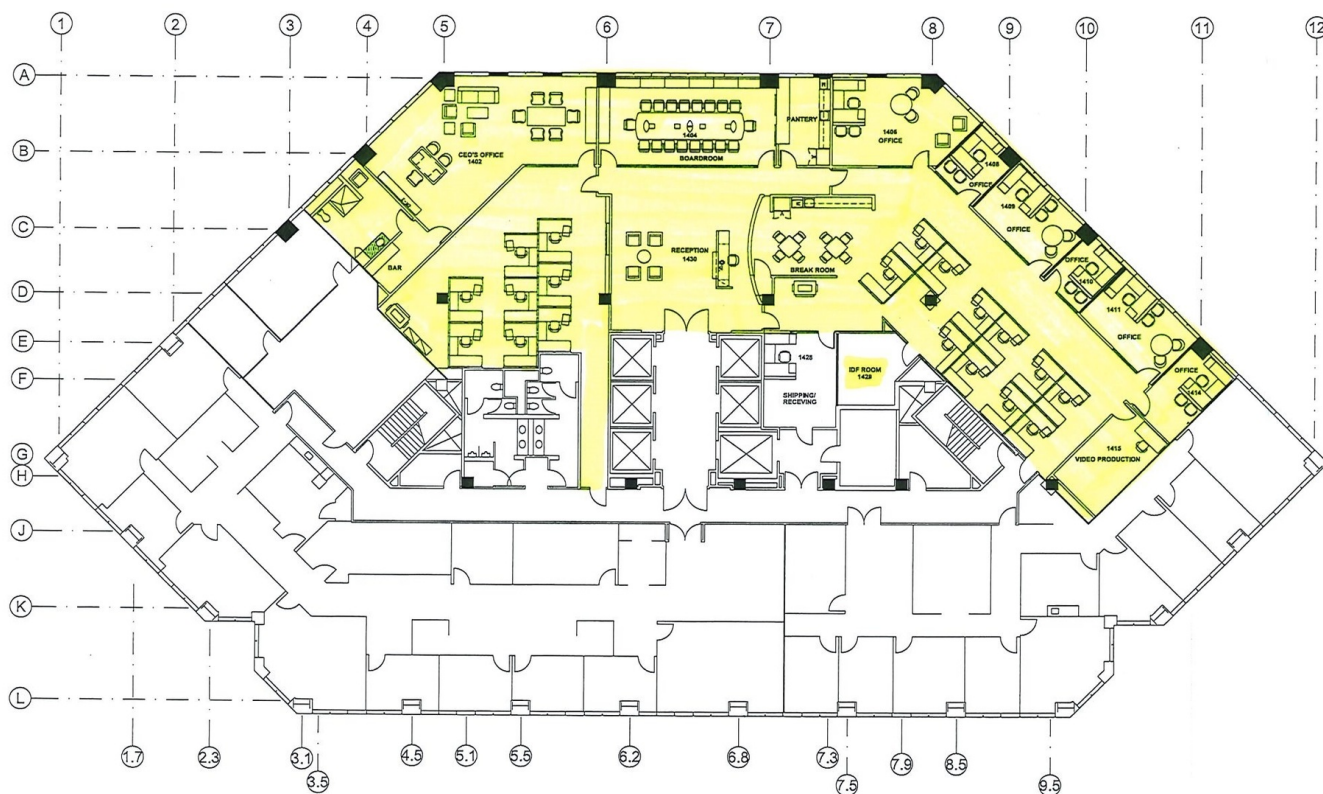

Senior Vice President
949.468.2378 Direct
abatcheller@naicapital.com

NAI Capital | 1920 Main Street #100 | Irvine, CA 92614