

FOR LEASE

Owned and Operated by



600 BARTLETT DRIVE

York, PA

±85,195 SF - Dry Warehouse



HIGHLIGHTS

Size ± 85,195 SF

Office Space ± 5,683 SF

Clear Height 30'

Dock Doors 18

Drive-in Doors 1

Auto Stalls 93

Trailer Stalls 26

Expansion ± 56 future additional



LEASING INFO & CONTACT

Bill Shrader | (717) 219-7742 | bshrader@lee-associates.com

John Van Buskirk, SIOR | (717) 497-1276 | jvanbuskirk@lee-associates.com

Leo Van Buskirk, CPA | (610) 601-8505 | leo.vanbuskirk@lee-associates.com



OVERVIEW

- Permitting Under Way: 56 Additional Trailer Spaces or Outdoor Storage
- Rooftop Mounted Gas-Fired HVAC Units
- Located in a Proven Distribution Corridor of I-83 in York, Pennsylvania
- Regionally Positioned to Serve the Mid-Atlantic
- Population of Nearly 500,000 with a 30 Minute Drive Labor Force of 299,839

SITE PLAN

PERMITTING UNDER WAY
UP TO 56 ADDITIONAL TRAILER SPACES
OR OUTSIDE STORAGE AREA

**EXTERIOR UPDATES:**

- BUILDING POWERWASH & PAINT
- EXTERIOR LIGHTING UPGRADE TO LED
- PAVING IN TRUCK COURT AND EMPLOYEE PARKING
- UPDATED LANDSCAPING

CREATING AN OPEN-CONCEPT OFFICE

- RELOCATION OF BREAKROOM
- RESTROOM RENOVATIONS
- NEW OFFICE RESTROOM
- REFRESH OF OFFICE SPACE

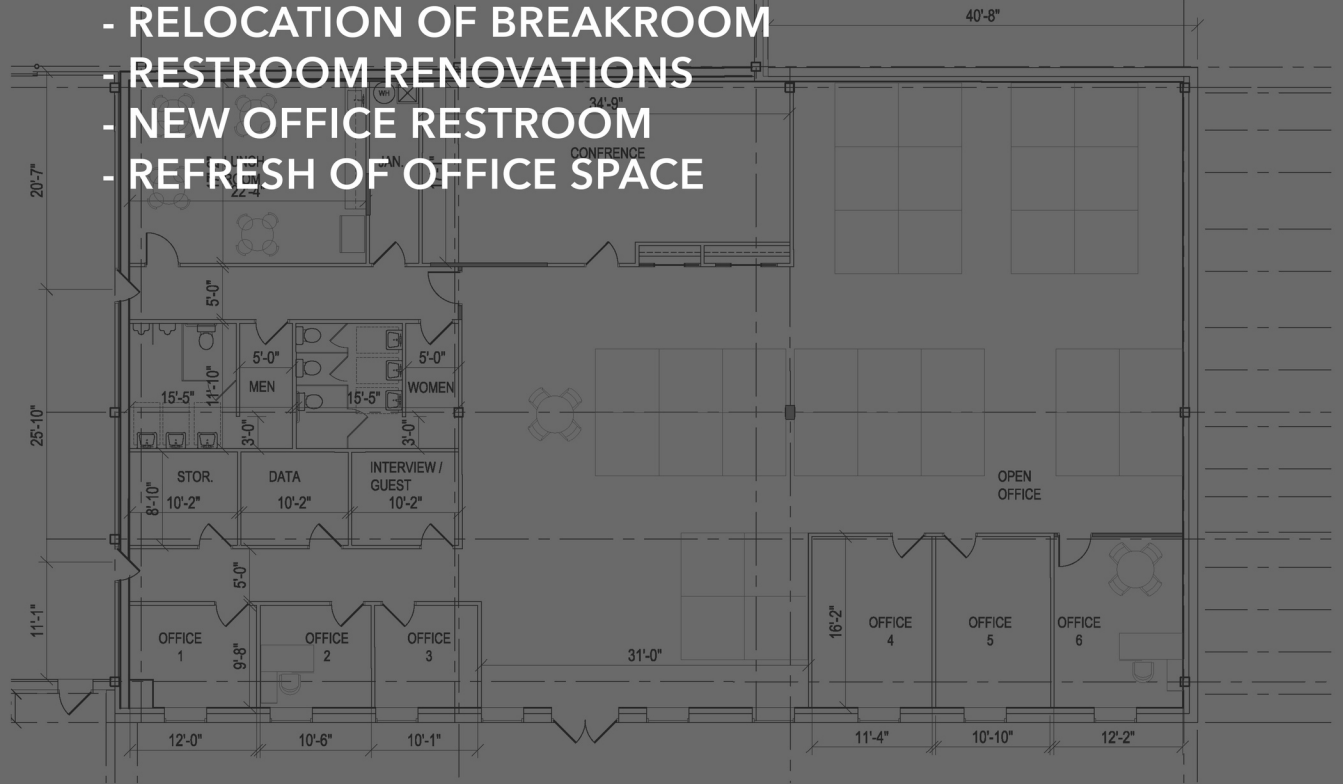

1
A101
NEW WORK FLOOR PLAN
SCALE: 1/8" = 1'-0"



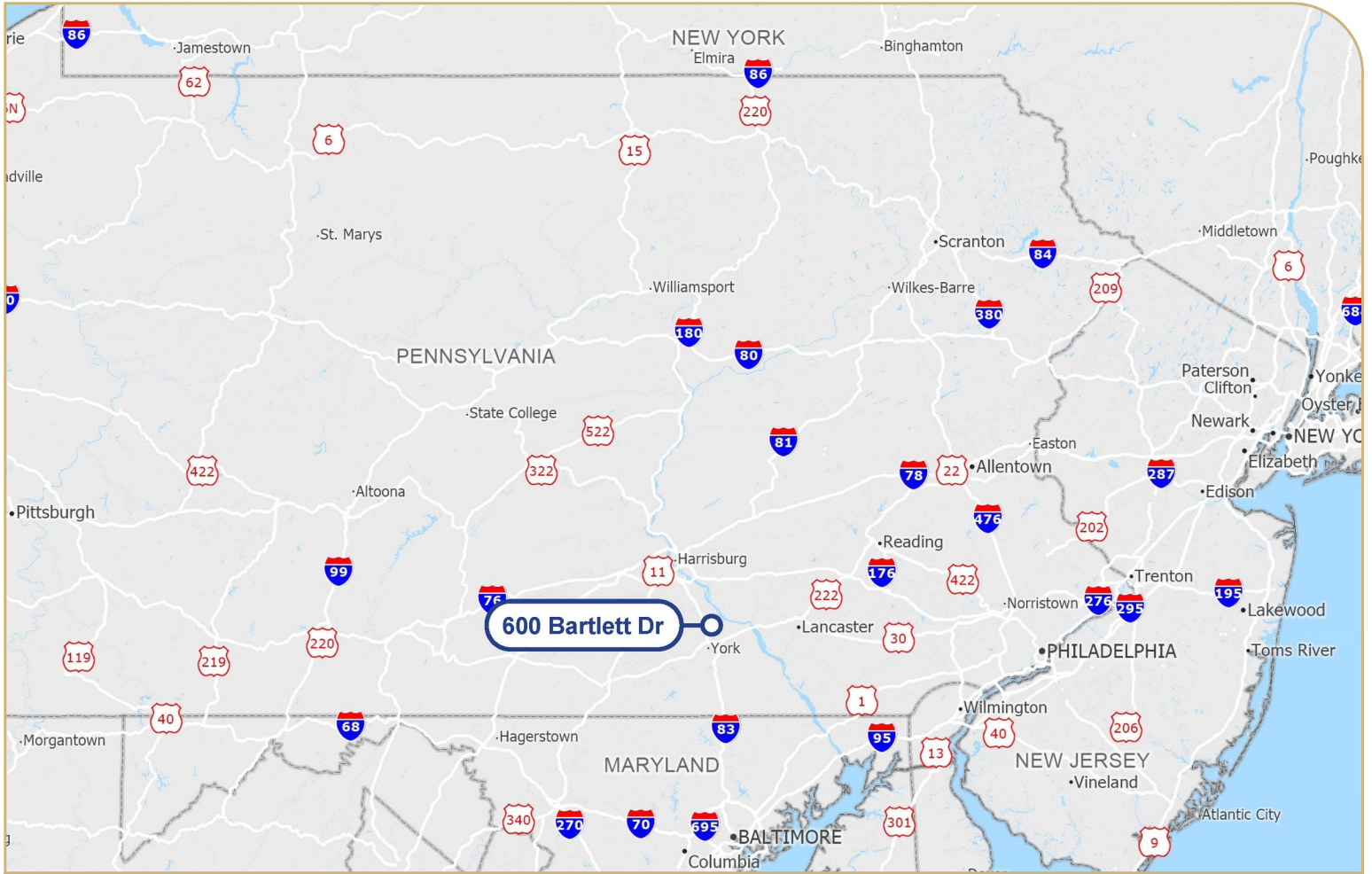

KEY DISTANCES

City	Min.	Mil.
Harrisburg, PA	25	20
Lancaster, PA	42	31
Carlisle, PA	44	36
Reading, PA	62	60
Baltimore, MD	62	60
Frederick, MD	84	68
Allentown, PA	110	105
Philadelphia, PA	122	106
Scranton, PA	140	142

Bill Shrader
 (717) 219-7742 / bshrader@lee-associates.com

John Van Buskirk, SIOR
 (717) 497-1276 / jvanbuskirk@lee-associates.com

Leo Van Buskirk, CPA
 (610) 601-8505 / leo.vanbuskirk@lee-associates.com

Lee & Associates of Eastern Pennsylvania LLC
 5053 Ritter Road, Suite 200
 Mechanicsburg, PA 17055 USA
 717.695.3840 | lee-associates.com/easternpa