



# FOR LEASE

980 Beaver Creek Drive  
Martinsville, VA



**Jimmy Appich**

T +1 804 200 6420  
Jimmy.appich@jll.com

**Scott Harrison**

T +1 804 200 6435  
Scott.harrison@jll.com

# FLOOR PLAN

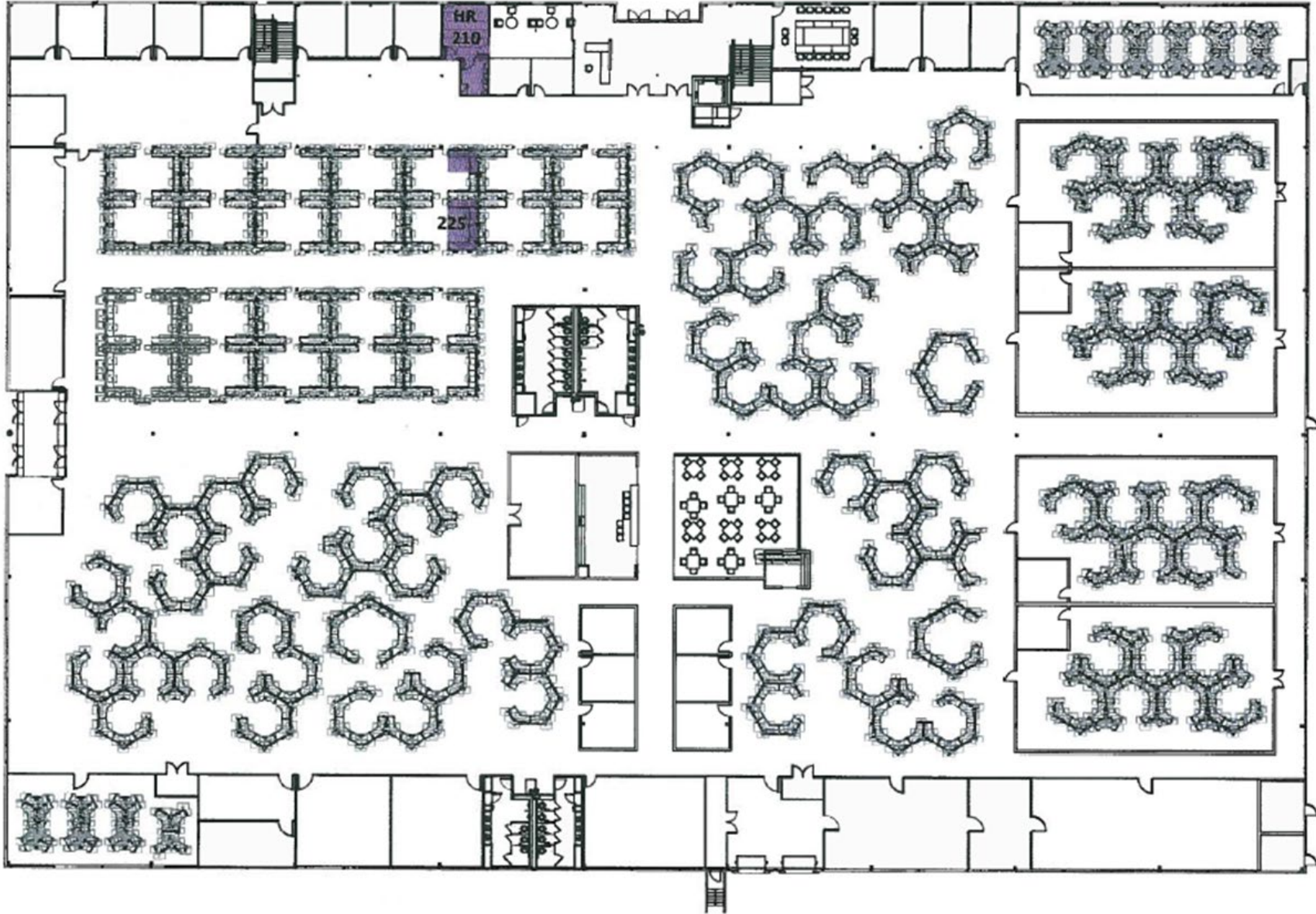

Jimmy Appich  
T +1 804 200 6420  
Jimmy.appich@jll.com

Scott Harrison  
T +1 804 200 6435  
Scott.harrison@jll.com







## PROPERTY HIGHLIGHTS

- ± 93,000 s.f. Class A building with call center operations infrastructure and office space
- Structural steel, precast concrete wall, TPO roof and glass structure
- ± 12,000 s.f. training mezzanine with floor to ceiling glass and terrazzo floors with view of surroundings and work floor
- Located in the Patriot Center
- Modern work facilities with high-end finishes
- Existing furniture systems available
- Offers an accelerated occupancy solution
- Heavy infrastructure; power and broadband
- Ample on-site parking

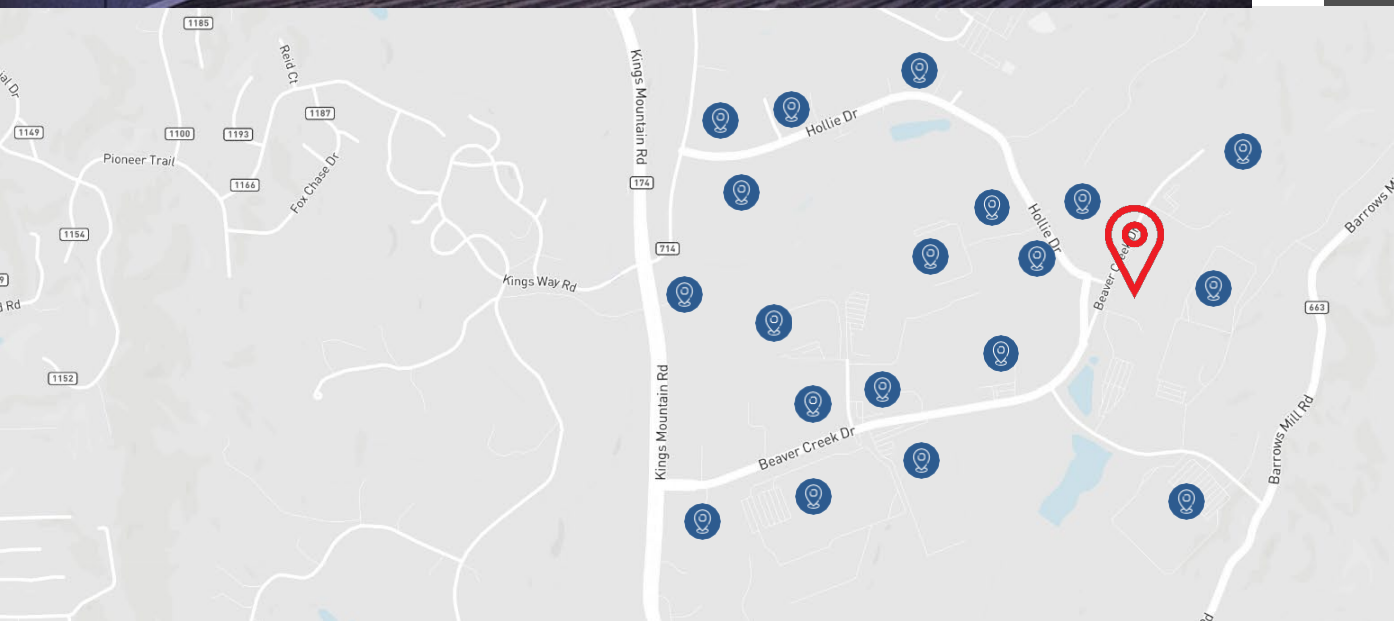

### Nearby Businesses

Nautica  
 Howmet Aerospace  
 Springs Industries  
 Hanesbrands, Inc.  
 MET Complex of PHCC  
 Eastman Performance Films  
 Kimball Hospitality  
 Bassett Furniture Industries  
 Mehler Engineered Products, Inc.  
 Valero

Eastman  
 Monogram Foods  
 Tarheel Paper & Supply Co.  
 J G Edelen Co., Inc.  
 Martinsville Race Camping  
 South Print  
 Radial  
 Carter Bank & Trust

Jimmy Appich

Scott Harrison

T +1 804 200 6420  
Jimmy.appich@jll.com

T +1 804 200 6435  
Scott.harrison@jll.com



# AMENITY MAP

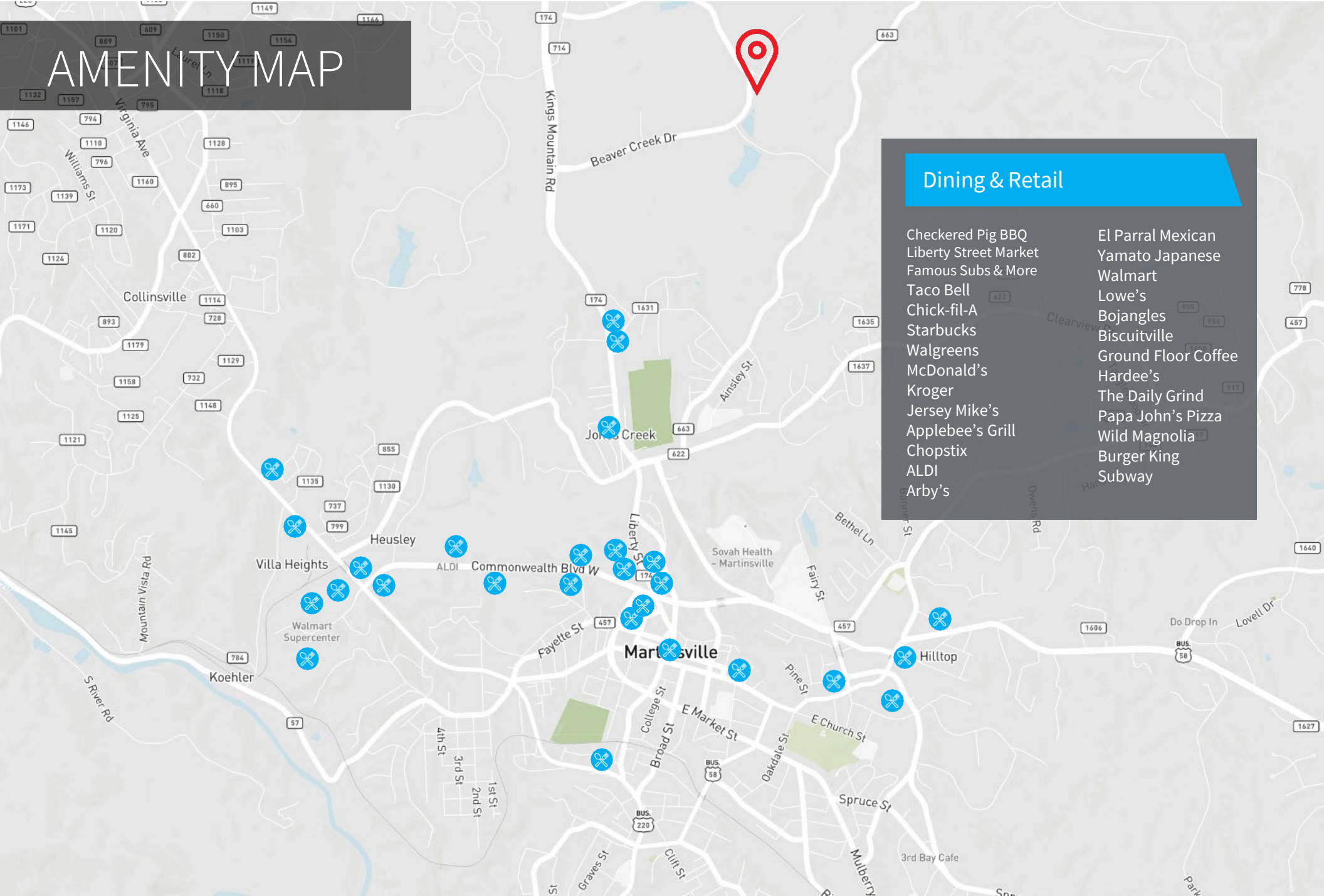

Jimmy Appich  
T +1 804 200 6420  
Jimmy.appich@jll.com

Scott Harrison  
T +1 804 200 6435  
Scott.harrison@jll.com





# MAP OVERVIEW

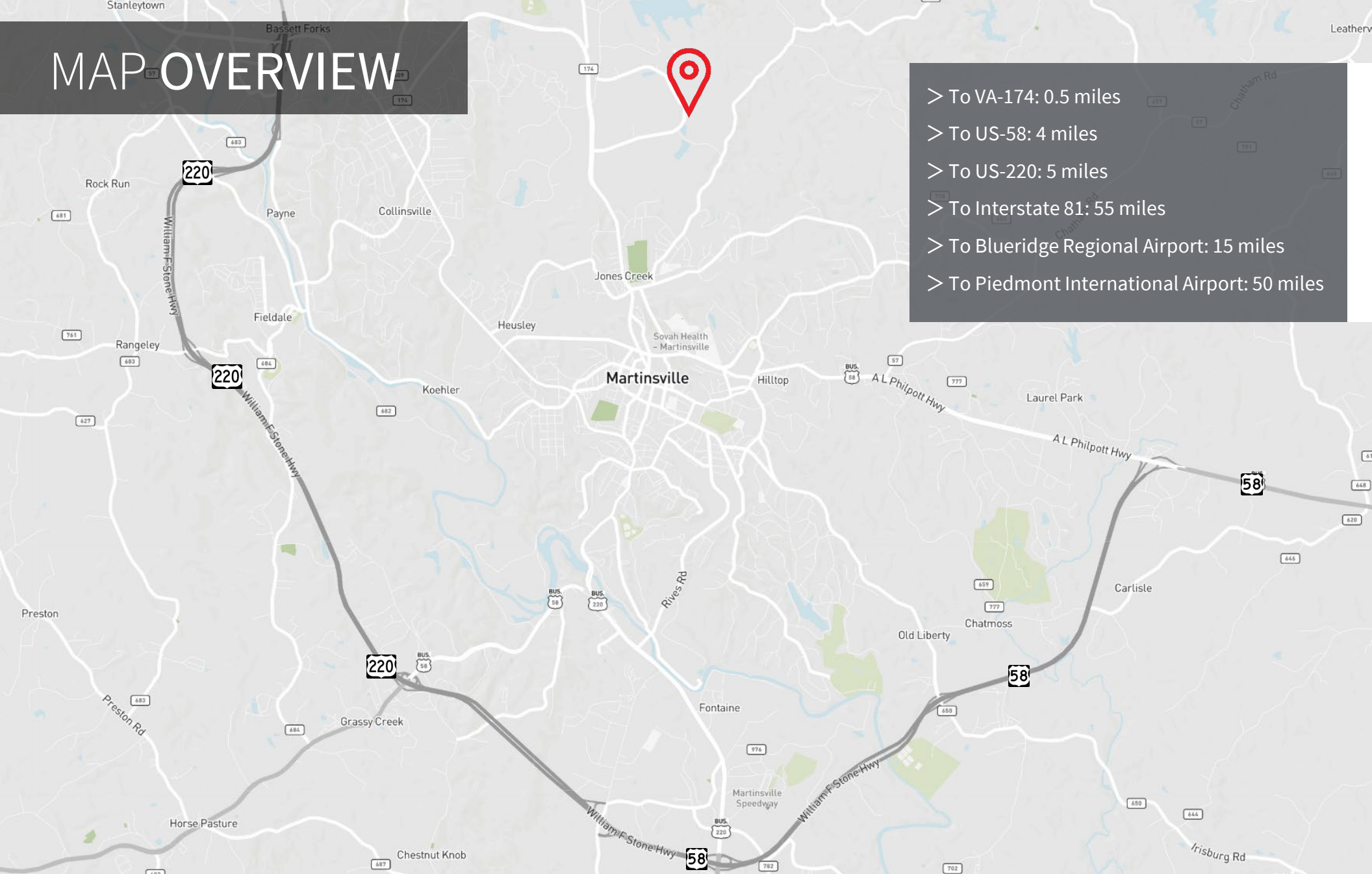

- > To VA-174: 0.5 miles
- > To US-58: 4 miles
- > To US-220: 5 miles
- > To Interstate 81: 55 miles
- > To Blueridge Regional Airport: 15 miles
- > To Piedmont International Airport: 50 miles

Jimmy Appich

Scott Harrison

T +1 804 200 6420  
Jimmy.appich@jll.com

T +1 804 200 6435  
Scott.harrison@jll.com

Although information has been obtained from sources deemed reliable, JLL does not make any guarantees, warranties or representations, express or implied, as to the completeness or accuracy as to the information contained herein. Any projections, opinions, assumptions or estimates used are for example only. There may be differences between projected and actual results, and those differences may be material. JLL does not accept any liability for any loss or damage suffered by any party resulting from reliance on this information. If the recipient of this information has signed a confidentiality agreement with JLL regarding this matter, this information is subject to the terms of that agreement. ©2022. Jones Lang LaSalle IP, Inc. All rights reserved.

