

BIOSCIENCES LABORATORIES

AT 665 3RD STREET, SAN FRANCISCO, CA

LAB BENCHES & OFFICE SPACE AVAILABLE



HIGHLIGHTS

- Plug-and-Play Lab Incubator
- Laboratory Benches and Shared or Private Office Space Available
- 3 Shared Conference Rooms
- Lab Supplies and Shared Equipment Provided
- Access to Cell Culture Suites, Biosafety Cabinets, and Cell Incubators
- 5 Min Walk to Caltrain
- Convenient Access to UCSF & Mission Bay



 **TRANSWESTERN**

ANDREW WHEELER

CA BRE # 02048909
andrew.wheeler@transwestern.com
415.489.1831

MAIRAJ DIN

CA BRE # 02197939
mairaj.din@transwestern.com
415.489.1769



SAMPLE EQUIPMENT LIST

- Laminar flow hoods
- CO2 Incubators
- Bacteria Incubators & Shakers
- - 80°C Freezers
- High-speed Centrifuge
- Analytical Balances
- Plate readers
- Ductless Fume Hood for light chemistry needs
- +much more

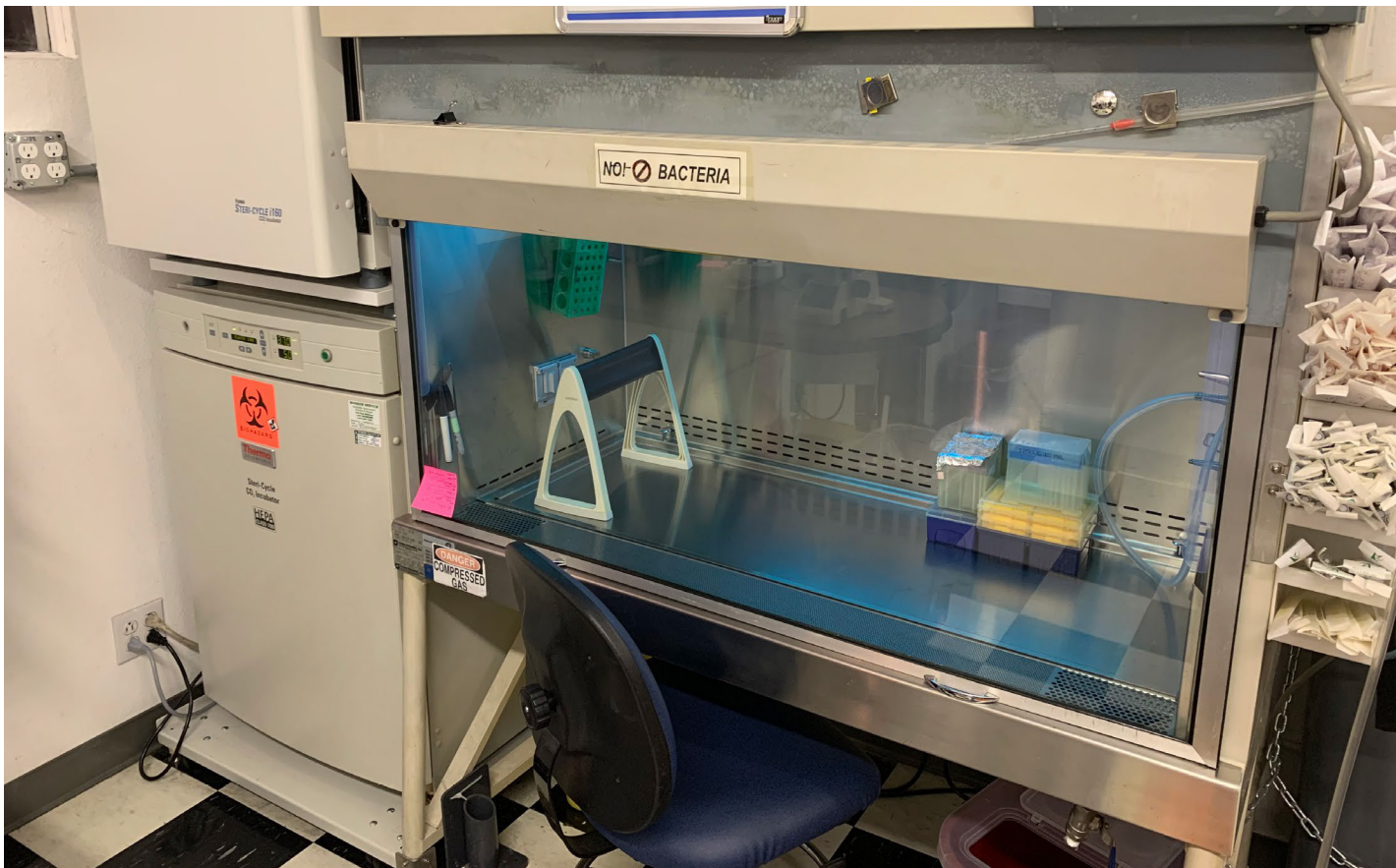

2ND FLOOR FLOOR PLAN

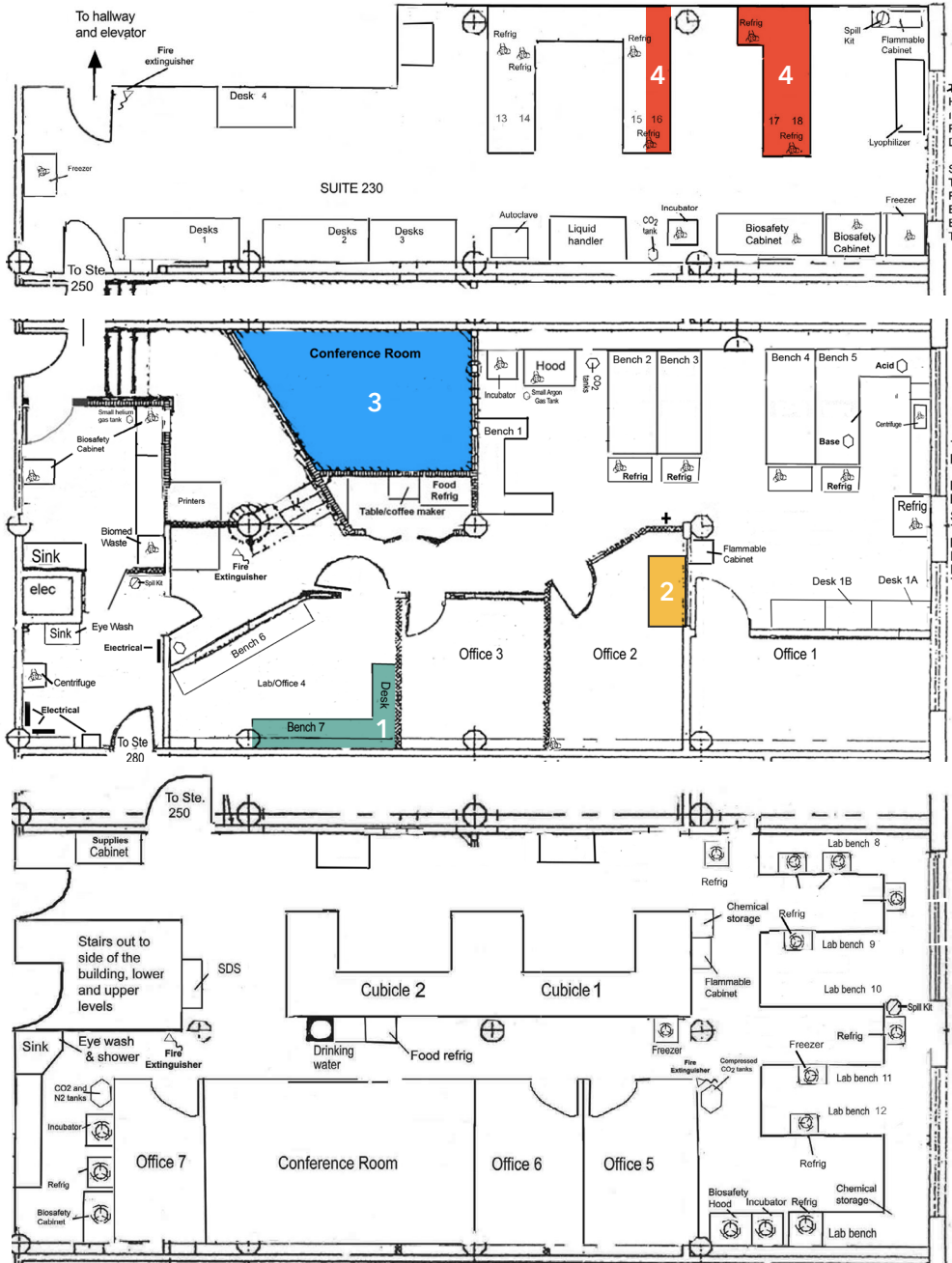

FLOOR PLAN KEY

- 1 Bench #7 + Lab Desk in Lab #4
- 2 Seating for 1 in Office 2 (shared)
- 3 Seating for 1-4 in Conference Room Office
- 4 Benches #16, 17, & 18



BIOSCIENCES LABORATORIES

AT 665 3RD STREET, SAN FRANCISCO, CA

LAB BENCHES & OFFICE SPACE AVAILABLE



ANDREW WHEELER

CA BRE # 02048909
andrew.wheeler@transwestern.com
415.489.1831

MAIRAJ DIN

CA BRE # 02197939
mairaj.din@transwestern.com
415.489.1769



COPYRIGHT © 2023 TRANSWESTERN. CALIFORNIA BROKERAGE LIC #01263636.
ALL DATA IS DERIVED FROM SOURCES DEEMED TO BE RELIABLE BUT IS NOT GUARANTEED.