

RETAIL PROPERTY FOR LEASE

AGUA CALIENTE

6990 E Shea Blvd | Scottsdale, AZ 85254

BRYAN LEDBETTER

602.795.8670

bledbetter@w-retail.com

KATIE WEEKS

602.368.1372

kweeks@w-retail.com

WESTERN RETAIL ADVISORS

2555 E Camelback Rd, Suite 200

Phoenix, AZ 85016

602.778.3747 | w-retail.com

AGUA CALIENTE

6990 E Shea Blvd | Scottsdale, AZ



PROPERTY HIGHLIGHTS

- **2,858 SF First Floor Space Available - Amazing Patio Opportunity!**
- **505 SF Second Floor Space Available**
- Located in the heart of central Scottsdale, just minutes from Paradise Valley, Gainey Ranch and McCormick Ranch.
- Dynamic mix of restaurants, retailers and business services.
- Shopping Center caters to an affluent demographic and significant tourist population.
- Approximately 1/2 of a mile north of Chaparral High School with more than 2,200 students.
- Over 85K VPD at the intersection of Scottsdale Rd & Shea Blvd.
- 196 Unit High End Multi-Family Project Planned Adjacent to the Center
- New Modern Paint Scheme just completed!

AREA CO-TENANTS



The information contained within this brochure has been obtained from sources other than Western Retail Advisors, LLC. Western Retail Advisors have not verified such information and make no guarantee, warranty, or representation about such information. It is your responsibility to independently confirm its accuracy and completeness. Any dimensions, specifications, floor plans, and information may not be accurate and should be verified by you prior to the lease or purchase of the property.

AGUA CALIENTE

6990 E Shea Blvd | Scottsdale, AZ



LEGEND

Available

Unavailable

The information contained within this brochure has been obtained from sources other than Western Retail Advisors, LLC. Western Retail Advisors have not verified such information and make no guarantee, warranty, or representation about such information. It is your responsibility to independently confirm its accuracy and completeness. Any dimensions, specifications, floor plans, and information may not be accurate and should be verified by you prior to the lease or purchase of the property.

AGUA CALIENTE

6990 E Shea Blvd | Scottsdale, AZ

AVAILABLE SPACES

SUITE	TENANT	SIZE	DESCRIPTION	PLANS/PHOTOS
101	EGGSTASY	4,000 SF	-	-
102	KIDSTOP TOYS & BOOKS	3,866 SF	-	-
104	PHOENIX CHILDREN'S HOSPITAL	5,900 SF	-	-
106	ALLORA GELATO	565 SF	-	-
107	WULFENITE TEA & ELIXIR	975 SF	-	-
108	KARMA LAGREE AND LIFESTYLE STUDIO	4,060 SF	-	-
110	Available	2,858 SF	AMAZING PATIO OPPORTUNITY	View Here
111	FIRST IMPRESSION IRONWORKS	1,656 SF	-	-
112	ARCTIC ELEVATION	1,997 SF	-	-
114	STRICTLY CHIROPRACTIC	881 SF	-	-
116	ZAK'S CHOCOLATE	2,442 SF	-	-
120	BRIGHTMONT ACADEMY	7,476 SF	-	-
124	BRIGHTMONT ACADEMY	2,604 SF	-	-
125	HAUTE HAIR EXTENSIONS	943 SF	-	-
126	AJO AL'S MEXICAN CAFE	4,383 SF	-	-
215	ARTHUR MURRAY DANCE STUDIO	2,646 SF	-	-
217	Available	505 SF	SECOND FLOOR	View Here
218	EGGSTASY OFFICE	998 SF	-	-

The information contained within this brochure has been obtained from sources other than Western Retail Advisors, LLC. Western Retail Advisors have not verified such information and make no guarantee, warranty, or representation about such information. It is your responsibility to independently confirm its accuracy and completeness. Any dimensions, specifications, floor plans, and information may not be accurate and should be verified by you prior to the lease or purchase of the property.

AGUA CALIENTE

6990 E Shea Blvd | Scottsdale, AZ

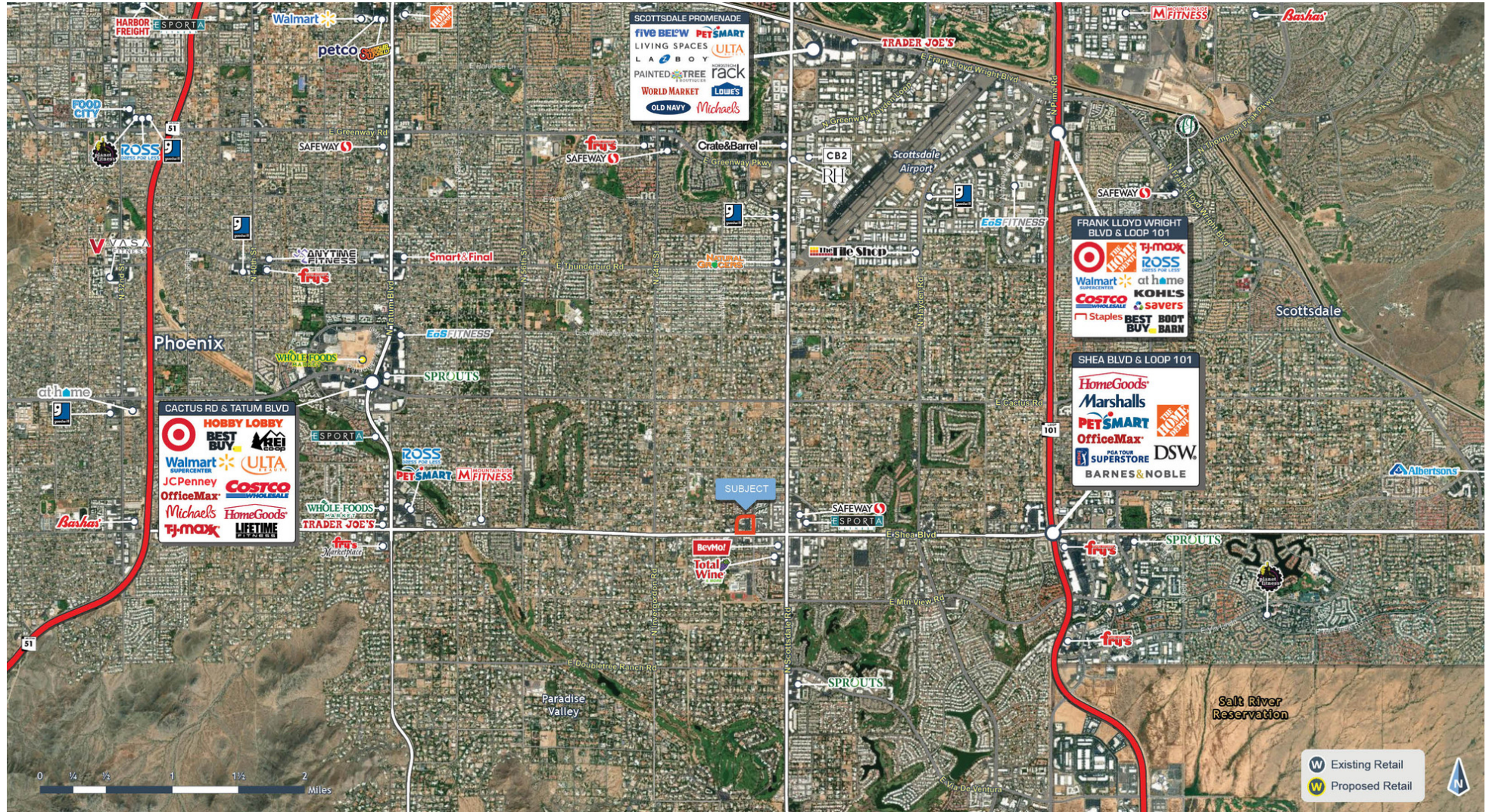

The information contained within this brochure has been obtained from sources other than Western Retail Advisors, LLC. Western Retail Advisors have not verified such information and make no guarantee, warranty, or representation about such information. It is your responsibility to independently confirm its accuracy and completeness. Any dimensions, specifications, floor plans, and information may not be accurate and should be verified by you prior to the lease or purchase of the property.

AGUA CALIENTE

6990 E Shea Blvd | Scottsdale, AZ



POPULATION

	1 MILE	3 MILES	5 MILES
Area Total	7,343	59,514	191,561
Median Age	49.2	50.7	47.2



HOUSEHOLD INCOME

	1 MILE	3 MILES	5 MILES
Median	\$104,743	\$142,428	\$119,238
Average	\$193,776	\$217,889	\$183,355



DAYTIME WORKFORCE

	1 MILE	3 MILES	5 MILES
Total Businesses	782	6,973	14,471
Employees	6,675	73,311	164,537



EDUCATION

	1 MILE	3 MILES	5 MILES
Percentage with Degrees	68.04%	70.92	67.97%



EMPLOYMENT

	1 MILE	3 MILES	5 MILES
White Collar	76.06%	82.17%	80.50%
Services	9.83%	8.40%	10.30%
Blue Collar	14.09%	9.43%	9.20%



HOUSEHOLD STATISTICS

	1 MILE	3 MILES	5 MILES
Households	3,421	25,902	87,425
Median Home Value	\$857,091	\$818,303	\$699,483

*2025 Demographic data derived from ESRI

The information contained within this brochure has been obtained from sources other than Western Retail Advisors, LLC. Western Retail Advisors have not verified such information and make no guarantee, warranty, or representation about such information. It is your responsibility to independently confirm its accuracy and completeness. Any dimensions, specifications, floor plans, and information may not be accurate and should be verified by you prior to the lease or purchase of the property.