

BASIS OF BEARINGS

THE BEARINGS SHOWN HEREON ARE BASED UPON THE BEARINGS SHOWN IN BOOK 43 OF MAPS AT PG.13 (R1)

LEGEND

- 3/4" IRON PIPE WITH MHM L.S. 3341 CAP PER R1
- SET 3/4" PIPE WITH PLUG STAMPED MHM L.S. 3341 OR AS NOTED
- CALCULATED POINT
- R1 BOOK 43 MAPS, PAGE 13, YUBA COUNTY RECORDS

SURVEYOR'S STATEMENT

THIS MAP CORRECTLY REPRESENTS A SURVEY MADE BY ME OR UNDER MY DIRECTION IN CONFORMANCE WITH REQUIREMENTS OF THE LAND SURVEYOR'S ACT AT THE REQUEST OF THOMAS FAWCETT IN NOVEMBER, 2006.

EDGAR C. HANLIN
L.S. 3341

DATE



COUNTY SURVEYOR'S STATEMENT

THIS MAP HAS BEEN EXAMINED IN ACCORDANCE WITH SECTION 8766 OF THE LAND SURVEYOR'S ACT THIS _____ DAY OF _____, 2007

GARY T. LIPPINCOTT, P.L.S. 3634
COUNTY SURVEYOR, YUBA COUNTY
LICENSE EXPIRES, JUNE 30, 2008



RECORDER'S STATEMENT

FILED THIS _____ DAY OF _____, 2007, AT _____ M.
IN BOOK _____ OF MAPS, AT PAGE _____, AT THE REQUEST OF
TOM FAWCETT

TERRY A. HANSEN
YUBA COUNTY RECORDER

FILE NO. _____

BY: _____

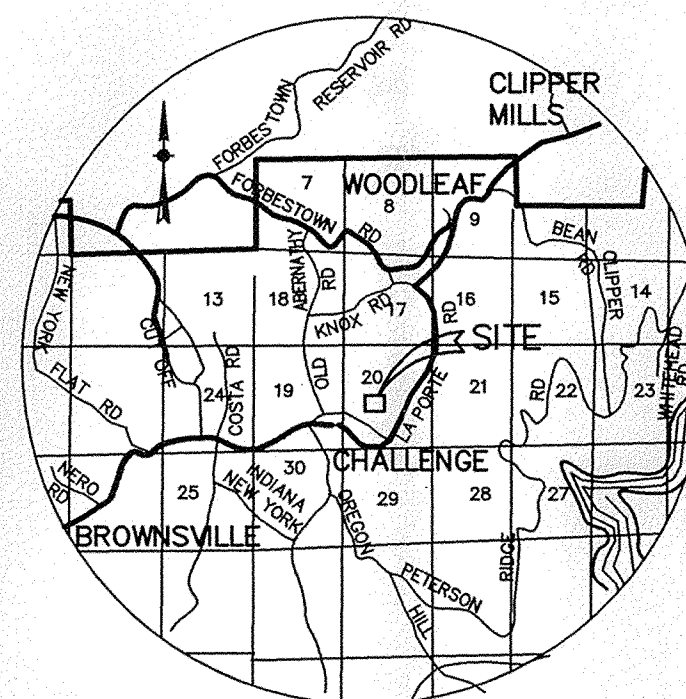

VICINITY MAP
NOT TO SCALE

THE PURPOSE OF THIS SURVEY IS TO SHOW THE PARCELS AS DETERMINED BY LOT LINE ADJUSTMENT NO. 2006-26.

RECORD OF SURVEY NO. 2007-XX FOR THOMAS FAWCETT.

BEING A PORTION OF THE SOUTHWEST QUARTER OF SECTION 20
T.19 N., R.7 E., M.D.M.

COUNTY OF YUBA
CALIFORNIA

OCTOBER 2007
SCALE 1"=100'

PREPARED BY: MHM INC., 523 "J" STREET, MARYSVILLE, CALIF. 95901
06604ROS SHEET 1 OF 1