



# 535 Connecticut Avenue

Norwalk, CT

10,114 - 16,660 RSF  
SUBLEASE

## PROPERTY HIGHLIGHTS

- 10,114 – 16,660 RSF on the 3rd floor
- Sublease term through 10/1/2023 or 12/31/2024
- Price – Negotiable
- 7 parking spaces per 1,000 SF leased
- Recently renovated
- Open plan, glass finishes
- Furniture available

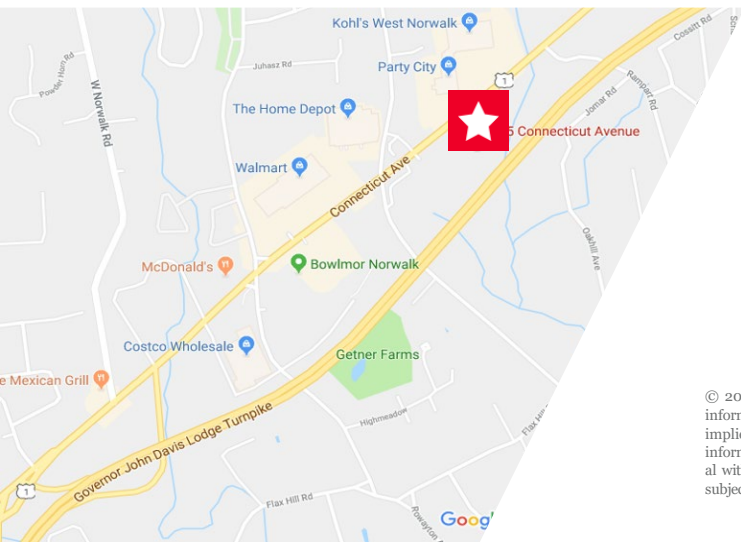

**WILLIAM MONTAGUE**  
 +1 203 326 5865  
 william.montague@cushwake.com

107 Elm Street, 8<sup>th</sup> Floor | Stamford, CT Main +1 203 326 5800  
 cushmanwakefield.com

© 2022 Cushman & Wakefield. All rights reserved. The information contained in this communication is strictly confidential. This information has been obtained from sources believed to be reliable but has not been verified. No warranty or representation, express or implied, is made as to the condition of the property (or properties) referenced herein or as to the accuracy or completeness of the information contained herein, and same is submitted subject to errors, omissions, change of price, rental or other conditions, withdrawal without notice, and to any special listing conditions imposed by the property owner(s). Any projections, opinions or estimates are subject to uncertainty and do not signify current or future property performance.

# 535 Connecticut Avenue

Norwalk, CT

10,114 -16,660 RSF SUBLEASE

## SPACE PHOTOS

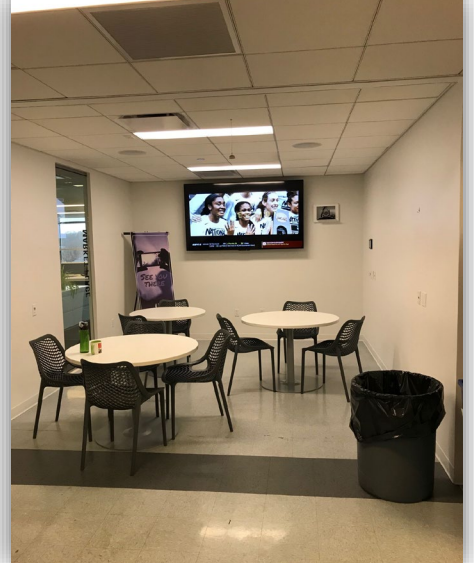

**WILLIAM MONTAGUE**

+1 203 326 5865

[william.montague@cushwake.com](mailto:william.montague@cushwake.com)

# 535 Connecticut Avenue

Norwalk, CT

10,114 -16,660 RSF SUBLEASE

## FLOOR PLAN

**10,114 – 16,660 RSF**

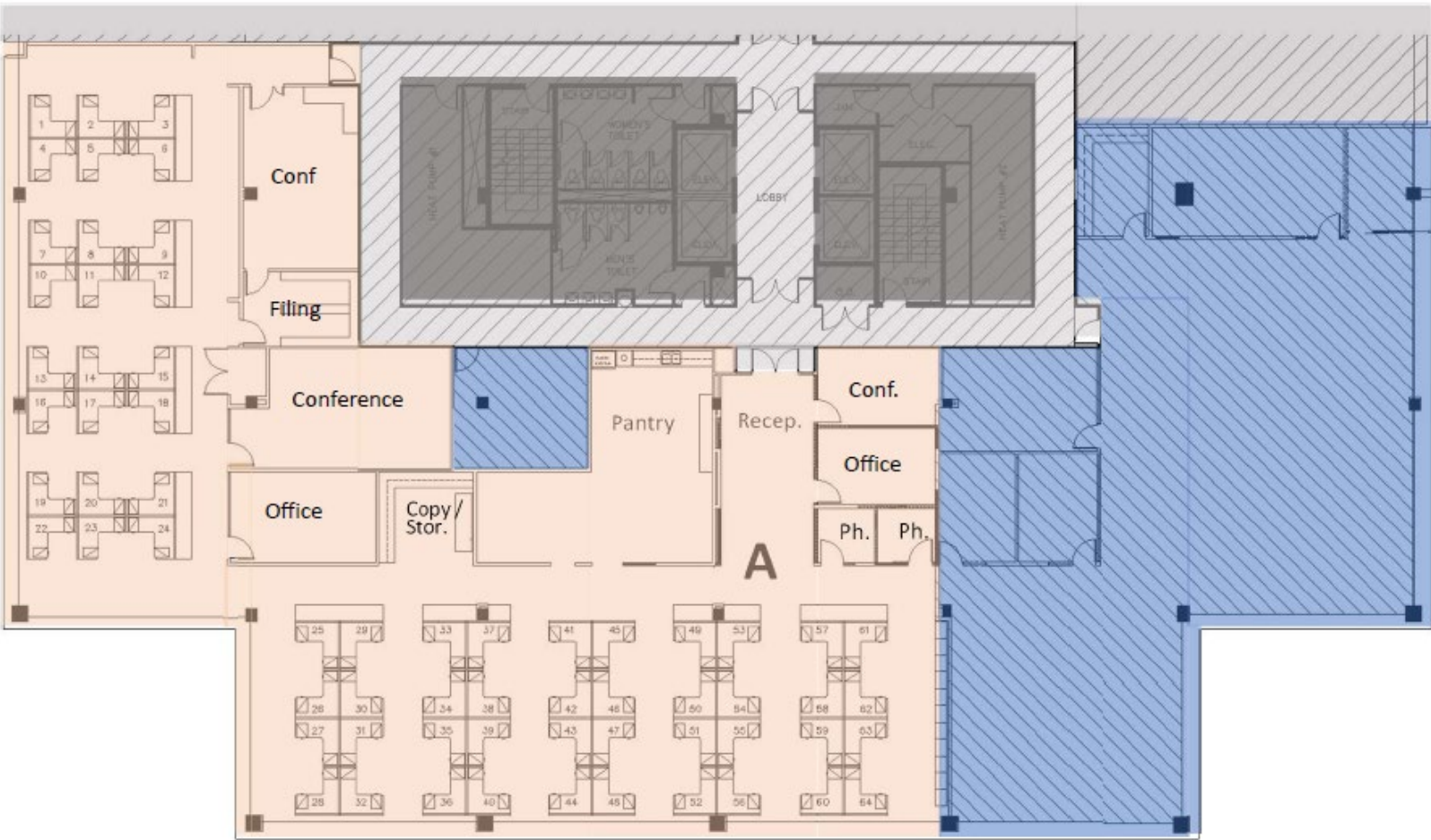

**10,114 RSF**

**6,546 RSF**

**WILLIAM MONTAGUE**

+1 203 326 5865

[william.montague@cushwake.com](mailto:william.montague@cushwake.com)