

INVESTMENT OPPORTUNITY

515 E. WASHINGTON ST., SHREVEPORT, LA 71104

OFFICE BUILDING FOR SALE

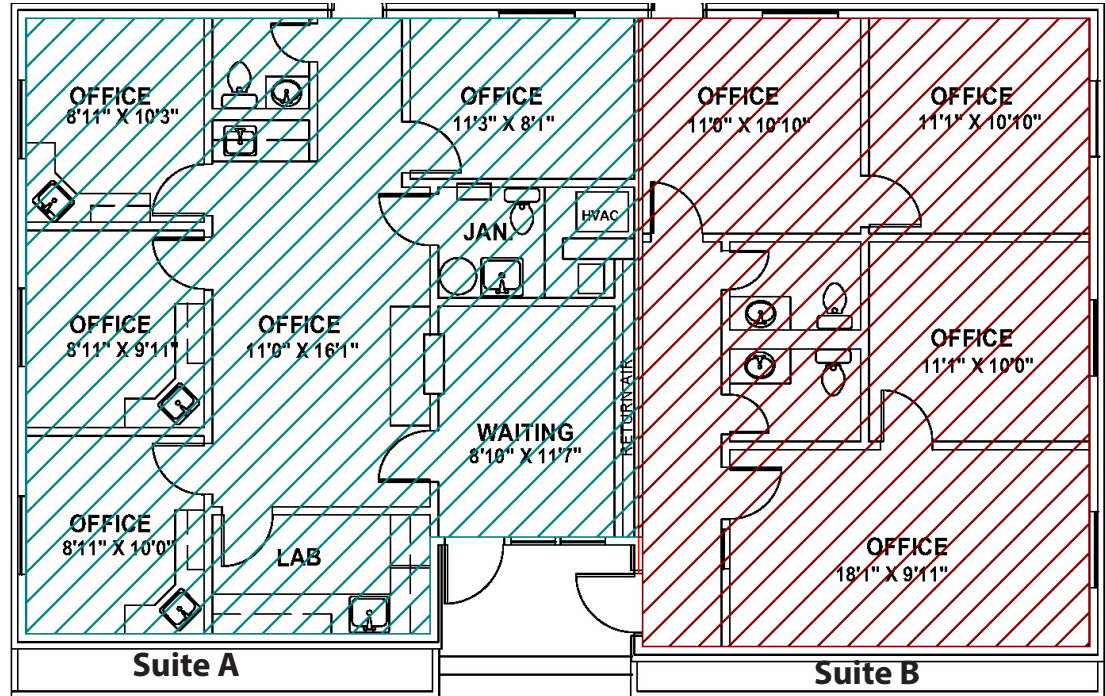

- Small office building available directly off of Youree Drive
- 1,731 sq.ft.
- Currently divided into two separate spaces
- Approximately 908 square feet and 720 square feet
- Near signalized intersection at E. Washington and Youree Drive

- Buyer can occupy one space and lease separate office space to gain rentable income or potential investor can lease both spaces
- Location provides any business with good visibility
- Exterior signage on E. Washington Street
- Offering price: \$165,000



For more information, contact:

Michele Sauls, Associate Broker | 318.222.2244
msauls@vintagerealty.com | vintagerealty.com

ALL INFORMATION CONTAINED HEREIN IS BELIEVED TO BE ACCURATE, BUT IS NOT WARRANTED AND NO LIABILITY OF ERRORS OR OMISSIONS IS ASSURED BY EITHER THE PROPERTY OWNER OR VINTAGE REALTY COMPANY OR ITS AGENTS AND EMPLOYEES. PRICES AS STATED HEREIN AND PRODUCT AVAILABILITY IS SUBJECT TO CHANGE AND/OR SALE OR LEASE WITHOUT PRIOR NOTICE, AND ALL SIZES AND DIMENSIONS ARE SUBJECT TO CORRECTION. REV 5/2026

INVESTMENT OPPORTUNITY

515 E. WASHINGTON ST., SHREVEPORT, LA 71104

OFFICE BUILDING FOR SALE

NEIGHBORHOOD AERIAL



For more information, contact:

Michele Sauls, Associate Broker | 318.222.2244
msauls@vintagerealty.com | vintagerealty.com

ALL INFORMATION CONTAINED HEREIN IS BELIEVED TO BE ACCURATE, BUT IS NOT WARRANTED AND NO LIABILITY OF ERRORS OR OMISSIONS IS ASSURED BY EITHER THE PROPERTY OWNER OR VINTAGE REALTY COMPANY OR ITS AGENTS AND EMPLOYEES. PRICES AS STATED HEREIN AND PRODUCT AVAILABILITY IS SUBJECT TO CHANGE AND/OR SALE OR LEASE WITHOUT PRIOR NOTICE, AND ALL SIZES AND DIMENSIONS ARE SUBJECT TO CORRECTION. 5/2026