

747

CAMBRIDGE STREET



1,572 SF Retail Condo for Lease or Sale



747 Cambridge Street presents a rare opportunity to lease or purchase 1,572 square feet of brand-new ground floor retail in the heart of Cambridge, Massachusetts. Situated at the base of a newly constructed 7-unit apartment building, the space benefits from built-in residential density, strong daily foot traffic, and excellent visibility along one of Cambridge's most well-traveled neighborhood corridors.

The space offers a modern storefront with high ceilings, new building systems, and flexible floor plans ideal for a wide range of neighborhood-serving retail uses, including café, specialty food, personal services, medical, wellness, or boutique concepts. Located along Cambridge Street, the property enjoys consistent pedestrian and vehicular traffic, strong surrounding demographics, and proximity to established residential neighborhoods, public transit, and major Cambridge employment hubs.

With new construction, prominent street presence, and a highly walkable location, 747 Cambridge Street is ideally positioned for retailers seeking long-term stability in a supply-constrained urban market.

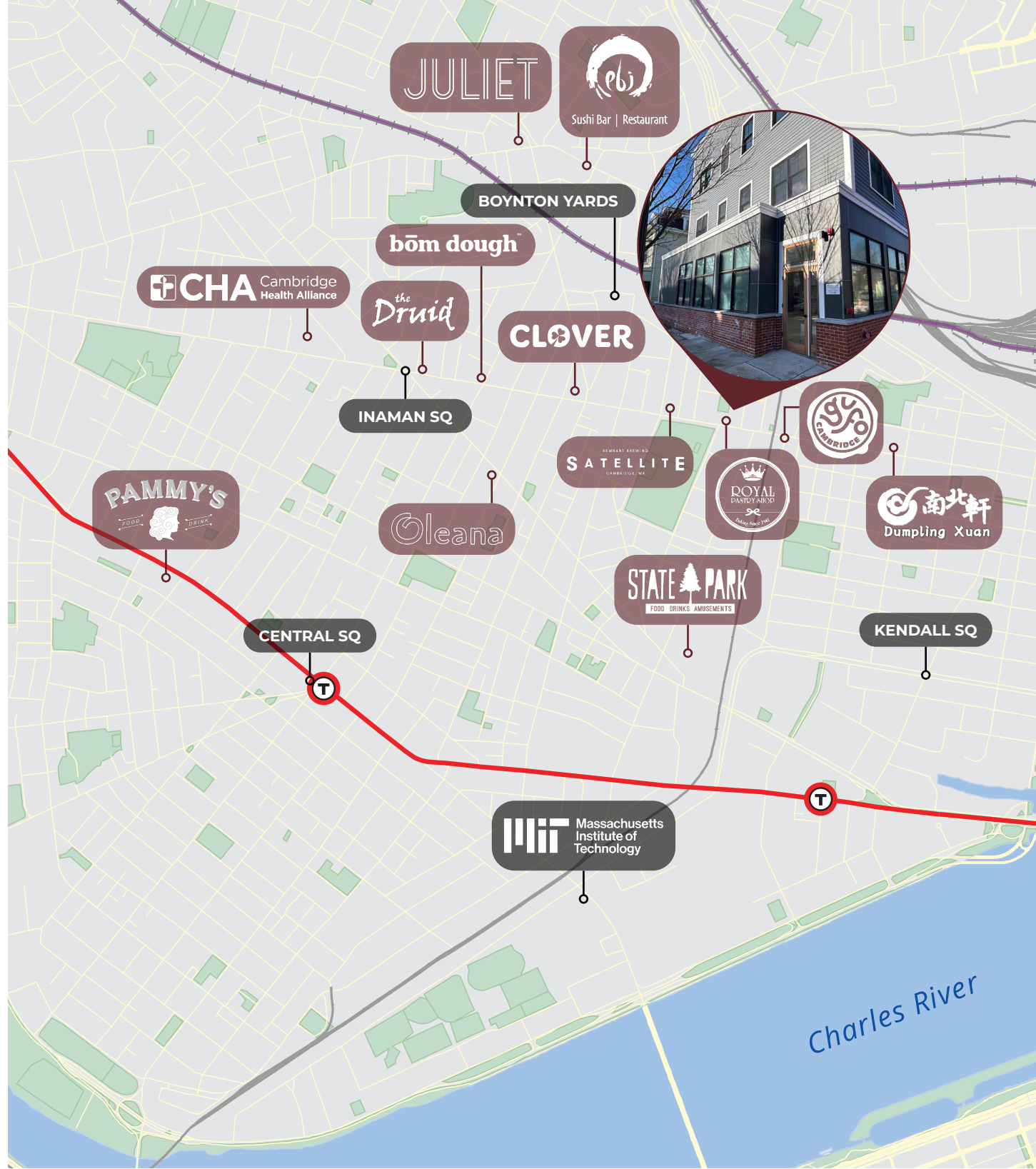

DEMOGRAPHICS

	1 MILE	3 MILES	5 MILES
Population (2024)	57,682	498,766	985,495
Median Age	33.5	33.1	34.4
Avg. Household Income	\$138,200	\$130,150	\$124,598

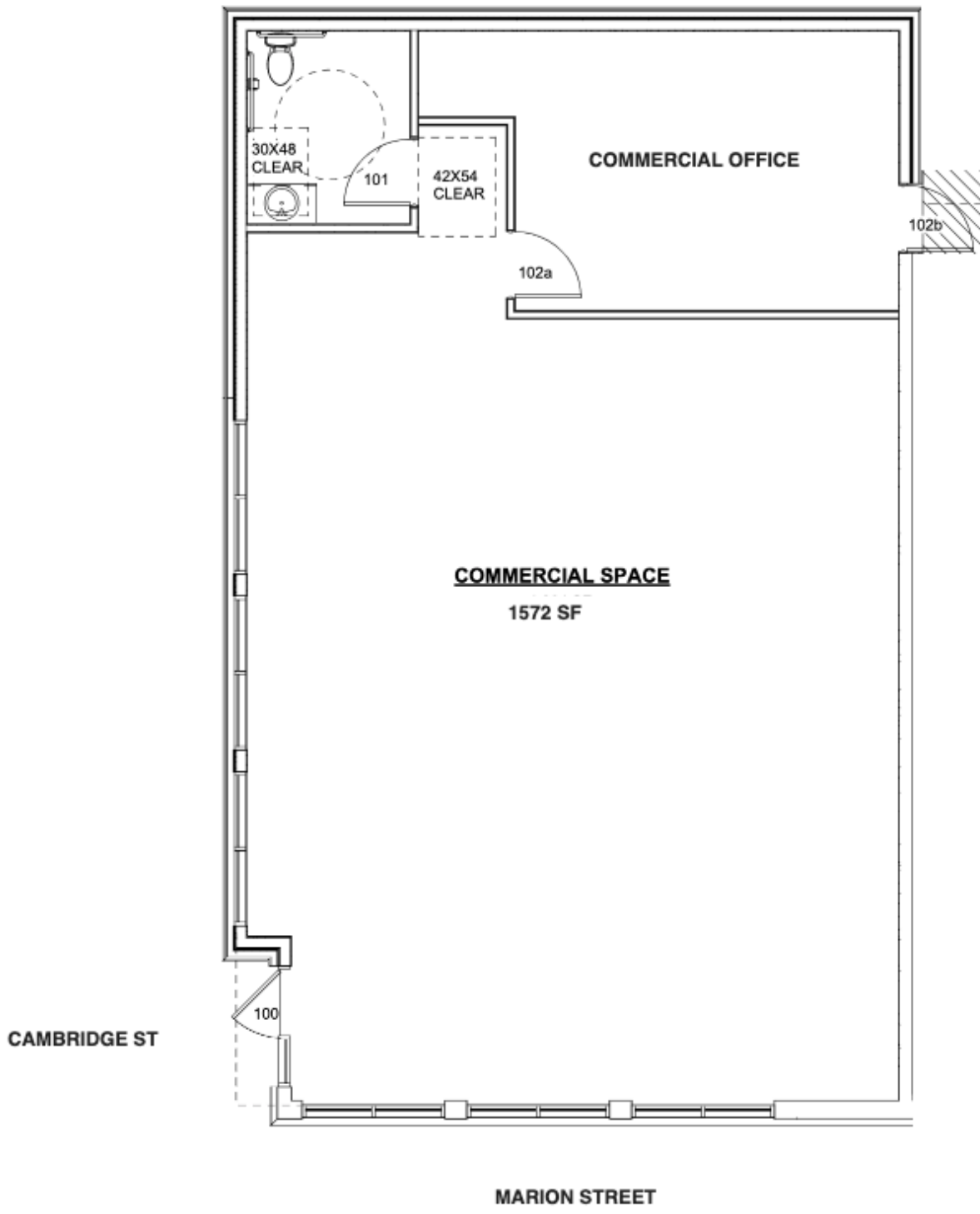

FLOOR PLAN
1,572 SF

747

CAMBRIDGE STREET



WHITNEY GALLIVAN

Senior Managing Director & Partner
617.850.9612
wgallivan@bradvisors.com

JOE WAGNER

Managing Director
617.850.9675
jwagner@bradvisors.com

GUS HOFFMANN

Senior Associate
617.448.5055
ahoffmann@bradvisors.com

LUKE SWEENEY

Retail Associate
401.601.1145
lsweeney@bradvisors.com



136 Newbury Street | Boston, MA | 617.375.7900 | BRAdvisors.com

© Copyright Boston Realty Advisors. All rights reserved. The information contained here has been obtained through sources deemed reliable but cannot be guaranteed as to its accuracy. Any information of special interest should be obtained through independent verification.