

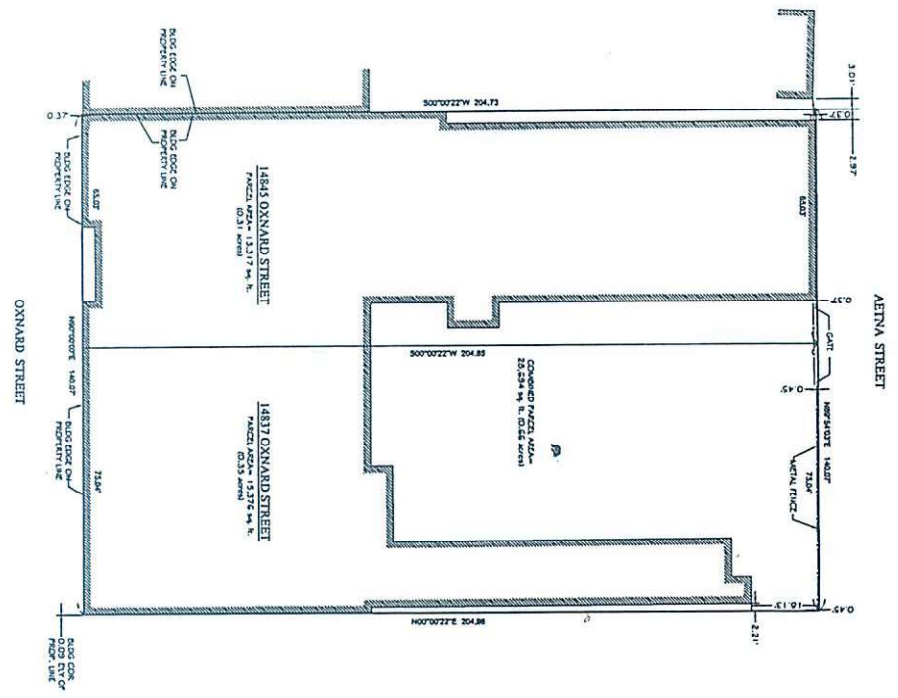

**LEGAL DESCRIPTION**  
 THE INTERSECTION OF LOT 51 OF THE SEVEN (7) TRACT OF LOT 5, (10) ADDITION TO SECTION 28, TOWNSHIP 11N, RANGE 13E, S17E, DISTRICT 12, SAN BERNARDINO COUNTY, CALIFORNIA, AND THE SEVEN (7) TRACT OF LOT 5, (10) ADDITION TO SECTION 28, TOWNSHIP 11N, RANGE 13E, S17E, DISTRICT 12, SAN BERNARDINO COUNTY, CALIFORNIA.



NOTED DISTANCES SHOWN HEREON ARE PRINTED IN FEET AND DECIMAL FRACTIONS.

**SURVEYOR'S NARRATIVE**  
 AT THE REQUEST OF THE CLIENT, THIS SURVEY WAS PERFORMED FOR THE PURPOSE OF ESTABLISHING THE BOUNDARIES OF THE SEVEN (7) TRACT OF LOT 5, (10) ADDITION TO SECTION 28, TOWNSHIP 11N, RANGE 13E, S17E, DISTRICT 12, SAN BERNARDINO COUNTY, CALIFORNIA, AND THE SEVEN (7) TRACT OF LOT 5, (10) ADDITION TO SECTION 28, TOWNSHIP 11N, RANGE 13E, S17E, DISTRICT 12, SAN BERNARDINO COUNTY, CALIFORNIA.

**SURVEYOR'S CERTIFICATE**  
 I, KACE A. PLOUFF, CERTIFY THAT I AM LICENSED AS A PROFESSIONAL LAND SURVEYOR IN THE STATE OF CALIFORNIA, LICENSE NO. 5013. I HAVE PERSONALLY CONDUCTED THIS SURVEY AND I AFFIRM THAT THE RESULTS THEREOF ARE TRUE AND CORRECT TO THE BEST OF MY KNOWLEDGE AND BELIEF.



**BUILDING & BOUNDARY EXHIBIT**  
 16-XX-XX  
 1 OF 1

14837 & 14845 OXNARD STREET  
 CITY & COUNTY OF LOS ANGELES  
 STATE OF CALIFORNIA  
 APN'S: 2241-025-019 & 020

DATE: 07/16/18  
 DRAWING SCALE: 1" = 10'  
 PREPARED BY: KACE PLOUFF  
 APPROVED BY: KACE PLOUFF  
 FILE NAME: CA-18-001

**CHRISTENSEN & PLOUFF**  
 LAND SURVEYING  
 17417 REDWOOD CIRCLE, #6  
 PALMDALE, CA 93550  
 (805) 495-5799