

3.4 Acres Big Beaver Rd. Troy

Big Beaver Rd. Between
John R and Rochester Rd.



PREMIER
Realty Services, LLC

FOR SALE



Join:

CONTACT:

Premier Realty Services, LLC
2600 Auburn Rd. Suite 240
Auburn Hills, Mi 48326
Office: 248.419.5567
Fax: 248-419-5555
www.prscree.com



3.4 Acres Big Beaver Rd. Troy

Big Beaver Rd. Between
John R and Rochester Rd.



PREMIER
Realty Services, LLC

SUMMARY

Property Highlights

This prime development land is located in the city of Troy, Mi. This land is located on one of the most travelled corridors in southeast Michigan. This parcel is surrounded by office, industrial and residential areas. This parcel provides easy access to I-75. This site would be ideal for restaurants, offices, hotel, banks, mixed use development and much more!

Demographics

	1 Mi	3 Mi
Population	10,123	100,126
Households	3,814	38,400
Median HH Income	\$84,847	\$72,898
Daytime Employess	10,083	81,089

Traffic

Collection Street	Cross Street	Traffic Vol	Year
E Big Beeaver Rd	Bellingham Dr E	52,918	2018
Bellingham Dr	E Big Beaver Rd	3,766	2018
E Big Beaver Rd	John R Rd E	63,587	2018
John R Rd	E Big Beaver Rd	21,091	2018
John R Rd	E Big Beaver Rd	31,956	2018

3.4 Acres Big Beaver Rd. Troy

Big Beaver Rd. Between
John R and Rochester Rd.



PREMIER
Realty Services, LLC

PLAT MAP

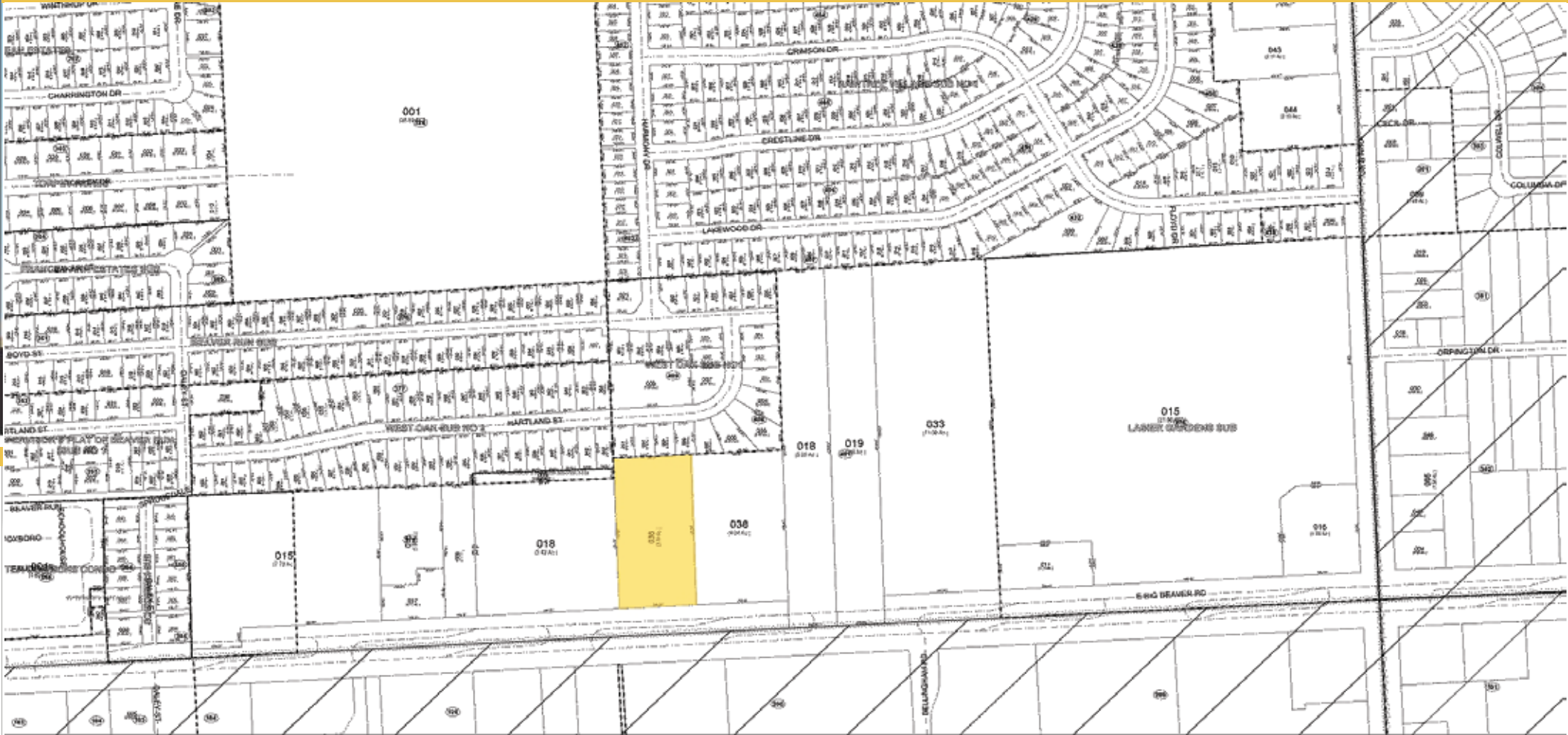

Premier Realty Services, LLC
2600 Auburn Rd. Suite 240
Auburn Hills, Mi 48326

Office: 248.419.5567
Fax: 248-419-5555
www.prscres.com

3.4 Acres Big Beaver Rd. Troy

Big Beaver Rd. Between
John R and Rochester Rd.



PREMIER
Realty Services, LLC

SURVEY

