

4,800 SF Endcap  
Available

Paris Nails and Spa  
Coming Soon!



ENDCAP AVAILABLE



# WALMART ANCHORED

3168 S Western Ave  
Marion, IN 46953

4,800 SF

## PROPERTY HIGHLIGHTS

High-profile endcap in  
Valley View Shopping Center

Highly-visible pylon sign panel

**Lease price \$16.00/SF NNN**

Signalized access

Neighboring tenants include Dollar Tree,  
Goodwill, Cato and Cricket Wireless



### BILL FRENCH

Executive Director  
+1 317 639 0430

[bill.french@cushwake.com](mailto:bill.french@cushwake.com)

One American Square, Suite 1800 | Indianapolis, IN  
Main +1 317 639 0515 | Fax +1 317 639 0504  
[cushmanwakefield.com](http://cushmanwakefield.com)

©2025 Cushman & Wakefield. All rights reserved. The information contained in this communication is strictly confidential. This information has been obtained from sources believed to be reliable but has not been verified. No warranty or representation, express or implied, is made as to the condition of the property (or properties) referenced herein or as to the accuracy or completeness of the information contained herein, and same is submitted subject to errors, omissions, change of price, rental or other conditions, withdrawal without notice, and to any special listing conditions imposed by the property owner(s). Any projections, opinions or estimates are subject to uncertainty and do not signify current or future property performance.



# VALLEY VIEW SHOPPING CENTER

3168 S Western Avenue, Marion IN

4,800 SF ENDCAP



# VALLEY VIEW SHOPPING CENTER

3168 S Western Avenue, Marion IN

**4,800 SF ENDCAP**

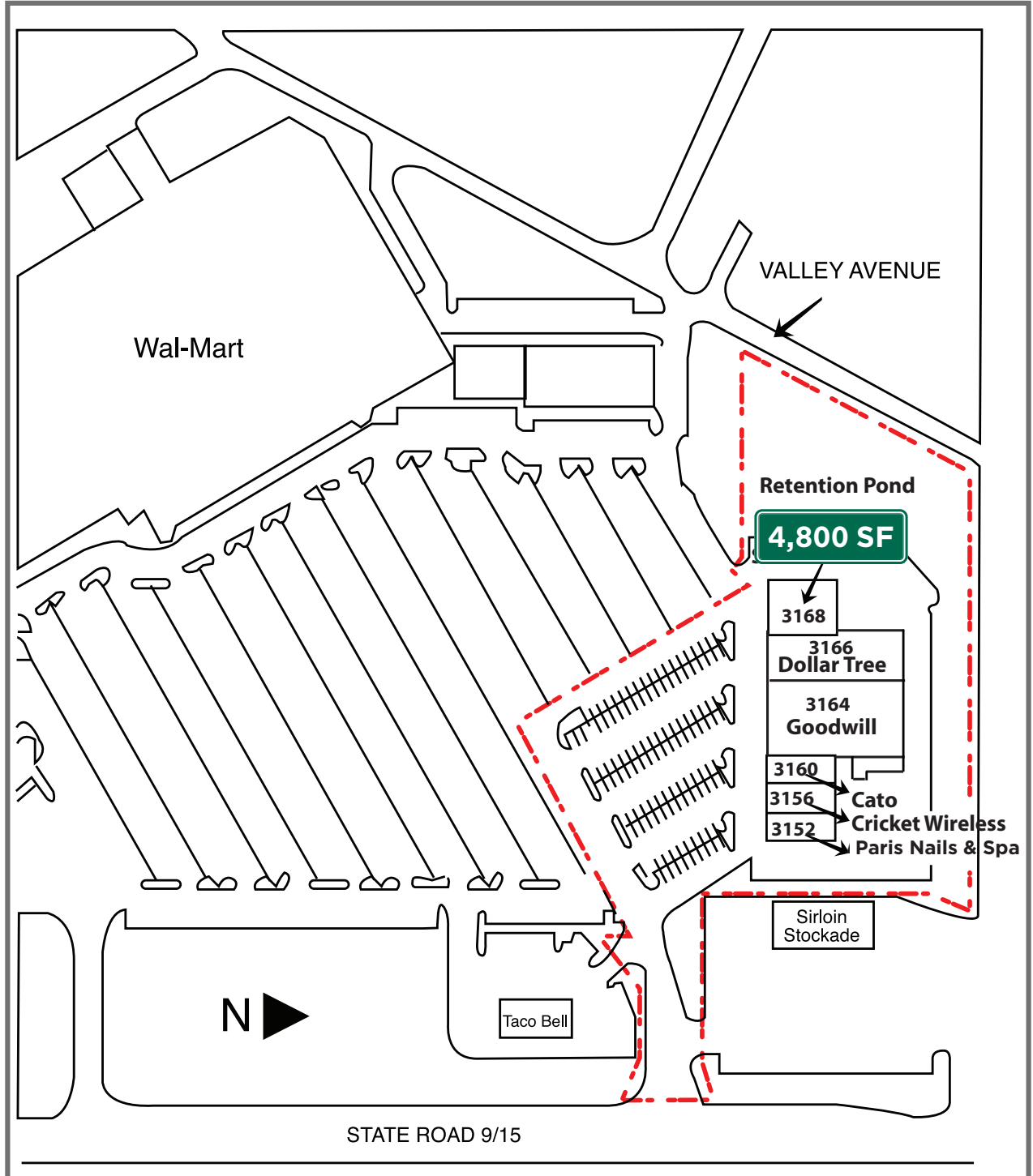



# VALLEY VIEW SHOPPING CENTER

3168 S Western Avenue, Marion IN

4,800 SF ENDCAP

## DEMOGRAPHICS

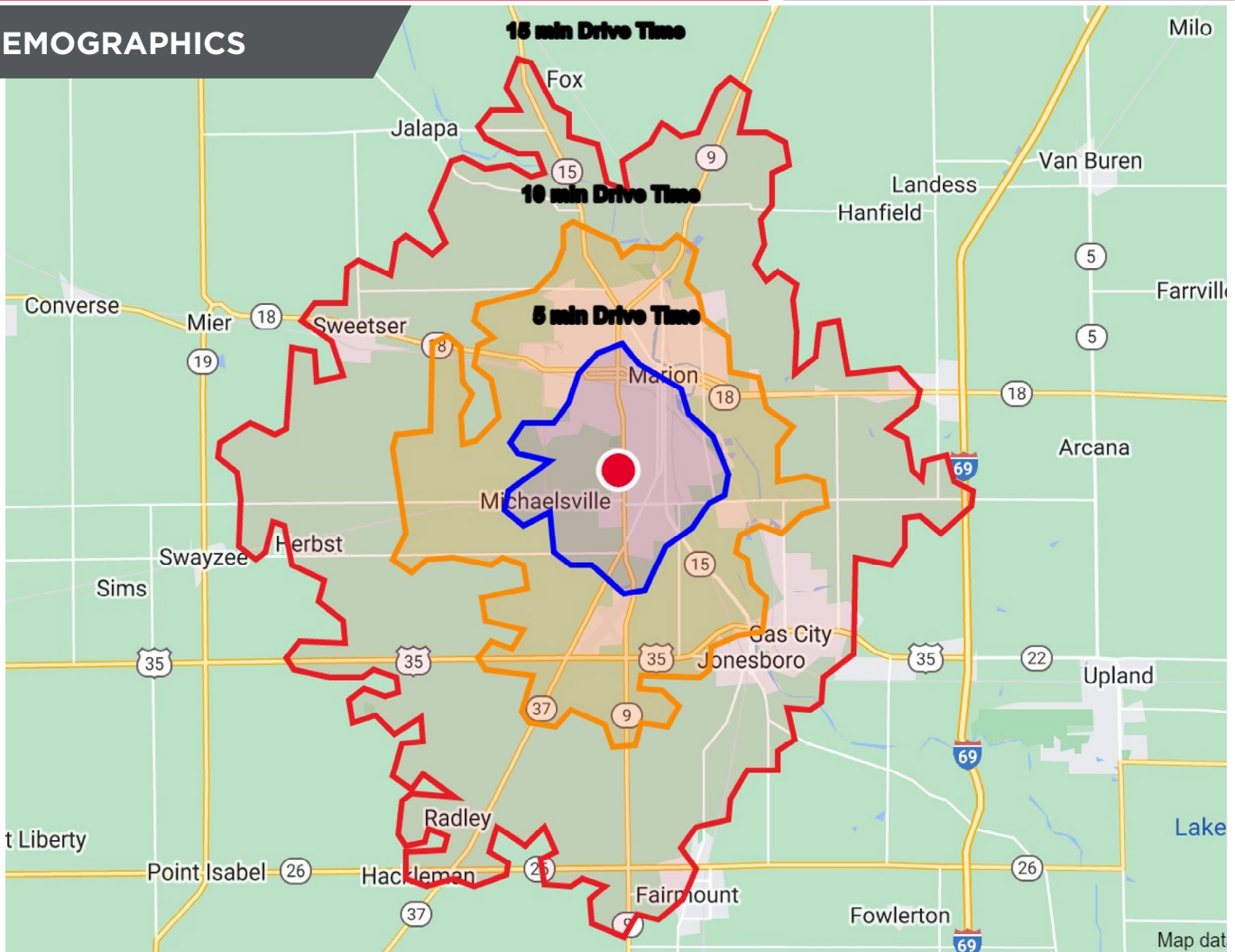

### Drivetime Demographics

	5 Minute	10 Minute	15 Minute
Population	17,813	32,643	47,154
AVG. HH Income	\$53,962	\$60,882	\$63,945
Daytime Population	17,369	34,455	42,337

### Traffic Counts

Western Avenue 24,007 AADT

**BILL FRENCH**  
Executive Director  
+1 317 639 0430  
bill.french@cushwake.com

One American Square,  
Suite 1800  
Indianapolis, IN 46282  
Main +1 317 639 0515  
[cushmanwakefield.com](http://cushmanwakefield.com)