

PARKWAY COMMONS

Bullhead Pkwy, Bullhead City, AZ 86429

Parkway Commons is Bullhead City, AZ & Laughlin, NV's newest retail, office, and flex space opportunity located on Bullhead Parkway near the airport.

PARKWAY COMMONS

Bullhead Pkwy, Bullhead City, AZ 86429



PROPERTY | RESOURCES GROUP

www.PropertyResourcesGroup.com
4265 45th Street South, Suite 200
Fargo, North Dakota 58104

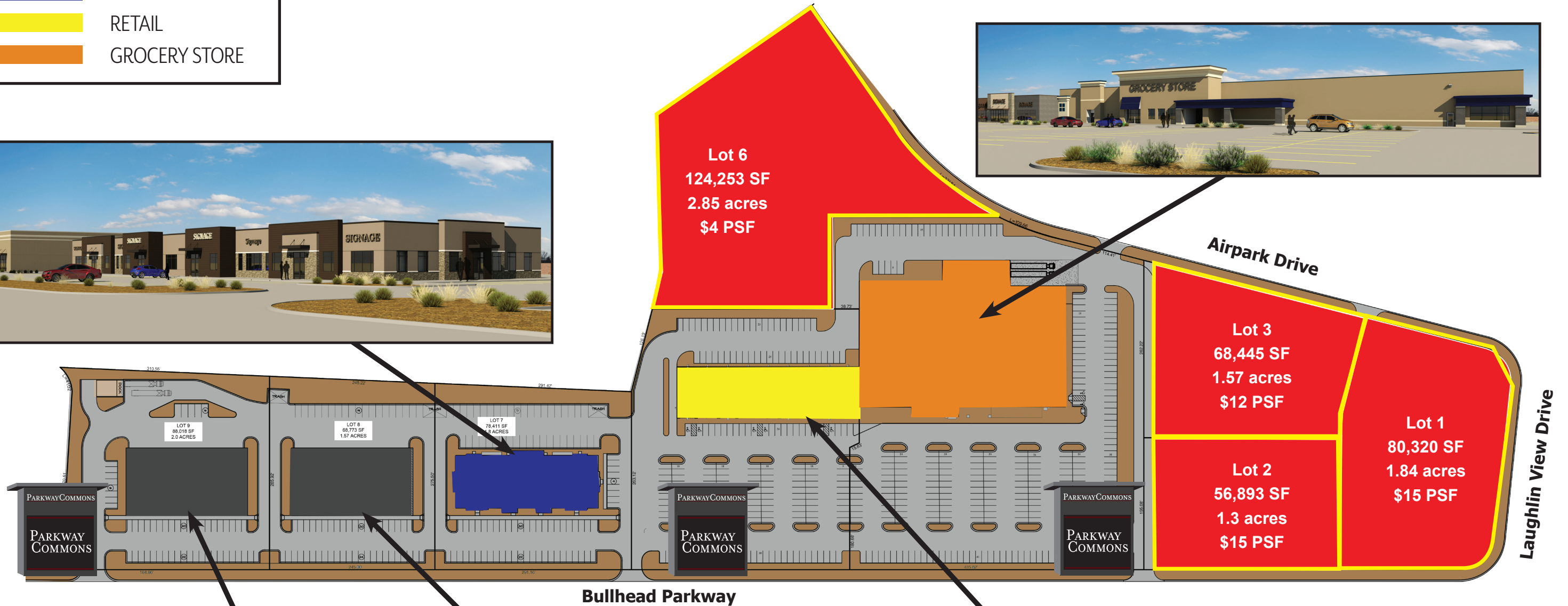

PARKWAY COMMONS

Bullhead Pkwy, Bullhead City, AZ 86429



www.PropertyResourcesGroup.com
4265 45th Street South, Suite 200
Fargo, North Dakota 58104



Flex Space

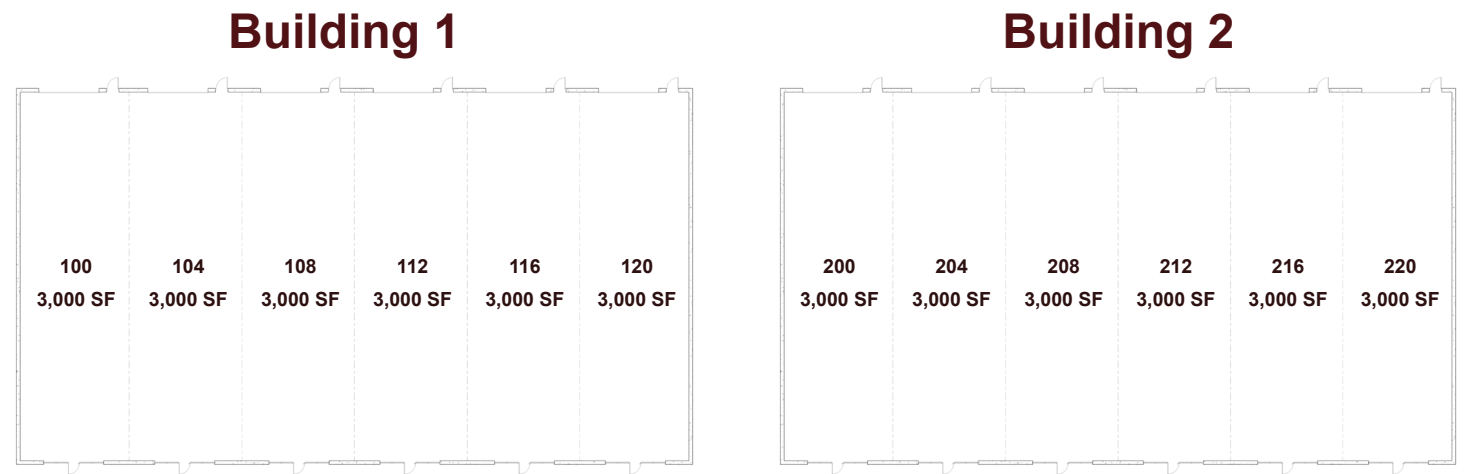

36,000 SF AVAILABLE FOR LEASE

100	3,000 SF	\$12 PSF	200	3,000 SF	\$12 PSF
104	3,000 SF	\$12 PSF	204	3,000 SF	\$12 PSF
108	3,000 SF	\$12 PSF	208	3,000 SF	\$12 PSF
112	3,000 SF	\$12 PSF	212	3,000 SF	\$12 PSF
116	3,000 SF	\$12 PSF	216	3,000 SF	\$12 PSF
120	3,000 SF	\$12 PSF	220	3,000 SF	\$12 PSF

Fit-Up Allowance:
\$20

Office Building

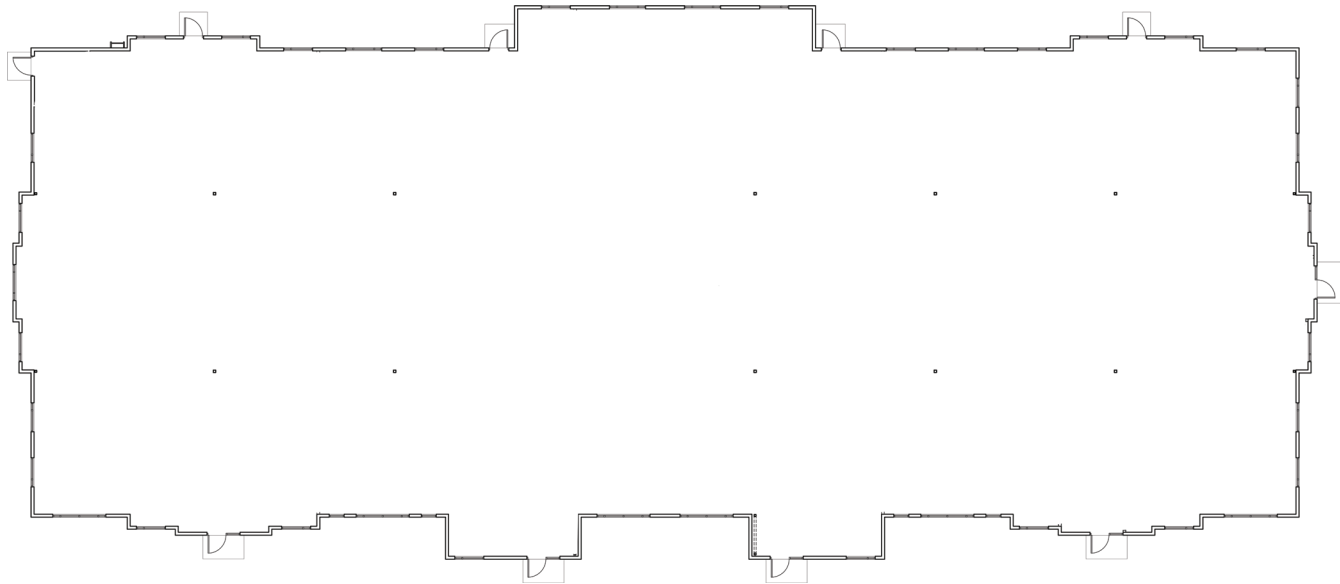

Retail Space For Lease:
17,544 SF (divisible)

Lease Rate:
\$15 PSF

Fit-Up Allowance:
\$30

All information contained herein is believed to be true, but should be verified to the buyer's satisfaction in case of error, typographical or otherwise. All information is subject to change without further notice.

PARKWAY COMMONS

Bullhead Pkwy, Bullhead City, AZ 86429



Retail Center

100	104	108	112	116	120	124	128	132
2,300 SF	2,173 SF	2,320 SF	2,124 SF	2,221 SF	2,320 SF	2,124 SF	2,320 SF	2,202 SF

20,104 SF AVAILABLE FOR LEASE

100	2,300 SF	\$26 PSF
104	2,173 SF	\$22 PSF
108	2,320 SF	\$22 PSF
112	2,124 SF	\$22 PSF
116	2,221 SF	\$22 PSF

120	2,320 SF	\$22 PSF
124	2,124 SF	\$22 PSF
128	2,320 SF	\$22 PSF
132	2,202 SF	\$22 PSF

Fit-Up Allowance:
\$40



Proposed Grocery Store Site

SITE AVAILABLE FOR SALE OR LEASE
LAND SALE PRICE: \$6 PSF

- Excellent site for grocer and accompanying retail amenities
- Site has great frontage along Bullhead Parkway and is in the heart of new residential growth
- Located a short distance from Laughlin, NV
- Owner/Developer willing to sell or build-to-suit

All information contained herein is believed to be true, but should be verified to the buyer’s satisfaction in case of error, typographical or otherwise. All information is subject to change without further notice.



Matt Olson
CCIM, SIOR, REALTOR®
 701.499.3921
 matt@prgcommercial.com
 ARIZONA: BR635876000



PROPERTY RESOURCES GROUP

WWW.PROPERTYRESOURCESGROUP.COM