



For lease

Industrial/flex office

120 N Redwood Road

North Salt Lake, UT 84054



Culum Mills

culum.mills@jll.com

+1 801 456 9526

Bronson Rawlins

bronson.rawlins@jll.com

+1 801 456 9513

Floorplans

Redwood Road

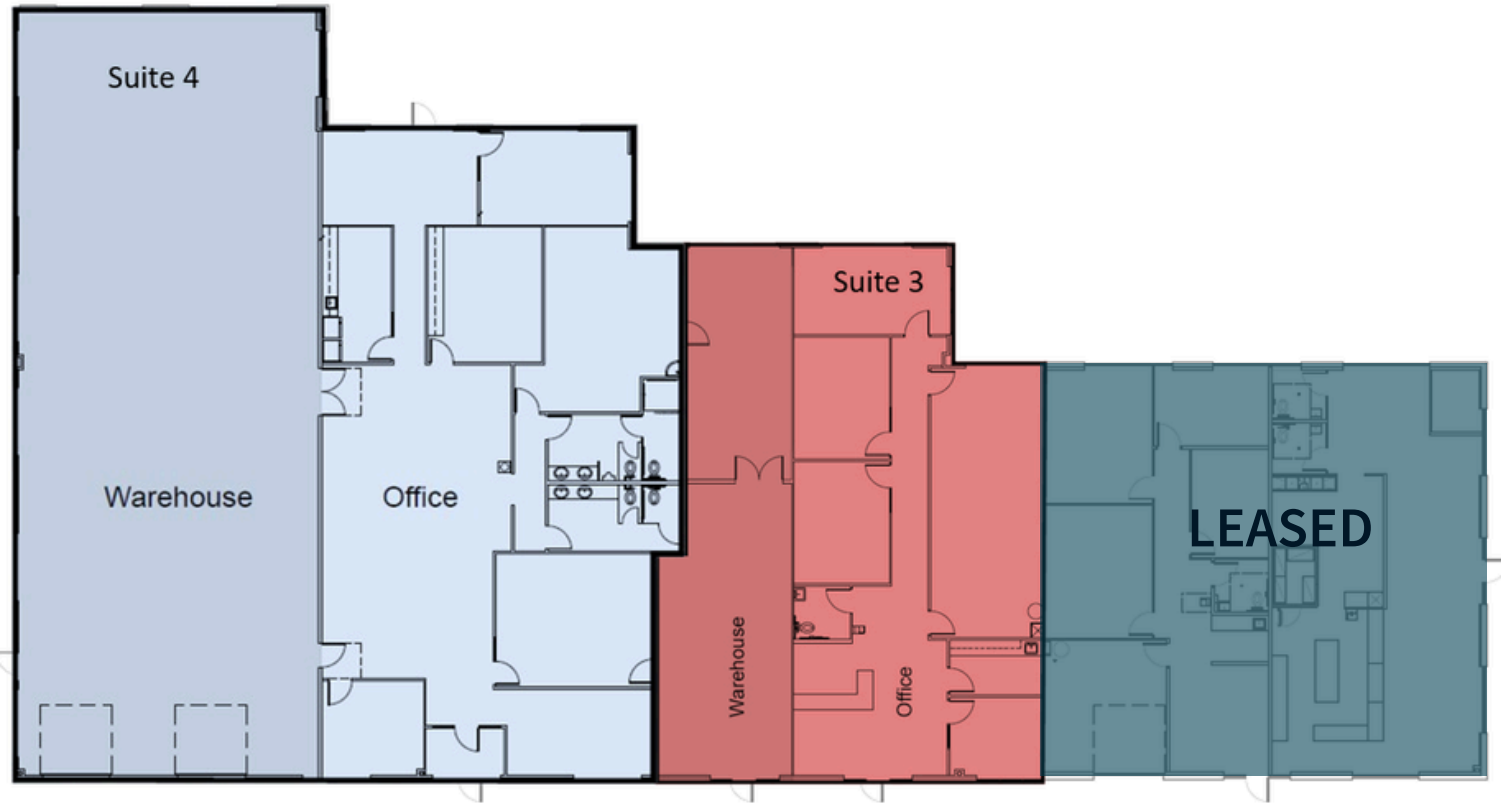

Suite 4 Specs

Total SF	7,693 SF
Office	3,730 SF
Warehouse	3,963 SF
Loading	Two (2) 8'x10' drive in doors
Asking rate	\$1.25/sf/mo/NNN

Suite 3 Specs

Total SF	3,087 SF
Office	2,000 SF
Warehouse	1,087 SF
Loading	Two (2) 8'x10' drive in doors
Asking rate	\$1.35/sf/mo/NNN

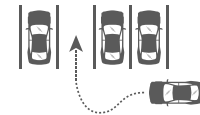

Property Details

- 13,794 SF Multi-tenant flex building on 1.44 acres
- 12' clear height
- 8'w x 10'h grade doors
- Wet fire suppression
- 3 phase power, 208/120v (tenant to verify)
- Desirable window lines
- Kitchenettes
- One-acre improved car parking
- Redwood Road frontage
- I-215 access to freeway system less than 1 mile away
- Flexible layout options



13 minutes to SLC
International Airport



12 minutes to Downtown Salt
Lake City



Direct access to I-15 and I-215



Culum Mills

culum.mills@jll.com

+1 801 456 9526

Bronson Rawlins

bronson.rawlins@jll.com

+1 801 456 9513