

For Lease



For Lease

PROPERTY FEATURES

+/-2 ACRES OF LOT
 Utilities in place and fully finished out
 Parking available,
 High traffic count along Boulevard Road 38,312
 200" Frontage along Bulverde Road
 Surrounding neighborhood
 Summit at Bulverde Creek, Emerald Forest,
 Encino, Northwood Hills

+/-14,600 Sqft

For Medical usage

Doctors office

Location:
 19730 Bulverde Rd, San
 Antonio, TX 78259

	2022	2027
Total Population	32,175	33,654
Total Households	28,044	29,256
Average Household Income	\$127,020	\$147,627

For Lease

- Base Price: \$ 32.50 per SF
- NNN \$8 per sf
- Lease Term: 5 years

CONTACTS



Naomi Freeman



info@srclandbuilding.com

naomirealestate11@gmail.com



Photos & Floor plan

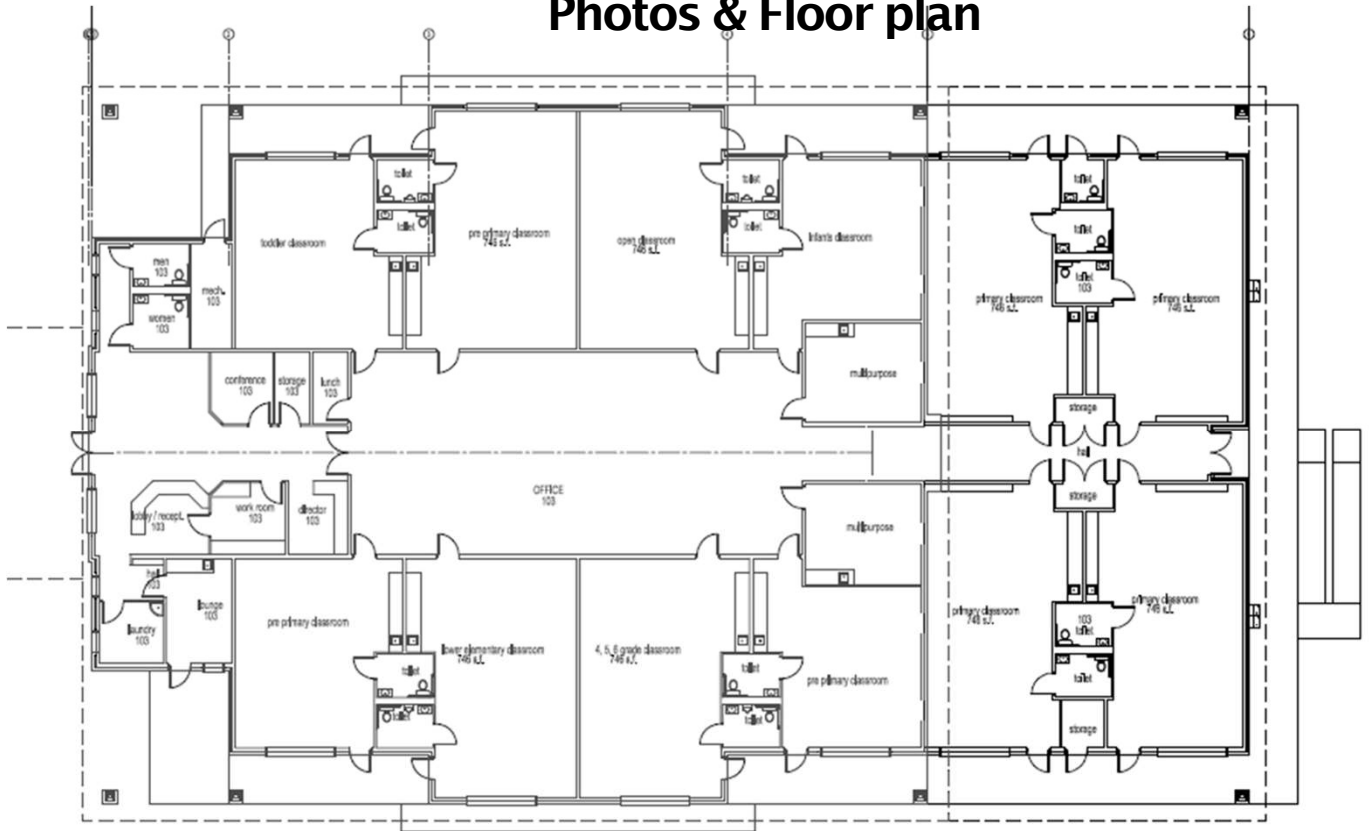

Demographics:

Population Change Since 2010

This chart shows the percentage change in area's population from 2010 to 2022, compared with other geographies.

Data Source: U.S. Census American Community Survey via Esri, 2022

Update Frequency: Annually



Population by Age

This chart breaks down the population of an area by age group.

Data Source: U.S. Census American Community Survey via Esri, 2022

Update Frequency: Annually

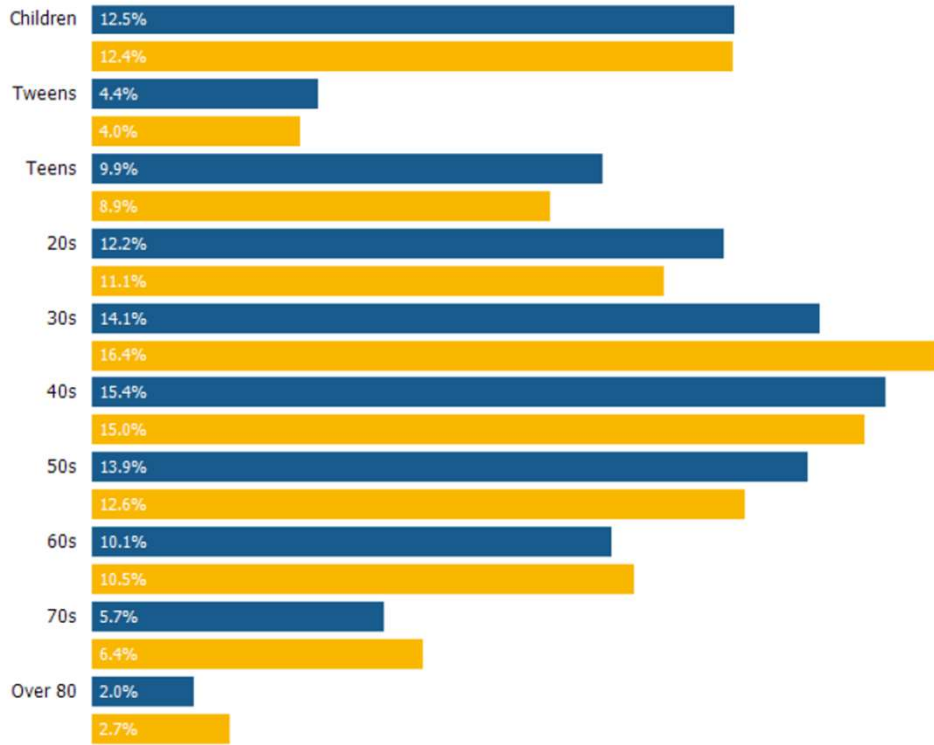

Unemployment Rate

This chart shows the unemployment trend in an area, compared with other geographies.

Data Source: Bureau of Labor Statistics via PolicyMap

Update Frequency: Monthly

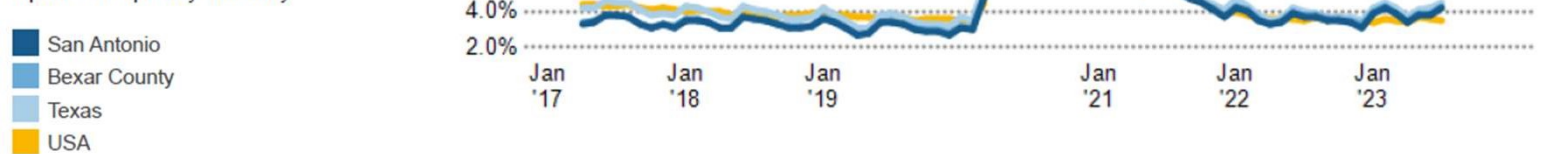

CONTACTS



Naomi Freeman



info@srclandbuilding.com

naomirealestate11@gmail.com