

For Sale

**CBRE**

# 1326 S. Avers Chicago, IL

Former Henson School

## Property Information

- Building SF: +/- 64,300 SF
- Land SF: +/- 84,723 SF
- PINS: 16-23-109-001; 16-23-109-032;  
16-23-109-042; 16-23-109-043; 16-23-109-013
- Zoning: RT-4
- Neighborhood: Lawndale
- Ward 24 / Alderman Monique Scott
- Price: \$22,500

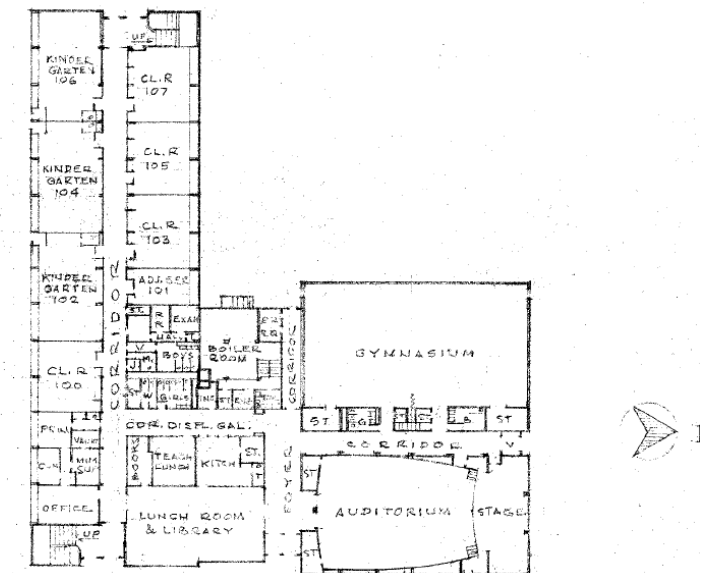
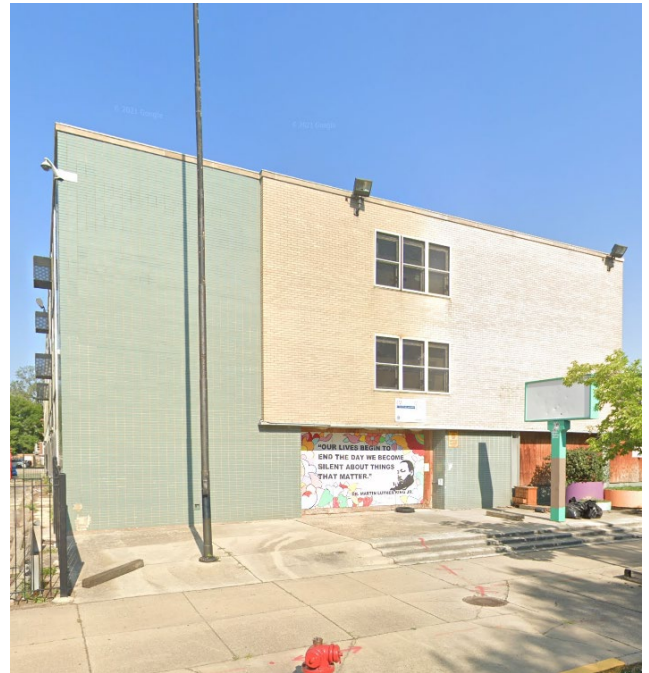

## Contact Us

Mike Nardini  
312 935 1030  
[Mike.Nardini@cbre.com](mailto:Mike.Nardini@cbre.com)

Nicole Mentone  
312 297 7658  
[Nicole.mentone@cbre.com](mailto:Nicole.mentone@cbre.com)

Mitch Adams  
312 935 1469  
[Mitch.adams@cbre.com](mailto:Mitch.adams@cbre.com)

Sarah Ware  
312 376 1448 ext. 101  
[sarah@warerealtygroup.com](mailto:sarah@warerealtygroup.com)

For Sale

**CBRE**

# 1326 S. Avers Chicago, IL

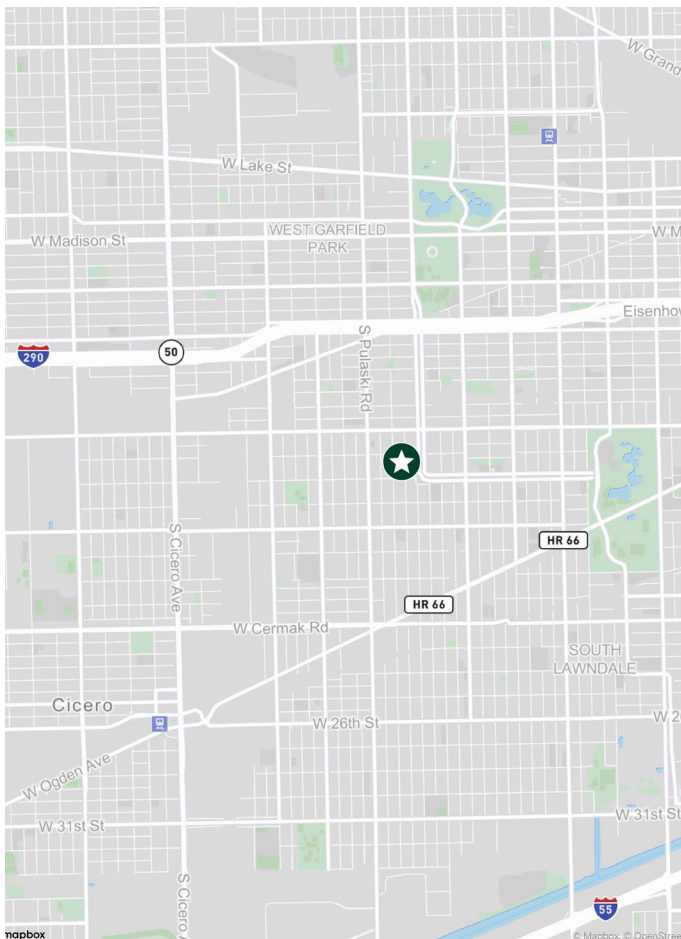

## Contact Us

**Mike Nardini**  
312 935 1030  
[Mike.Nardini@cbre.com](mailto:Mike.Nardini@cbre.com)

**Nicole Mentone**  
312 297 7658  
[Nicole.mentone@cbre.com](mailto:Nicole.mentone@cbre.com)

**Mitch Adams**  
312 935 1469  
[Mitch.adams@cbre.com](mailto:Mitch.adams@cbre.com)

**Sarah Ware**  
312 376 1448 ext. 101  
[sarah@warerealtygroup.com](mailto:sarah@warerealtygroup.com)

© 2025 CBRE, Inc. All rights reserved. This information has been obtained from sources believed reliable but has not been verified for accuracy or completeness. CBRE, Inc. makes no guarantee, representation or warranty and accepts no responsibility or liability as to the accuracy, completeness, or reliability of the information contained herein. You should conduct a careful, independent investigation of the property and verify all information. Any reliance on this information is solely at your own risk. CBRE and the CBRE logo are service marks of CBRE, Inc. All other marks displayed on this document are the property of their respective owners, and the use of such marks does not imply any affiliation with or endorsement of CBRE. Photos herein are the property of their respective owners. Use of these images without the express written consent of the owner is prohibited.