

DOMINGUEZ HILLS INDUSTRIAL PARK

450 W APRA STREET

Compton, CA

FOR LEASE

99,174 SF AVAILABLE

NEWMARK



PGIM

W APRA STREET

W VICTORIA STREET

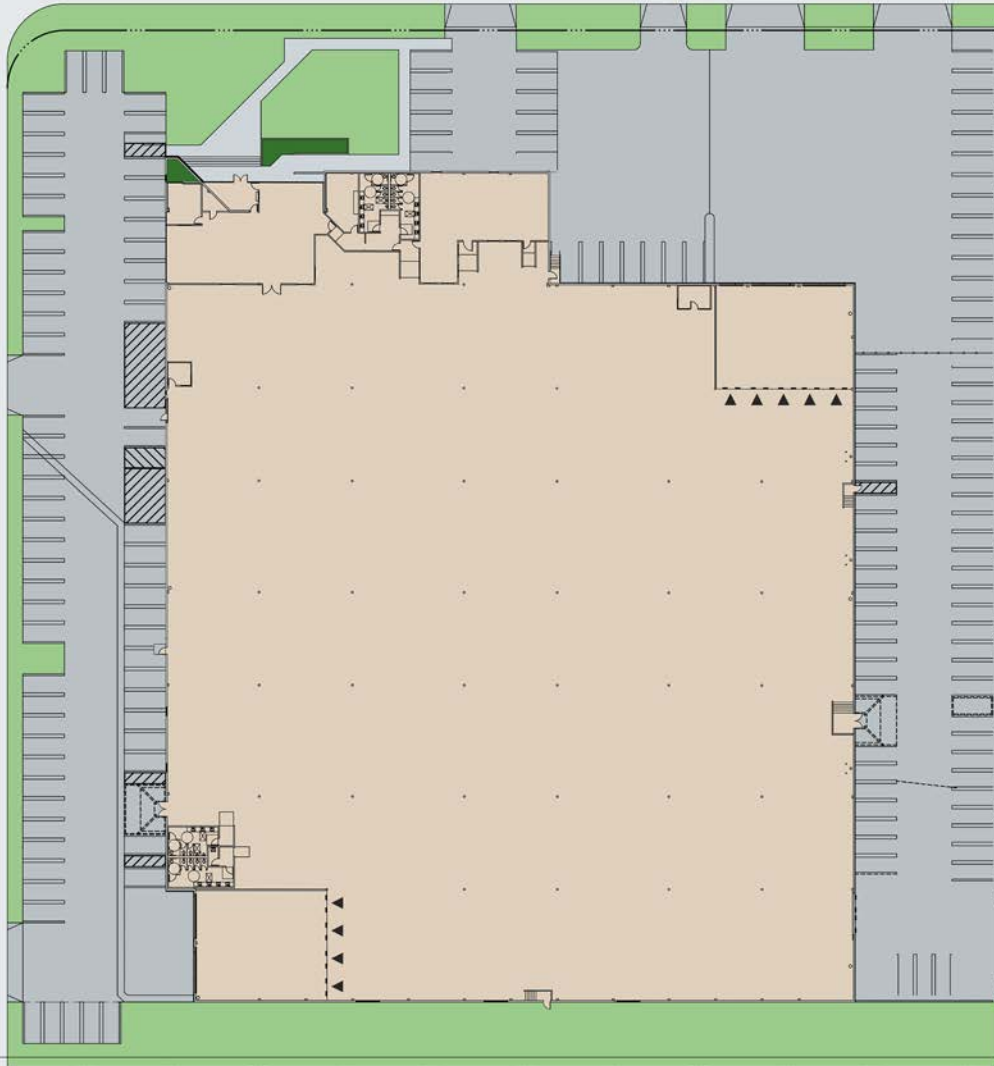

▲ Dock High Positions

BUILDING HIGHLIGHTS

99,174
SQUARE FEET

.45/3000
SPRINKLER SYSTEM

9
DOCK HIGH POSITIONS

5,100 SF
OFFICE

1
GROUND LEVEL DOOR

1,600
AMPS OF POWER

24'
CLEAR HEIGHT

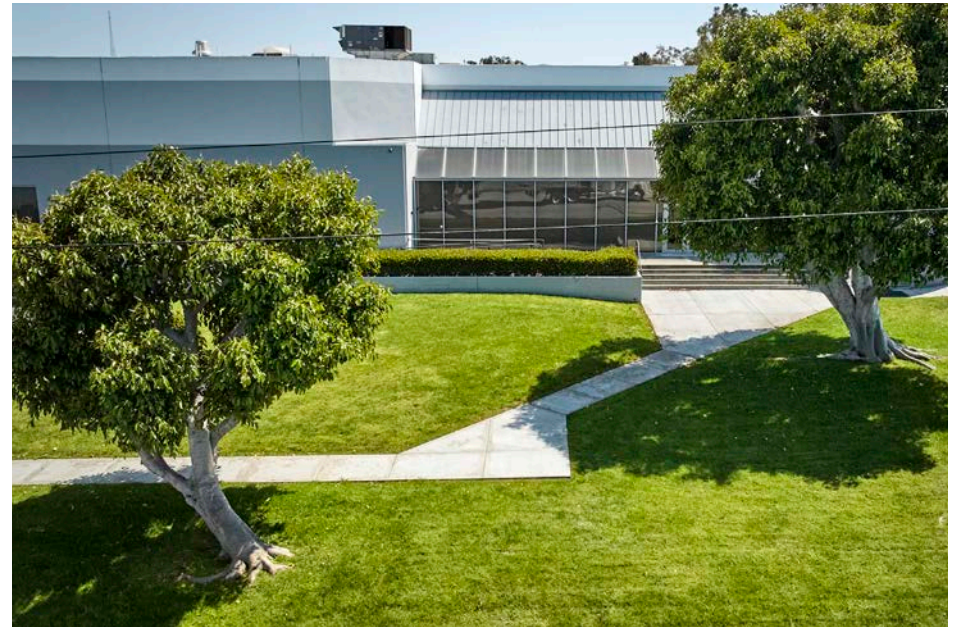

LOCATOR MAP



For more information, please contact:

DANNY WILLIAMS, SIOR

Executive Managing Director

t 310-491-2061

danny.williams@nmrk.com

CA RE Lic. #01776416

JOHN MCMILLAN, SIOR

Vice Chairman

t 310-491-2048

john.mcmillan@nmrk.com

CA RE Lic. #01103292

BARRY HILL, SIOR

Executive Managing Director

t 310-491-2026

barry.hill@nmrk.com

CA RE Lic. #01250531

450 W APRA STREET

Compton, CA



The distributor of this communication is performing acts for which a real estate license is required. The information contained herein has been obtained from sources deemed reliable but has not been verified and no guarantee, warranty or representation, either express or implied, is made with respect to such information. Terms of sale or lease and availability are subject to change or withdrawal without notice.

NEWMARK



Corporate License #01355491

nmrk.com